



# FORD & PARTNERS

ESTATE AGENTS



## 237 Chairborough Road, High Wycombe, HP12 3UL

ONLY A FEW REMAINING - INCENTIVES AVAILABLE!

A recently renovated collection of just 18 two double bedroom apartments situated in a purpose-built apartment building on the north-west side of High Wycombe's Town Centre.

The accommodation consists of two double bedrooms, a bright and airy reception room, a stylish kitchen with appliances, modern family bathroom and ample storage.

Show Home Available to View Now - call now to avoid early disappointment.

RESERVE YOUR NEW HOME NOW! NB: The photos are of the Show Apartment.

- Recently Refurbished First Floor Apartment
- Modern Family Bathroom
- Two Double Bedrooms
- Stunning Views
- Nearby Nature Reserve
- Residents Parking
- Available from Early May 2025
- Modern Electric Heating
- Separate Kitchens
- Ample Storage

**£1,350 Per month**

Chairborough Road, HP12 3UL

Approximate Gross Internal Area = 651 sq ft / 60.5 sq m



CH  
2.13 = Ceiling Height

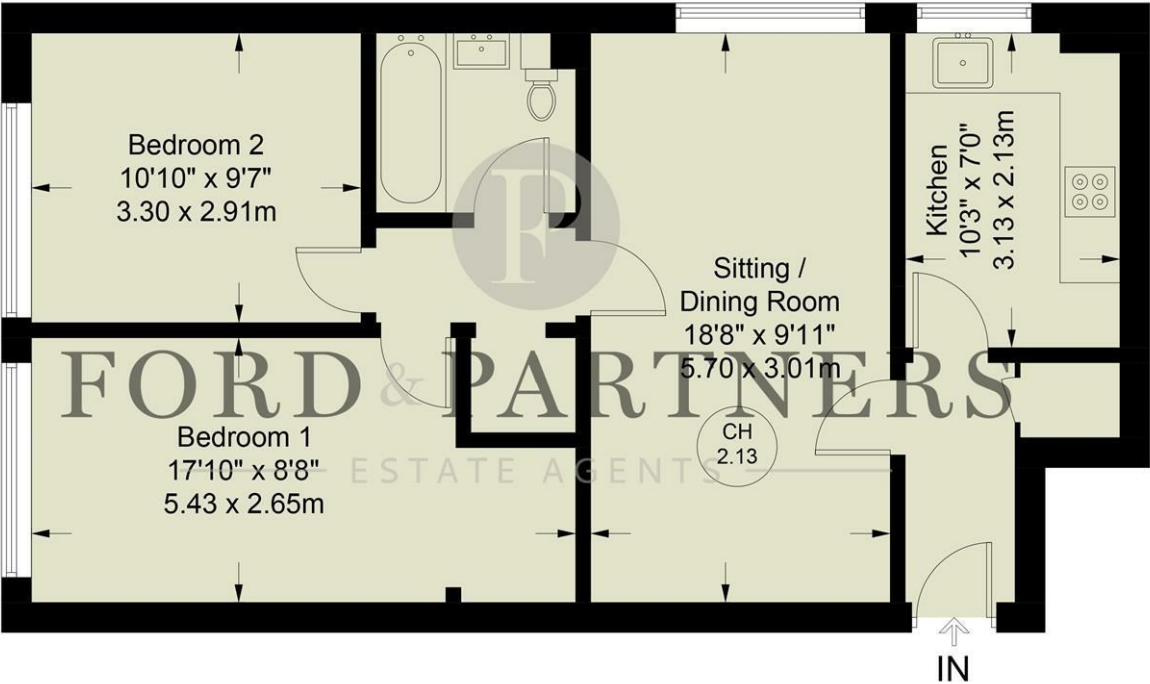

Floor Plan produced for Ford & Partners by Media Arcade ©.  
Illustration for identification purposes only. Window and door openings are approximate. Whilst every attempt is made to assure accuracy in the preparation of this plan, please check all dimensions, shapes and compass bearings before making any decisions reliant upon them.

Energy Efficiency Rating		
	Current	Potential
Very energy efficient - lower running costs		
(92 plus) A		
(81-91) B		
(69-80) C		
(55-68) D		
(39-54) E		
(21-38) F		
(1-20) G		
Not energy efficient - higher running costs		
England & Wales	EU Directive 2002/91/EC	

Environmental Impact (CO <sub>2</sub> ) Rating		
	Current	Potential
Very environmentally friendly - lower CO <sub>2</sub> emissions		
(92 plus) A		
(81-91) B		
(69-80) C		
(55-68) D		
(39-54) E		
(21-38) F		
(1-20) G		
Not environmentally friendly - higher CO <sub>2</sub> emissions		
England & Wales	EU Directive 2002/91/EC	

