

## Poppy Field, Frome Mill Farm, Nibley lane, Nibley, South

Auction Guide Price +++ £50,000



BRISTOL AND THE WEST COUNTRY'S BIGGEST LIVE PROPERTY EVENT hollismorgan

how to **buy at online auction** - what you need to do...

- 1 choose a lot
- 2 book a viewing
- 3 download the legal pack
- 4 register to bid
- 5 auction day...  
...watch the LIVE auction

For more details visit the buying at auction page on our website  
www.hollismorgan.co.uk/auctions/buying-by-auction

hollis morgan bid from anywhere online or mobile

- FOR SALE BY ONLINE AUCTION
- WEDNESDAY 22ND JULY 2026
- VIDEO TOUR NOW ONLINE
- VIEWINGS – REFER TO DETAILS
- DOWNLOAD FREE LEGAL PACK
- JULY LIVE ONLINE AUCTION
- FREEHOLD EQUESTRIAN PADDOCK
- SCOPE FOR WIDE RANGE OF USES STP
- 1.5 ACRE PARCEL | VEHICULAR ACCESS
- EXTENDED 8 WEEK COMPLETION

Hollis Morgan – JULY LIVE ONLINE AUCTION – A Freehold 1.5 ACRE PARCEL OF EQUESTRIAN LAND with vacant possession and vehicular access.

# Poppy Field, Frome Mill Farm, Nibley lane, Nibley, South Gloucestershire, BS37 5JG

## Accommodation

### FOR SALE BY LIVE ONLINE AUCTION

ADDRESS | Poppy Field, Frome Mill Farm, Nibley Lane, Nibley, South Gloucestershire BS37 5JG

Lot Number TBC

The Live Online Auction is on Wednesday 22nd July 2026 @ 12:00 Noon  
Registration Deadline is on Friday 17th July 2026 @ 16:00

The Auction will be streamed LIVE ONLINE via the Hollis Morgan website & you can choose to bid by telephone, proxy or via your computer. Registration is a simple online process – please visit the Hollis Morgan auction website and click “REGISTER TO BID”

### THE LAND

Poppy Field is a Freehold 1.5 acre parcel of equestrian paddock with vehicular access from Nibley Lane and just 3 miles from the edge of Bristol. Separate metered Wessex water supply to a horse trough within the enclosure.

We are informed the land is well drained and there is no right of way from any adjoining paddocks.

Sold with vacant possession

Tenure - Freehold

### THE OPPORTUNITY

1.5 ACRES | EQUESTRIAN

The paddock has been used for equestrian purpose's for many years but would suit a wide range of uses in this convenient location close to the local villages.

Interested parties should note that similar nearby paddocks have permanent equestrian facilities.

All subject to gaining the necessary consents.

### IMPORTANT NOTICE

Interested parties should note the adjoining 1.5 acre paddock "Daisy Field" is also for sale in the same catalogue and they could be combined - there is in fact already an interconnecting gate.

### LOCATION

Nibley is a Village in the South Gloucester countryside. Its located 4.5 miles from the M4 motorway to London or into Wales. The nearby town of Yate has a train station with main line connections, a refurbished leisure centre, retail park including cinema and restaurants and a large shopping centre which caters for all needs. From Yate there is easy access to Chipping Sodbury with its historic High Street dating back to the 12th Century. Chipping Sodbury offers a wide and eclectic range of shops and established businesses and more recently a Waitrose store has been built in the centre of the town. There is a selection of both Primary and Secondary Schooling in the Yate area of good reputation plus Chipping Sodbury offers country walks on a lovely common which neighbours the golf course and cricket club.

## Floor plan

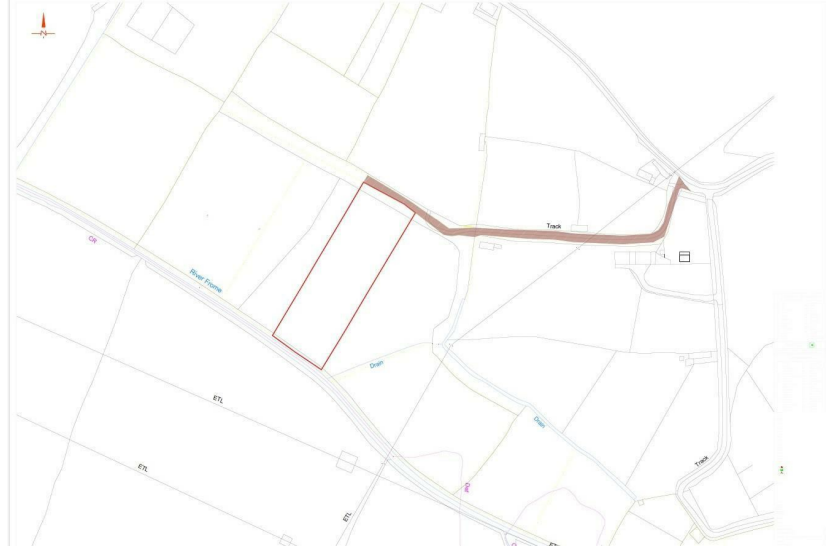

## EPC Chart

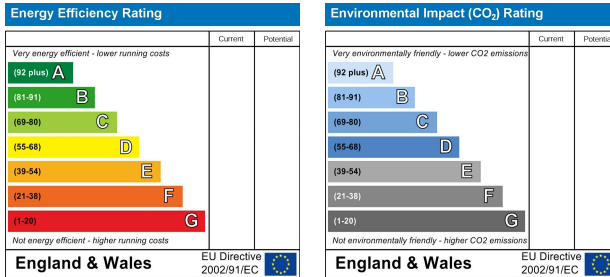

9 Waterloo Street  
Clifton  
Bristol  
BS8 4BT

Tel: 0117 973 6565  
Email: [post@hollismorgan.co.uk](mailto:post@hollismorgan.co.uk)  
[www.hollismorgan.co.uk](http://www.hollismorgan.co.uk)

Hollis Morgan Property Limited, registered in England, registered 7275716.  
Registered address, 5 Upper Belgrave Road, Clifton, Bristol BS8 2XQ

## Auction Property Details Disclaimer

Hollis Morgan endeavour to make our sales details clear, accurate and reliable in line with the Consumer Protection from Unfair Trading Regulations 2008 but they should not be relied on as statements or representations of fact.

Please refer to our website for further details.