



## Salamanca Place, SE1

£350,000

An incredible one bedroom flat with views over the courtyard, the property benefits from a sociable open plan kitchen and reception room. There is good storage throughout the flat, lift access and access to communal roof terrace benefitting from incredible views of the City.

Peacefully located just moments from the River Thames and with convenient access to a vibrant selection of bars, restaurants, and cultural attractions in nearby Waterloo and along the South Bank. The West End is also just a short journey across the river. Excellent transport links include Vauxhall Station, offering both Victoria Line and National Rail services, as well as numerous frequent bus routes.

### Features

- Open plan
- One Bedroom
- No Onward Chain
- Excellent Condition
- Communal Roof Terrace

# Salamanca Place, London, SE1

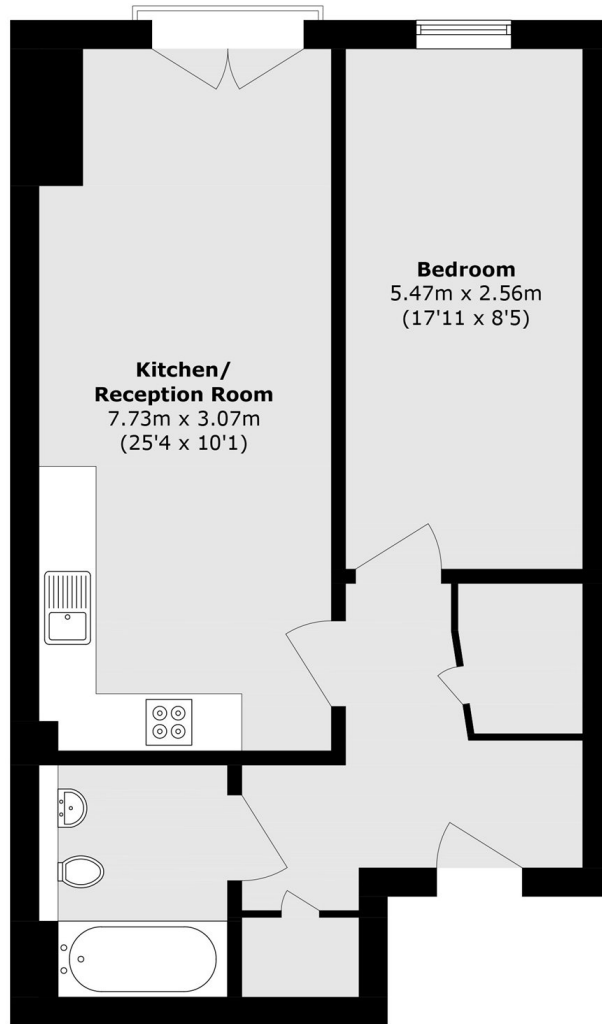

## Third Floor

Total area (approx.): 53.7 sq. m (578.0 sq. ft)