



ASKING PRICE

£1,100,000

York street

Twickenham, TW1 3JZ

PROPERTY SUMMARY

Freehold commercial building positioned in a highly desirable location! The property comprises of a ground floor commercial unit and two separate flats over the first and second floor. 11a a large 3 bed flat & 11b a 1 bedroom flat - all units are currently let and are surrounded by a strong mix of national and independent retailers. Well-known neighbours include Pizza Express, Starbucks, GDK, Foxtons, Snappy Snaps, and Caffé Nero, alongside a variety of premium local boutiques and independents.

The property is currently full let generating an rental income of £72,000 Per Annum

Situated in the heart of Twickenham, an affluent and lively suburb in southwest Greater London, the area offers a vibrant blend of shops, cafés, pubs, and delicatessens. Twickenham is home to the world-famous Twickenham Stadium, which attracts significant visitor numbers throughout the year.

The property is well connected, with King Street only a 7-minute walk from Twickenham Station. From there, fast services reach London Waterloo in under 25 minutes.

null 

null 

null 







Approximate Gross Internal Area
250.69 sq m / 2698 sq ft

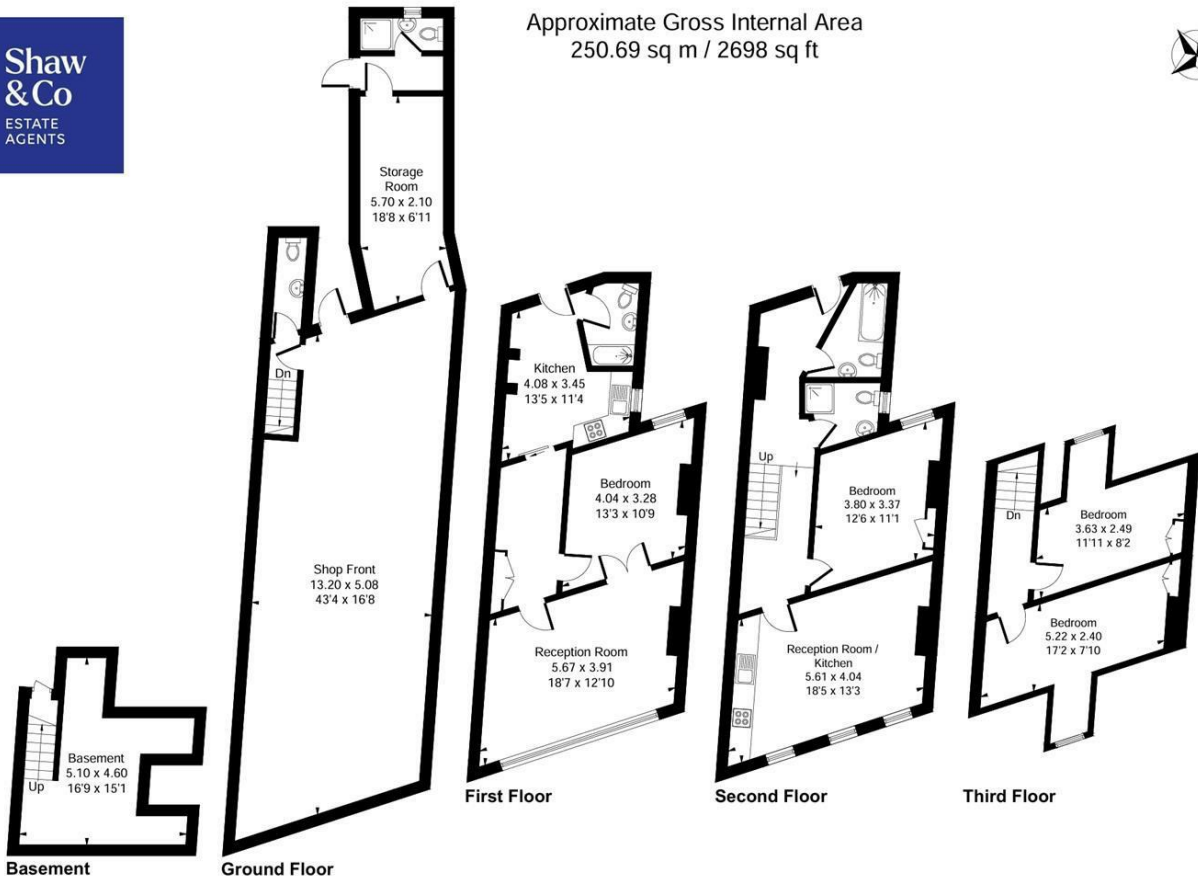

LOCAL AUTHORITY

Richmond

TENURE

Freehold

COUNCIL TAX BAND

B

VIEWINGS

By prior appointment only

Energy Efficiency Rating		Current	Potential
Very energy efficient - lower running costs			
(92 plus) A			
(81-91) B			
(69-80) C			
(55-68) D			
(39-54) E			
(21-38) F			
(1-20) G			
Not energy efficient - higher running costs			
England & Wales		EU Directive 2002/91/EC	



Agents Note: Whilst every care has been taken to prepare these particulars, they are for guidance purposes only. All measurements are approximate and are for general guidance purposes only and whilst every care has been taken to ensure their accuracy, they should not be relied upon and potential buyers/tenants are advised to recheck the measurements

	<p>OFFICE ADDRESS 10 Central Parade New Heston Road Heston Middlesex TW5 0LJ</p>	<p>OFFICE DETAILS 02085707258 land@shawandcoestates.com https://www.shawandcoestates.com</p>
--	---	--