



Flat 19, 1 Harewood Street, Leeds, LS2 7AD

£195,000

SW
RESIDENTIAL

- Beautifully Presented One Bedroom Apartment
- Open Plan Living Area and Kitchen
- Light and Airy Apartment
- No Onward Chain
- Excellent Location
- Good Size Double Bedroom
- Grade II Listed Building
- Council Tax Band D

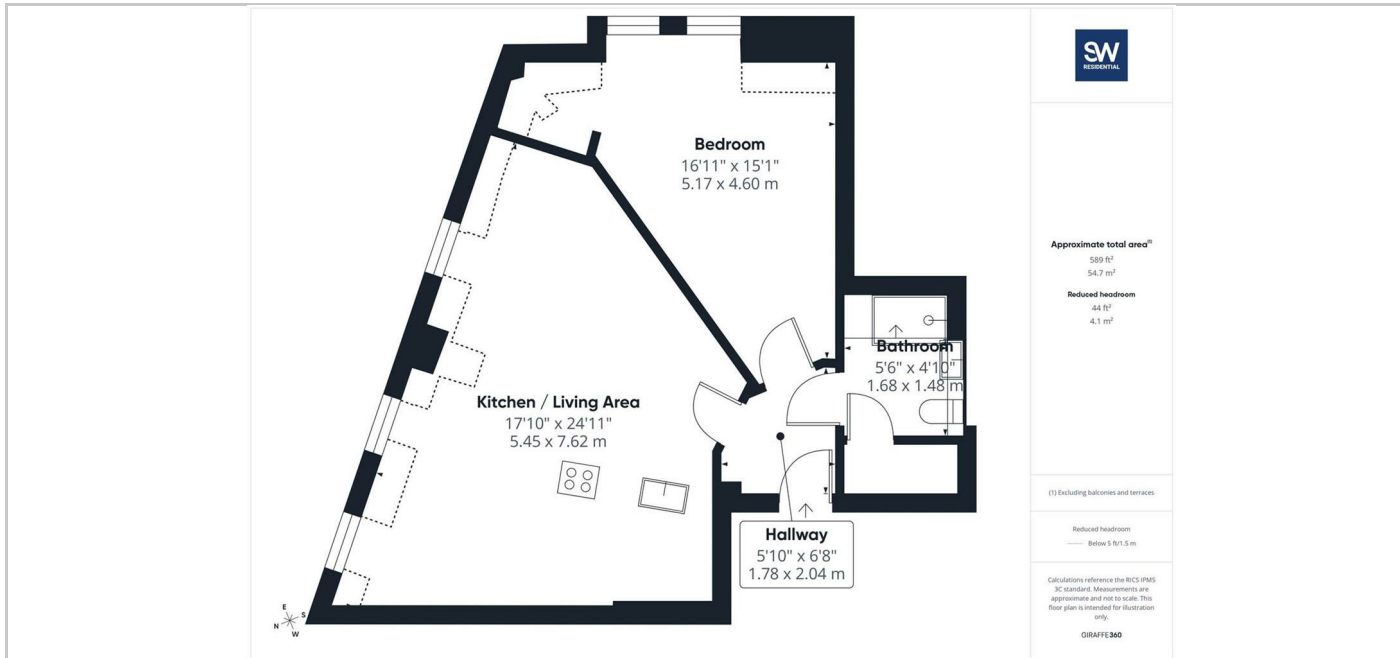

Directions

6th Floor Central Square, 29 Wellington Street, West Yorkshire, LS1 4DL
Tel: 0113 221 6000 Email: residential@sw.co.uk

THE PROPERTY

Great opportunity for a first time buyer or investor to purchase a beautifully presented spacious fourth floor apartment in the centrally located Number 1 Harewood Street development.

This unique one bedroom apartment has a great feeling of space and light making it ideal for those looking to make a home in the city centre.

The open plan living area and kitchen is unusually shaped but lends itself very well to entertaining.

The spacious bedroom has plenty of space for storage and a hidden wardrobe area providing ample space for hanging clothes.

Available for purchase with no onward chain.

This really is an opportunity not to be missed, contact us to arrange your viewing.

SITUATION