

Norfolk Terrace

, Brighton BN1 3AD

- Available NOW!!
- Spacious one bedroom
 - Ground floor flat
- Walking distance to transport links
 - High Ceilings
- Video link available
- Open plan kitchen and living room
- Fantastic Location
- Furniture Optional

£1,250 PCM

Local Authority Brighton &
Hove City Council
Council Tax Band A
EPC Rating E

GROUND FLOOR
259 sq.ft. (24.1 sq.m.) approx.

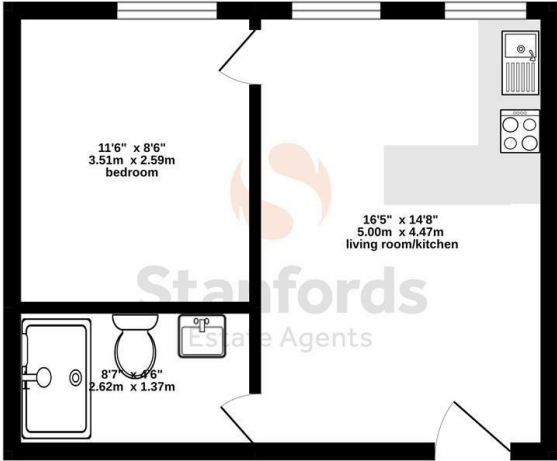

TOTAL FLOOR AREA: 259 sq.ft. (24.1 sq.m.) approx.
Whilst every attempt has been made to ensure the accuracy of the description contained here, measurements of doors, windows, rooms and any other items are approximate and no responsibility is taken for any error, omission or misstatement. This plan is for illustrative purposes only and should be used as such by any prospective purchaser. The services, systems and appliances shown have not been tested and no guarantee as to their capability or efficiency can be given.
Made with letbricks 12/2022



Moretons Lettings Office

30-31 North Street, Brighton,
East Sussex, BN1 1EB

Contact

Agents Note: Whilst every care has been taken to prepare these particulars, they are for guidance purposes only. All measurements are approximate and for general guidance purposes only and whilst every care has been taken to ensure accuracy, they should not be relied upon and potential buyers/tenants are advised to recheck the measurements.