



Fitzgerald Grove, Tattenhoe Park, Milton Keynes, MK4 4LH

Offers Over £450,000

🛏 4 🚗 3 🚗 3

- No upward chain
- Versatile living space
- Extended home
- Annexe/studio room
- En suite to the master bedroom
- Sought after area
- Close to outstanding and good schools



Being sold with no upward chain is this well extended three/ four bedroom, detached family home, in the newly built and sought after area of Tattenhoe Park, Milton Keynes. A further upgrade is the garage conversion to now be a separate studio/ bedroom with its own en suite shower room. The living space is approximately 1500 sq ft and comprises entrance hall with storage cupboard and WC/shower room, sitting room, kitchen/ dining room with utility area, spacious UPVC/brick built conservatory that is split into two separate reception spaces, master bedroom with fitted wardrobes and en suite, two further good size bedrooms and the shower room. Off road parking for two cars and rear garden.

For all enquiries please quote C0104



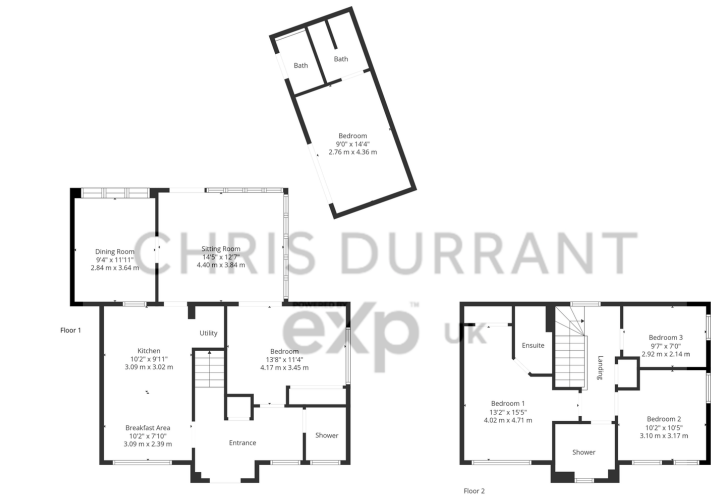

TOTAL: 1503 sq. ft. 139 m²
FLOOR 1: 994 sq. ft. 92 m², FLOOR 2: 509 sq. ft. 47 m²
EXCLUDED AREAS: UTILITY: 18 sq. ft. 2 m², "": 106 sq. ft. 10 m², WALLS: 143 sq. ft. 14 m²



Energy performance certificate (EPC)			
5 Fitzgerald Grove Tatnell Park MILTON KEYNES MK14 4LT	Energy rating B	Valid until:	21 October 2025
		Certificate number:	9340-2052-0000-2025-0061
Property type		Detached house	
Total floor area		94 square metres	

Rules on letting this property

Properties can be let if they have an energy rating from A to E.
You can read [guidance for landlords on the regulations and exemptions](#) (<https://www.gov.uk/guidance/domestic-private-rented-property-minimum-energy-efficiency-standards-landlord-guidance>).

Energy rating and score

This property's energy rating is B. It has the potential to be B.

[See how to improve this property's energy efficiency.](#)

The graph shows this property's current and potential energy rating.

Properties get a rating from A (best) to G (worst) and a score. The better the rating and score, the lower your energy bills are likely to be.

For properties in England and Wales:

the average energy rating is D
the average energy score is 60

