



## GIBSONS HILL, SW16

£875,000

- Three/Four double bedrooms
- Study room
- South East facing garden
- Driveway
- Two receptions
- Energy rating: D





## ABOUT THE HOME

A beautifully presented detached three double bedroom home with an additional study, set on a peaceful residential road between Norwood Grove and Norbury Park. The property offers generous family living and a stunning south-east facing garden.

One of the location's defining features is exceptional access to green space. Norwood Grove, The Rookery, Streatham Common and Norbury Park are all within easy walking distance, creating a tranquil setting. Streatham High Road, together with the cafés, restaurants and independent shops of Crystal Palace and West Norwood, are all within easy reach. Norbury and Streatham common train stations provide fast, direct links into Central London.





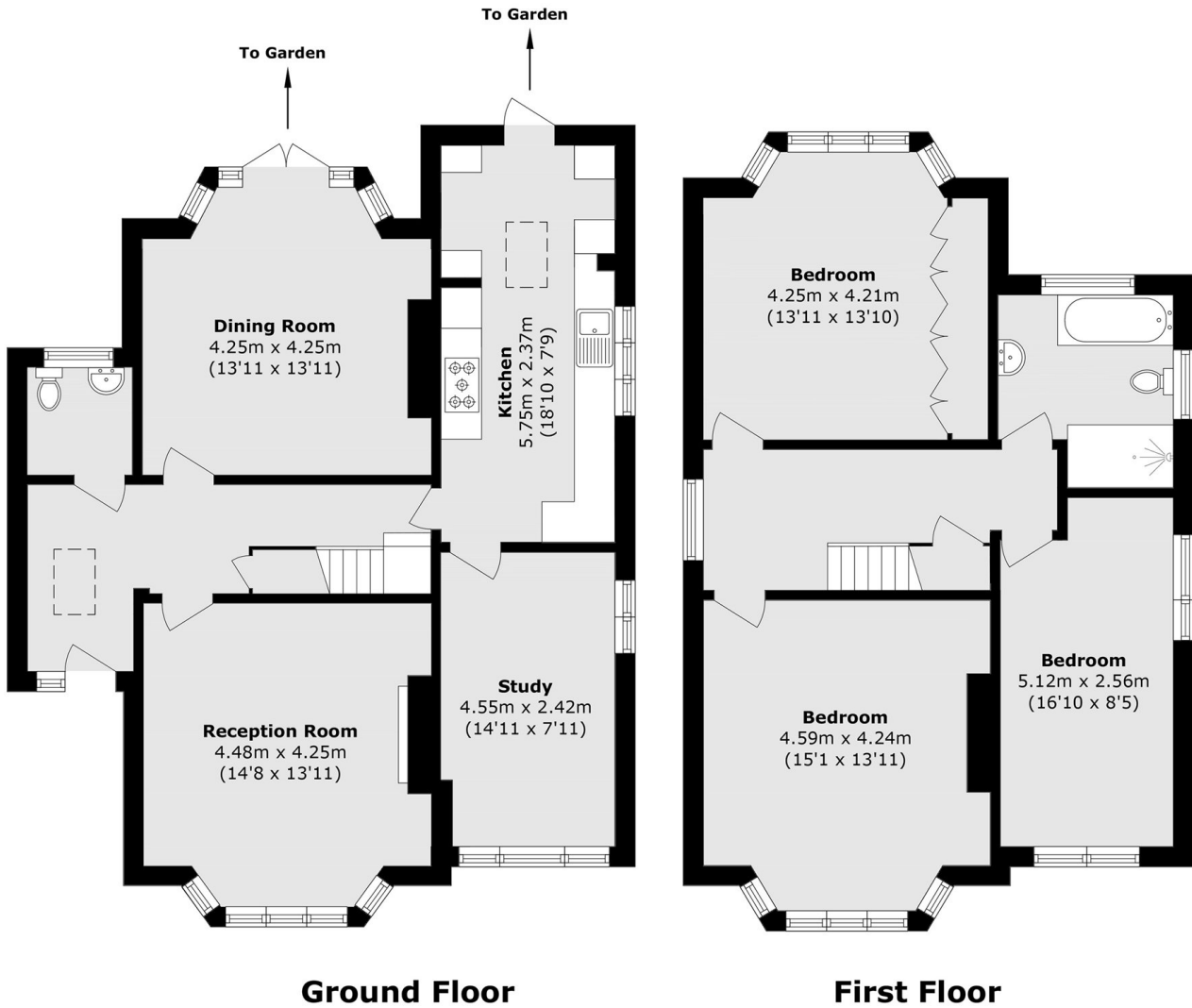

Total area (approx.): 145.6 sq. m (1567.2 sq. ft)

### JACKSONS STREATHAM

1-3 De Montfort Parade,  
 Streatham High Road,  
 Sales: 020 8487 3179  
 Lettings: 020 8487 3180

Energy Rating: D We aim to make our particulars both accurate and reliable. However they are not guaranteed; nor do they form part of an offer or contract. If you require clarification on any points then please contact us, especially if you're traveling some distance to view. Please note that appliances and heating systems have not been tested and therefore no warranties can be given as to their good working order.