



Cadet Drive, SE1

£260,000

A beautifully presented and recently redecorated ground floor flat, featuring a bright west-facing living room and kitchen, a spacious double bedroom, ample storage, and a modern three-piece bathroom. The property also benefits from secure parking. Offers in excess of £260,000.

Cadet Drive is a peaceful residential close, set just off Lynton Road and within easy reach of a variety of local amenities. Excellent transport options include Bermondsey Underground and South Bermondsey Station, both less than a mile away, along with convenient bus links across London.

Features

Offers in excess of £260,000
West Facing
Front Garden
Open Plan Living
Ample Built-In Storage
Secure Off-Street Parking
Chain Free Sale

Cadet Drive, London, SE1

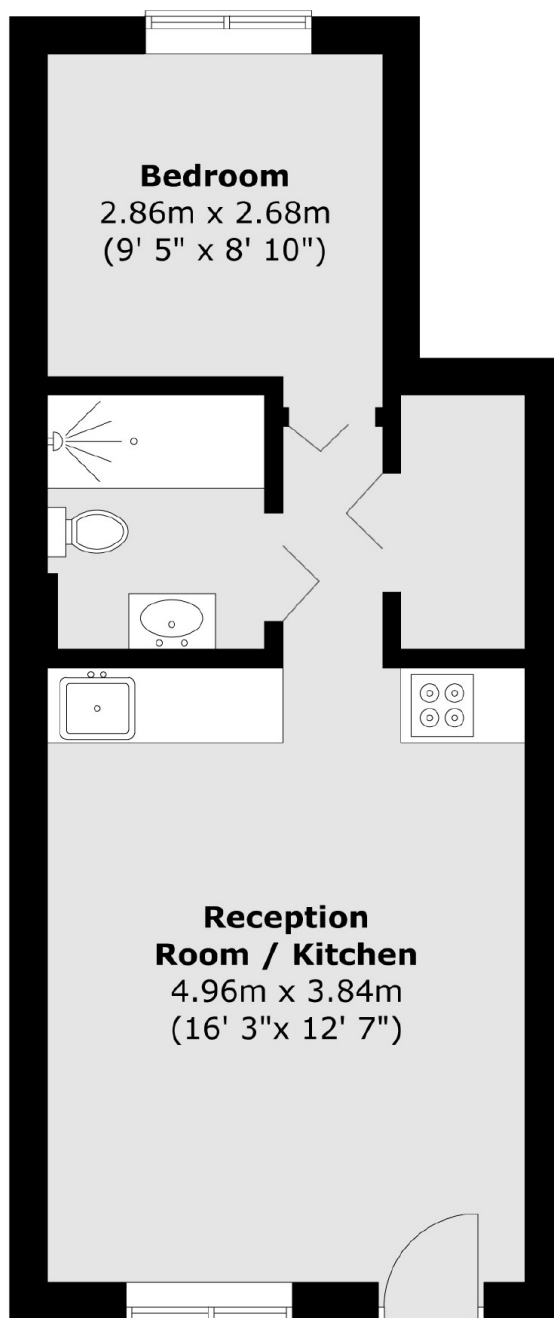

Total area (approx.) : 35.1 sq. m (378 sq. ft)