



Streatham Hill, SW2

£400,000

A bright two bedroom top floor flat set within a charming Art Deco building. The property benefits from beautifully maintained communal gardens with feature fountains and is positioned in the rear block, offering a peaceful setting. Offered to the market chain free.

Wavertree Court is a short walk from Streatham Hill railway station and offers excellent bus links to Brixton, Tulse Hill, and Balham. Tooting Common and Brockwell Park are nearby, with shops and restaurants right on your doorstep.

Features

- Two Bedrooms
- Good Condition
- Chain Free
- Modern Bathroom
- Communal Gardens
- Art Deco Block

Streatham Hill, London, SW2

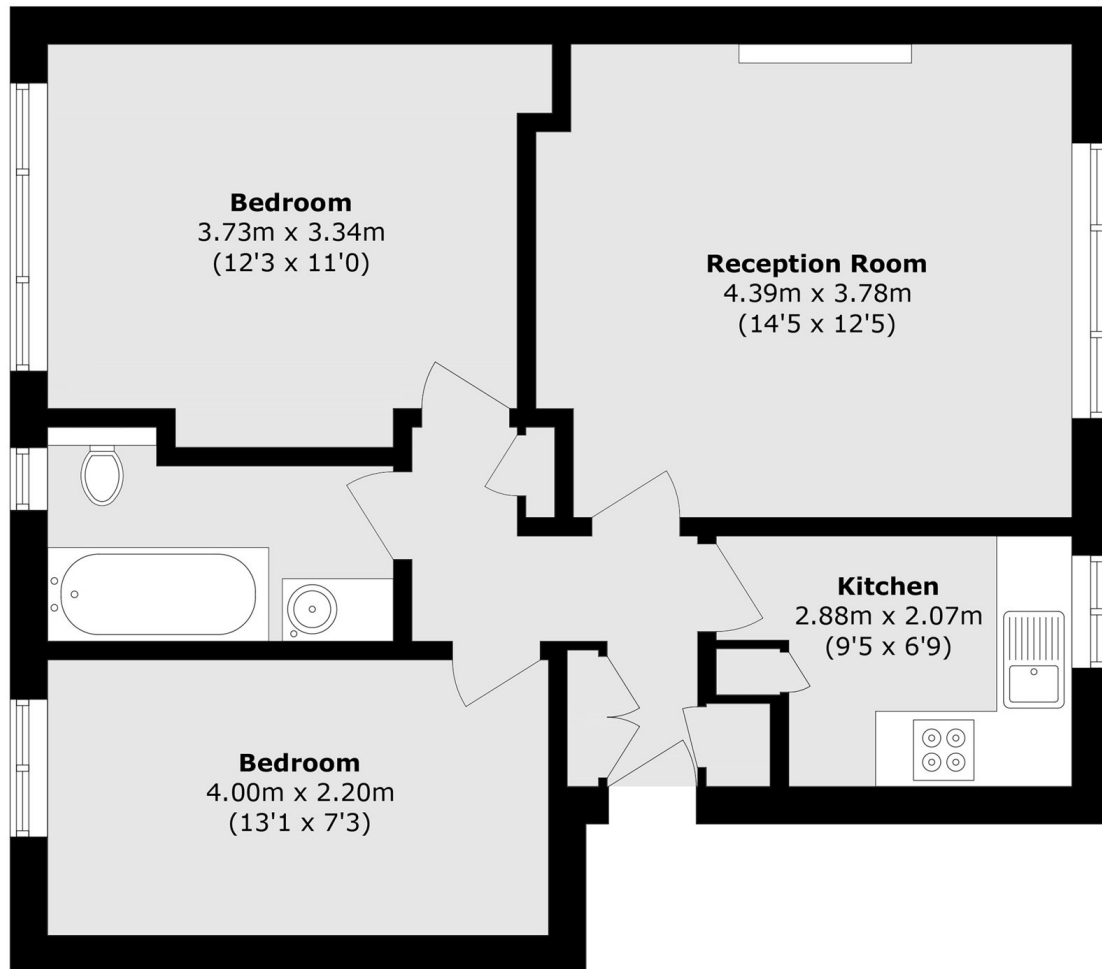

Total area (approx.): 53.2 sq. m (572.6 sq. ft)