



*jordan fishwick*

High Hill Road New Mills High Peak



## High Hill Road New Mills High Peak SK22 4HQ

£255,000



### The Property

Ideally positioned within a popular and established residential area in New Mills, a superbly presented, bay fronted, end of terrace property. Stylish decor and perfect for many buyers, this attractive TWO DOUBLE BEDROOM property has to be seen. Ample driveway parking and private, low maintenance gardens coupled with pvc double glazing and gas central heating. Also comprising: entrance hall, living room, 15ft dining kitchen and contemporary bathroom with separate shower. Close to the Sett Valley Trail.



- Superb 1930's Bay Fronted Property
- Convenient Position
- Very Well Presented
- Two Double Bedrooms
- Modern Bathroom With Separate Shower
- Ample Off Road Parking
- Enclosed Private Low Maintenance
- 15ft Dining Kitchen
- Pvc Double Glazing and Gas Central Heating

**Postcode** SK22 4HQ

**EPC Rating**

**Local Authority** High Peak

**Council Tax** B

Energy Efficiency Rating		Current	Potential
Very energy efficient - lower running costs			
(92 plus)	A		
(81-91)	B		
(69-80)	C		
(55-68)	D		
(39-54)	E		
(21-38)	F		
(1-20)	G		
Not energy efficient - higher running costs			
<b>England &amp; Wales</b>		EU Directive 2002/91/EC 	



GROUND FLOOR

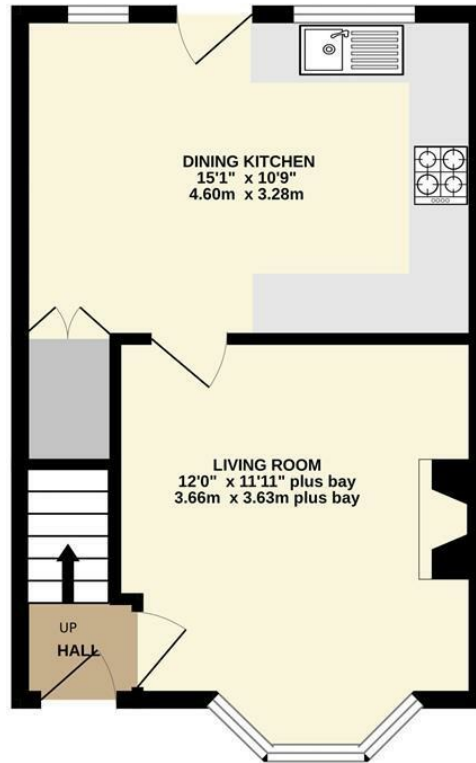

1ST FLOOR

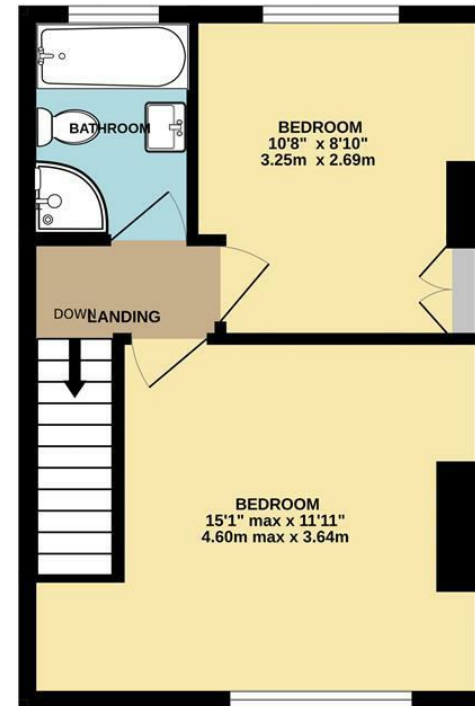

Whilst every attempt has been made to ensure the accuracy of the floorplan contained here, measurements of doors, windows, rooms and any other items are approximate and no responsibility is taken for any error, omission or mis-statement. This plan is for illustrative purposes only and should be used as such by any prospective purchaser. The services, systems and appliances shown have not been tested and no guarantee as to their operability or efficiency can be given.  
Made with Metropix ©2026



These particulars are believed to be accurate but they are not guaranteed and do not form a contract. Neither Jordan Fishwick nor the vendor or lessor accept any responsibility in respect of these particulars, which are not intended to be statements or representations of fact and any intending purchaser or lessee must satisfy himself by inspection or otherwise as to the correctness of each of the statements contained in these particulars. Any floorplans on this brochure are for illustrative purposes only and are not necessarily to scale.

Offices at: Chorlton, Didsbury, Disley, Hale, Glossop, Macclesfield, Manchester Deansgate, Manchester Whitworth Street, New Mills, Sale, Wilmslow and Withington

14 Market St, Disley, Cheshire, Stockport SK12 2AA

01663 767878

disley@jordanfishwick.co.uk

www.jordanfishwick.co.uk