



Slate Cottage, The Street, Bury, West Sussex RH20 1PF





Slate Cottage, The Street, Bury, West Sussex RH20 1PF

£2,150 Per Month



- 3 bedrooms, 2 bathrooms
- Detached period house
- Versatile accommodation
- Heart of Bury village
- Available now, unfurnished
- Oil fired boiler, 2 log burners
- 2 reception rooms

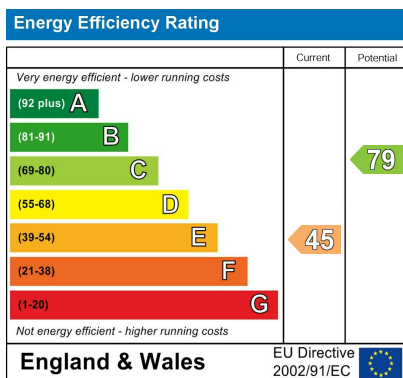

Kitchen / Living / Dining Room

The open-plan kitchen, living and dining area is generously spacious, featuring stone tile flooring and cream cabinetry with wooden worktops. A large window and a door opening to a patio area provide natural light and garden access. The kitchen includes an oven set against a vibrant blue tiled splashback, under counter fridge and dishwasher. Adjacent to this is a family room that look out onto the garden, creating a bright and welcoming atmosphere.

Family Room

The family room offers a cosy setting with wooden flooring, exposed ceiling beams, and a modern wood-burning stove. French doors open out to the garden, allowing for plenty of natural light and a seamless transition to outdoor living.

Bedroom

The smallest bedroom features carpeted floors, a window overlooking the outside, and built-in wardrobes for storage. It is pleasantly sized and enjoys natural light, and en suite bathroom.

Bedroom

The smallest bedroom is bright and spacious with carpeted flooring and a large window providing garden views. It includes built-in wardrobes offering ample storage space.

Bedroom / Day Room

A versatile room with wooden floorboards and a bold red accent wall, this space enjoys access to the garden through french doors. It could be used as a bedroom or a day room, offering flexibility for use.



To arrange a viewing call us on 01903 744166 or email lettings@glproperty.co.uk

View online at www.glproperty.co.uk



Rear Garden

The rear garden is arranged over different levels with a paved patio area leading to a tier of steps up to a raised terrace and further planting areas. Enclosed by fencing and hedging, it offers privacy and a delightful outdoor space to relax or entertain.

Courtyard

A small paved courtyard area with a wooden garden shed and brick walling, providing useful storage and a private outdoor space.

PROPERTY MISDESCRIPTIONS ACT 1991 For clarification, GL & Co. Agents wish to inform prospective purchasers, that we have not carried out a detailed survey, nor have we tested any of the appliances or heating system and cannot give any warranties as to their full working order. Purchasers are advised to obtain independent specialist reports if they have any doubts. All measurements are approximate and should not be relied upon for carpets or furnishings.

NOTES 1. All measurements shown in these particulars are approximate. 2. Whilst we endeavour to make our sales details accurate and reliable, if there is any point which is of particular importance to you, please contact the office and we will be pleased to check information. Do so, particularly if you are contemplating travelling some distance to view the property. 3. The mention of any appliance and/or services in these particulars does not imply that they are in full and efficient working order. GL & Co Estate Agents., for the vendor property whose agents they are, give notice that: 1. the particulars are produced in good faith, are set out as a general guide only and do not constitute any part of a contract. 2. no person in the employment of or agent of or consultant to GL & Co. has any representation or warranty whatever in relation to this property.





To arrange a viewing call us on 01903 744166 or email lettings@glproperty.co.uk

View online at www.glproperty.co.uk





To arrange a viewing call us on 01903 744166 or email lettings@glproperty.co.uk

View online at www.glproperty.co.uk



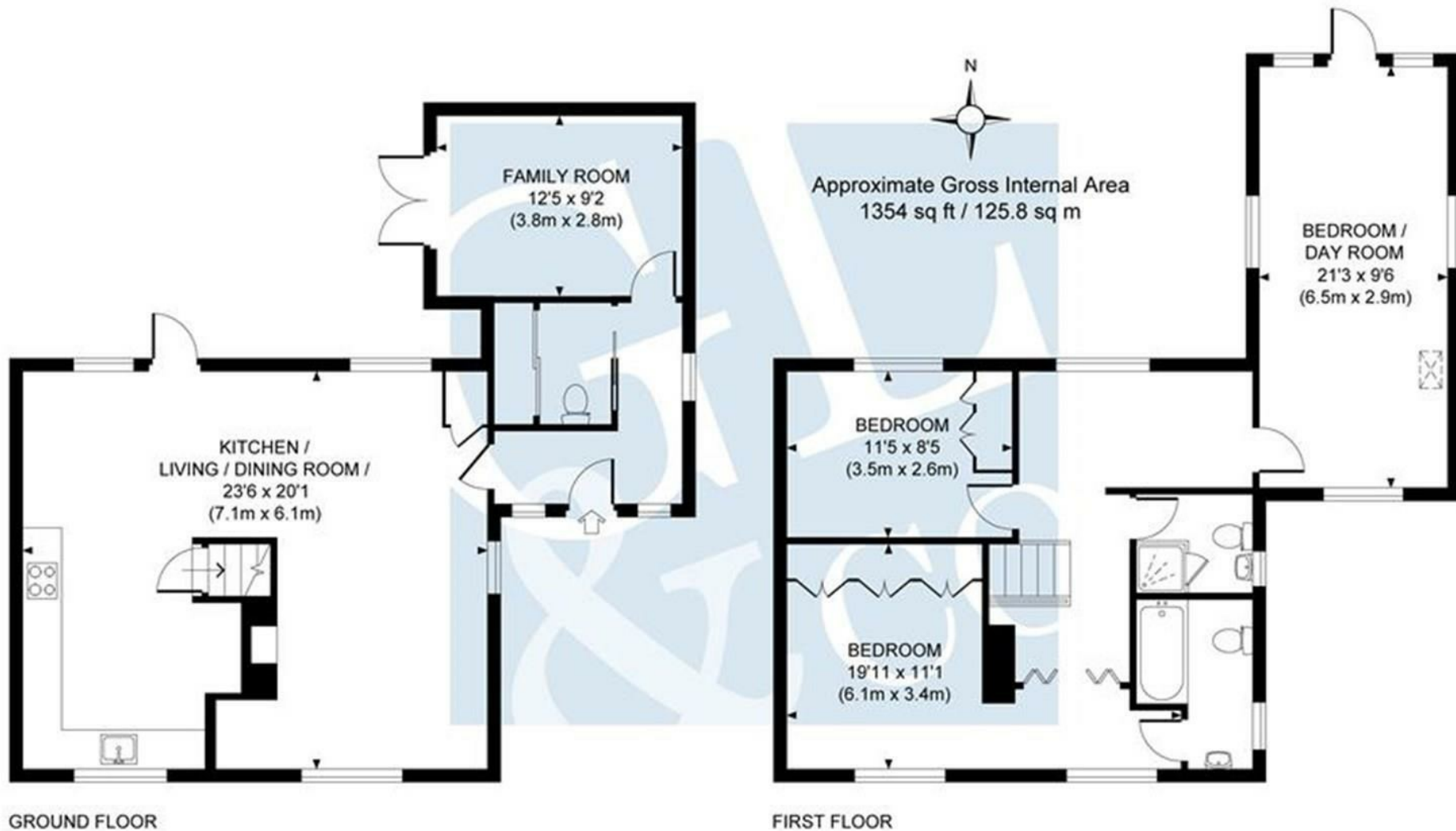

Agents Note: Whilst every care has been taken to prepare these particulars, they are for guidance purposes only. All measurements are approximate and are for general guidance purposes only and whilst every care has been taken to ensure their accuracy, they should not be relied upon and potential buyers/tenants are advised to recheck the measurements