



House - Terraced (EPC Rating: C)

4 KINGS ACRE MEWS OVER ROSS STREET, ROSS-ON-WYE, HR9 7AS

Per Month

£720 Per



1 Bedroom House - Terraced located in Ross-On-Wye

* THIS PROPERTY IS NOW LET AGREED* Please Do Contact Our Office With Your Search Criteria And Our Team Will Be Happy To Advise Of Any Other Available Property *



FLINT AND COOK HEREFORD LETTINGS | 22 BROAD STREET, HEREFORD,
HEREFORDSHIRE, HR4 9AP

Ground Floor

Approx. 22.1 sq. metres (238.1 sq. feet)

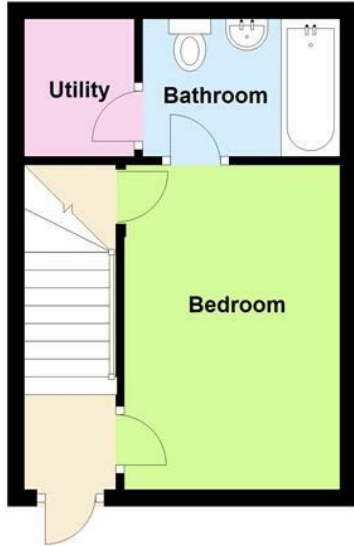

First Floor

Approx. 20.7 sq. metres (222.5 sq. feet)



This plan is for illustrative purposes only
Plan produced using PlanUp.

Council Tax Band

Energy Performance Graph

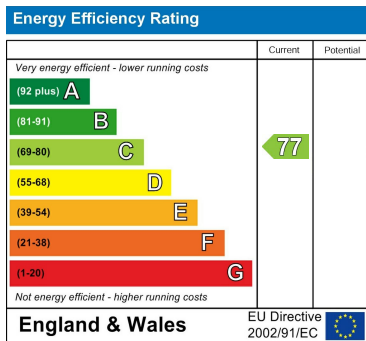

Call us on

01432 355455

lettings@flintandcook.co.uk

<https://www.flintandcook.co.uk/>

Agents Note: Whilst every care has been taken to prepare these particulars, they are for guidance purposes only. All measurements are approximate and are for general guidance purposes only and whilst every care has been taken to ensure their accuracy, they should not be relied upon and potential buyers are advised to recheck the measurements.

