

# Thistleberry Avenue, Newcastle

ST5 2LP

Offers In Excess Of £270,000



STEPHENSON BROWNE

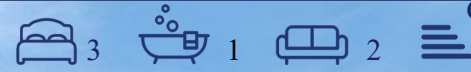

STEPHENSON BROWNE

# DESCRIPTION

SPACIOUS DETACHED FAMILY HOME WITH EXCELLENT POTENTIAL IN A PRIME POSITION & NEWCASTLE LOCATION

Situated in a prime position in the highly sought-after area of Newcastle-under-Lyme, this spacious three-bedroom detached home offers generous accommodation, a versatile layout with potential to adapt and remodel to suit individual needs, and exciting scope to extend (subject to the necessary permissions), making it an ideal family purchase.

The property welcomes you through an entrance hall with a convenient ground-floor WC. The spacious living room provides an excellent space for relaxing and entertaining, with folding doors opening into the dining room and a separate door leading through to the kitchen. Overlooking the rear garden, the dining room features a lovely bay window and sliding patio doors leading outside, while the kitchen also enjoys views over the garden and benefits from access to a useful utility/boiler room with its own external door.

Outside, the generous rear garden offers plenty of space for family life, while the area to the side of the property presents excellent scope for future extension, further enhancing the home's already impressive footprint.

To the first floor are three well-proportioned double bedrooms, a spacious family bathroom, and two useful storage cupboards.

Additional benefits include an integral garage, driveway parking, and side access to the rear garden.

Conveniently located close to Newcastle-under-Lyme town centre, well-regarded schools, local amenities, Royal Stoke



University Hospital, and excellent commuter links, this property combines space, flexibility, potential, and location in equal measure.

Offering fantastic family accommodation and exciting future possibilities, early viewing is highly recommended.



# ROOM DESCRIPTIONS

## Ground Floor

### Entrance Hall

5'7" x 3'8"

### W.C.

5'4" x 2'6"

### Living Room

13'6" x 14'11"

### Kitchen

9'4" x 9'6"

### Dining Room

13'5" x 10'5"

### Utility and Boiler Room

3'3" x 9'0"

### Garage

8'7" x 16'10"

## First Floor

### Bedroom One

11'10" x 10'10"

### Bedroom Two

12'5" x 11'10"

### Bedroom Three

11'3" x 9'1"

### Bathroom

7'0" x 8'7"

### Stephenson Browne AML Disclosure

Agents are required by law to conduct Anti-Money Laundering checks on all those buying a property. Stephenson Browne charge £49.99 plus VAT for an AML check per purchase transaction. This is a non-refundable fee. The charges cover the cost of obtaining relevant data, any manual checks that are required, and ongoing monitoring. This fee is payable in advance prior to the issuing of a memorandum of sale on the property you are seeking to buy.





# Floorplans

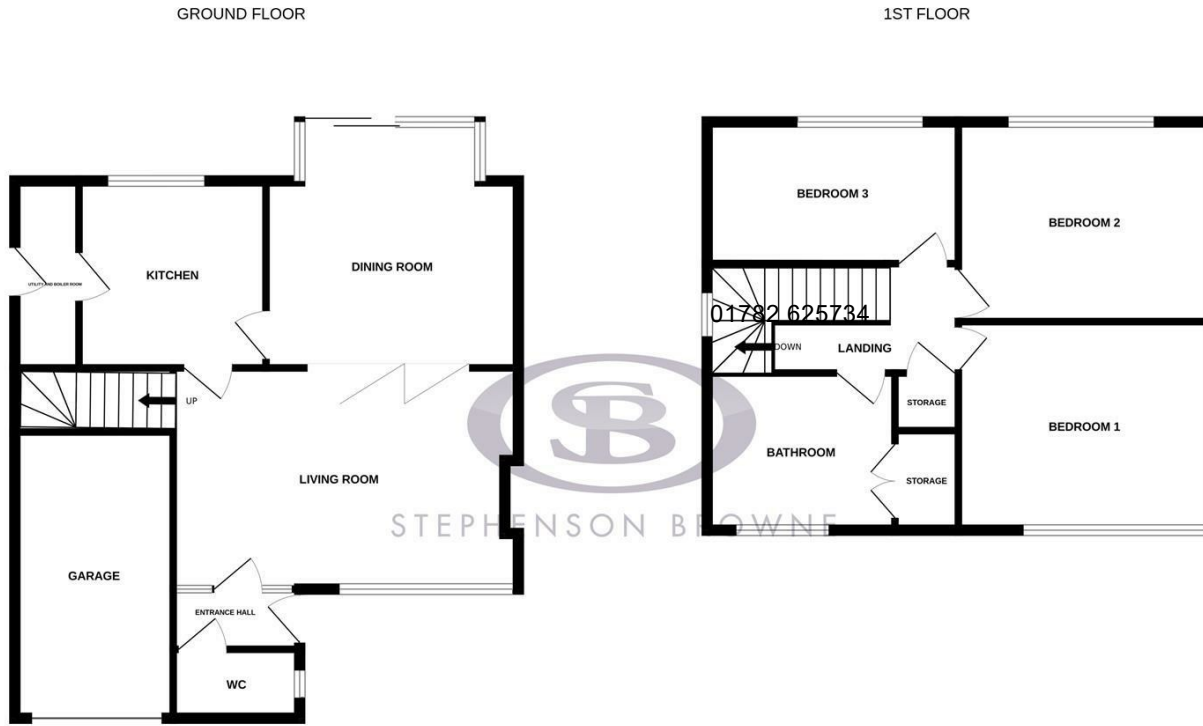

Whilst every attempt has been made to ensure the accuracy of the floorplan contained here, measurements of doors, windows, rooms and any other items are approximate and no responsibility is taken for any error, omission or mis-statement. This plan is for illustrative purposes only and should be used as such by any prospective purchaser. The services, systems and appliances shown have not been tested and no guarantee as to their operability or efficiency can be given.  
Made with Metropix ©2026

# Area Map

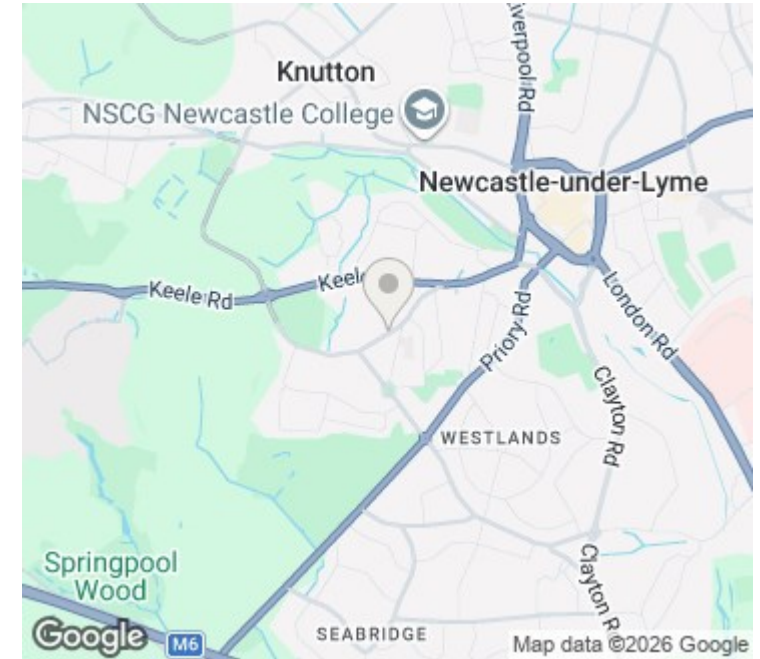

# EPC Rating

Energy Efficiency Rating		Environmental Impact (CO <sub>2</sub> ) Rating	
	Current	Potential	
Very energy efficient - lower running costs			Very environmentally friendly - lower CO <sub>2</sub> emissions
(92 plus) <b>A</b>			(92 plus) <b>A</b>
(81-91) <b>B</b>			(81-91) <b>B</b>
(69-80) <b>C</b>			(69-80) <b>C</b>
(55-68) <b>D</b>			(55-68) <b>D</b>
(39-54) <b>E</b>			(39-54) <b>E</b>
(21-38) <b>F</b>			(21-38) <b>F</b>
(1-20) <b>G</b>			(1-20) <b>G</b>
Not energy efficient - higher running costs			Not environmentally friendly - higher CO <sub>2</sub> emissions
<b>England &amp; Wales</b>	EU Directive 2002/91/EC	<b>72</b> <b>78</b>	<b>England &amp; Wales</b>
			EU Directive 2002/91/EC

# Viewing

Please contact our office using the details provided on the final page if you are interested in booking a viewing or require further information.

NOTICE: Stephenson Browne for themselves and for the vendors or lessors of this property whose agents they are give notice that: (1) the particulars are set out as a general guideline only for the guidance of intending purchasers or lessees, and do not constitute, nor constitute part of, an offer or contract; (2) all descriptions, dimensions, references to condition and necessary permissions for use and occupation, and other details are given in good faith and are believed to be correct but any intending purchasers or tenants should not rely on them as statements or representations of fact but must satisfy themselves by inspection or otherwise as to the correctness of each theme; (3) no person in the employment of Stephenson Browne has any authority to make representation or warranty whatever in relation to this property. (4) fixtures & fittings are subject to a formal list supplied by the vendors solicitors. **Referring to: Move with Us Ltd Average Fee: £123.64**

**T: 01782 625734 E: [newcastle@stephensonbrowne.co.uk](mailto:newcastle@stephensonbrowne.co.uk)**

**[www.stephensonbrowne.co.uk](http://www.stephensonbrowne.co.uk)**