

## Whatley Avenue, SW20

£2,500 Per calendar month

This renovated three bedroom house with generous garden is close to Wimbledon Chase station and Cannon Hill Common. The property has a large reception room with period fireplace, a modern separate kitchen with dishwasher and plenty of natural light throughout.

Whatley Avenue is 0.4 miles from Wimbledon Chase station (Thames Link) and 0.7 miles from Raynes Park station (South Western Railway) and all the shops, cafés and supermarkets that surround these stations.

### Features

- Three Double Bedroom House
- Modern Separate Kitchen
- Modern Bathroom
- Private Garden
- Large Reception Room
- Good Storage Throughout

# Whatley Avenue, London, SW20

To Garden

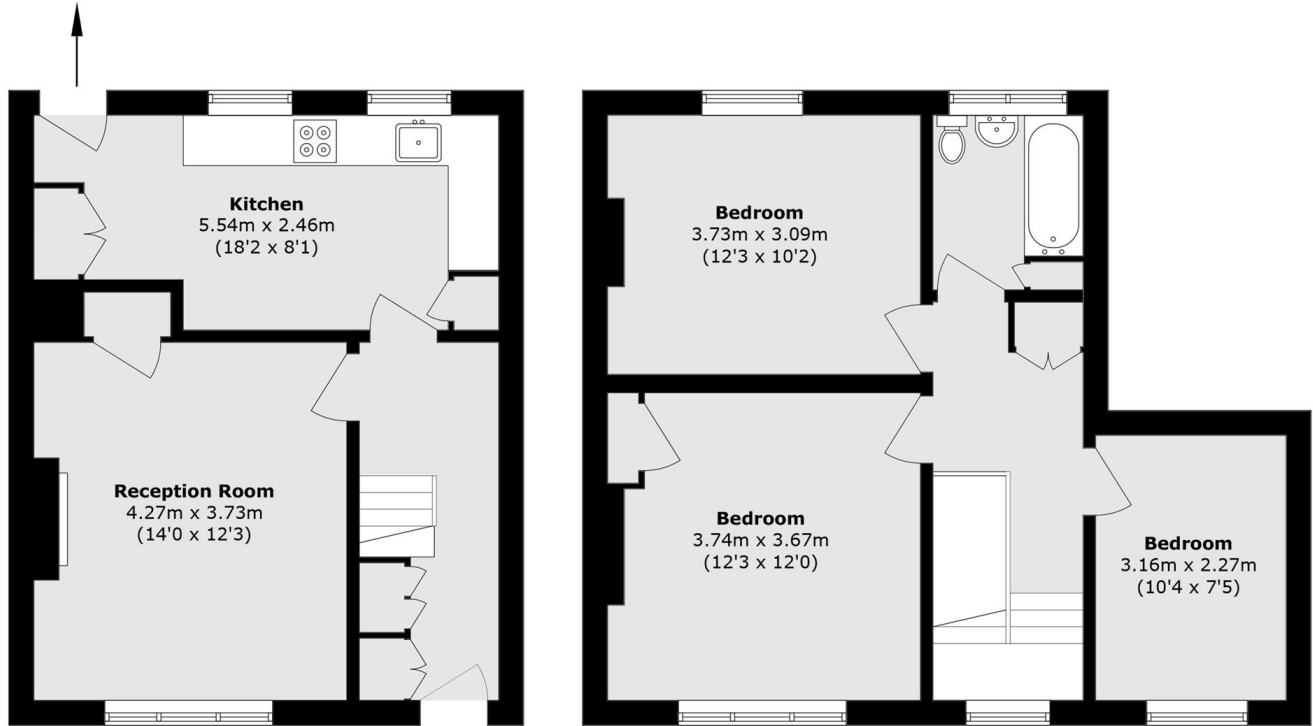

**Ground Floor**

**First Floor**

Total area (approx.): 85.5 sq. m (920.3 sq. ft)