



Slitting Mill Road | Rugeley | WS15 2UL

£1,050 Per Month

 **Webbs**
estate agents

Summary

A well presented two bedroom terraced cottage ideally situated along Slitting Mill Road in the sought-after semi-rural village of Slitting Mill, just outside Rugeley. In brief, the accommodation comprises: Lounge, Dining Room, Kitchen with integrated appliances, and Downstairs Bathroom. To the first floor, a return flight staircase leads to the First Floor Landing and Two Bedrooms. To the rear, the property benefits from a delightful courtyard garden with a decked seating area — perfect for relaxing and entertaining — with lovely views out to open fields beyond. On-road parking is available to the front.

DISCLAIMER - PLEASE READ: Webbs Estate Agents are acting as an advertising platform on behalf of the landlord. All enquiries will be passed to the landlord to be dealt with directly. By enquiring about this property, you are giving consent for your contact number to be passed onto the landlord. Please contact the office for further information.

Key Features

Rooms and Dimensions

PROPERTY DETAILS

TENANCY INFORMATION & IMPORTANT NOTES





Approx Gross Internal Area
69 sq m / 738 sq ft

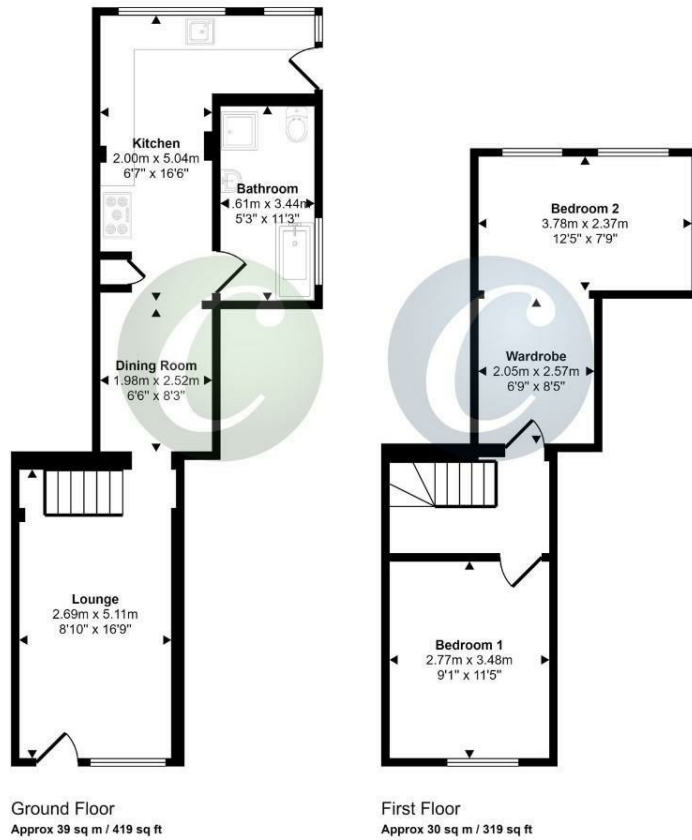

This floorplan is only for illustrative purposes and is not to scale. Measurements of rooms, doors, windows, and any items are approximate and no responsibility is taken for any error, omission or mis-statement. Icons of items such as bathroom suites are representations only and may not look like the real items. Made with Made Snappy 360.

Webbs Estate Agents - endeavour to maintain accurate depictions of properties in Virtual Tours, Floor Plans and descriptions, however, these are intended only as a guide and purchasers must satisfy themselves by personal inspection.

Energy Efficiency Rating		Environmental Impact (CO ₂) Rating	
Current	Potential	Current	Potential
Best energy efficiency - lower energy costs 100-120 kWh/m ² /year A		Best environmental impact - lower CO ₂ emissions 100-120 g/m ² /year A	
120-135 kWh/m ² /year B	135-150 kWh/m ² /year C	120-135 g/m ² /year B	135-150 g/m ² /year C
150-180 kWh/m ² /year D	180-220 kWh/m ² /year E	150-180 g/m ² /year D	180-220 g/m ² /year E
220-255 kWh/m ² /year F	255-300 kWh/m ² /year G	220-255 g/m ² /year F	255-300 g/m ² /year G
Minimum energy efficient - higher energy costs 300+ kWh/m ² /year G		Maximum environmental impact - higher CO ₂ emissions 300+ g/m ² /year G	
England & Wales EU Directive 2002/91/EC		England & Wales EU Directive 2002/91/EC	