



BROOK GAMBLE



1 Elms Avenue
, Eastbourne, BN21 3DN

Brook Gamble are delighted to offer to the market this good sized two bedroom top floor split-level converted apartment within yards of Eastbourne Seafront. Boasting a sun balcony off the 22'8 x 17'6 Lounge / Dining Room, the property enjoys sea views. The apartment is offered to the market chain free with further benefits including the large loft (not inspected), gas central heating, an allocated parking space, long lease and share of the freehold. Viewing is considered essential to fully appreciate the property. Sole Agents.

£179,950

1 Elms Avenue

, Eastbourne, BN21 3DN



- Top Floor Flat
- Sun Balcony
- 22'8 x 17'6 Lounge / Dining Room
- Sea Views
- Allocated Parking
- Chain Free
- Within Yards Of Seafront
- Share Of Freehold
- Sole Agents

Entrance

Lounge / Dining Room

22'8 x 17'6 (6.91m x 5.33m)

Kitchen

9'4 x 8 (2.84m x 2.44m)

Bedroom 1

13'4 x 11'7 (4.06m x 3.53m)

En-Suite Shower Room

Bedroom 2

13'9 x 10 (4.19m x 3.05m)

Cloakroom

Other Information



Directions



Floor Plan

Approx Gross Internal Area
82 sq m / 879 sq ft

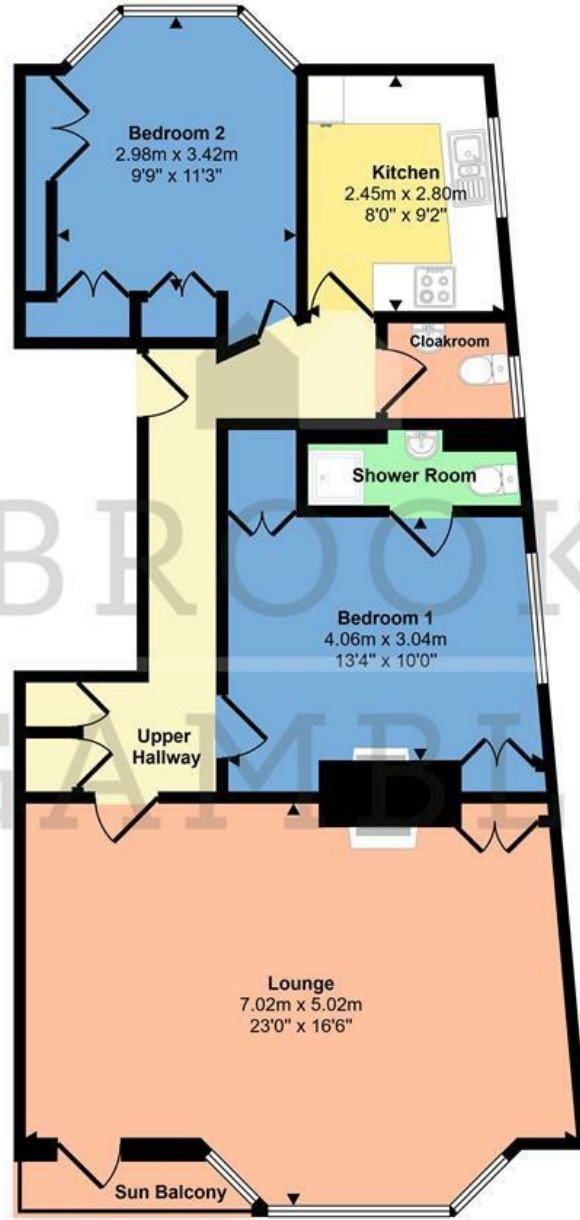

Floorplan

This floorplan is only for illustrative purposes and is not to scale. Measurements of rooms, doors, windows, and any items are approximate and no responsibility is taken for any error, omission or mis-statement. Icons of items such as bathroom suites are representations only and may not look like the real items. Made with Made Snappy 360.

These particulars, whilst believed to be accurate are set out as a general outline only for guidance and do not constitute any part of an offer or contract. Intending purchasers should not rely on them as statements of representation of fact, but must satisfy themselves by inspection or otherwise as to their accuracy. No person in this firm's employment has the authority to make or give any representation or warranty in respect of the property.

