

# *Callaghans*

Independent Estate Agents, Surveyors, Valuers and Mortgage Brokers

## **8 Stapleford Close, Manchester, M23 2SJ**



**£125,000**

**First Floor Flat  
One Bedroom  
Stylish Bathroom  
Open plan Lounge  
Off Road Parking  
Close to the Hospital**

Callaghans Estate Agents  
46 Church Road, Gatley, SK8 4NQ  
Telephone: 0161 491 4000, Fax: 0161 491 55 44  
Website: [www.callaghansltd.com](http://www.callaghansltd.com) Email: [admin@callaghansltd.com](mailto:admin@callaghansltd.com)

Callaghans are delighted to present this well-appointed first-floor, one-bedroom apartment, ideally located just a short distance from Wythenshawe Hospital. Offered with no onward chain, this property is ready for immediate occupancy, making it a perfect choice for first-time buyers or healthcare professionals seeking convenience and comfort.

The property features a bright and contemporary open-plan living space, seamlessly combining the lounge and modern kitchen. The kitchen is fitted with modern wall and base units, an integrated sink, oven, and gas hob, ideal for both everyday living and entertaining. The bathroom is finished to a high standard with stylish grey tiling, a modern suite, and an over-bath shower. A double sized double bedroom provides a comfortable and relaxing retreat.

Additional benefits include off-road parking and an excellent location with easy access to local amenities, transport links, and the hospital.

Don't miss out; contact Callaghans today to arrange your viewing and take the first step toward your new home.

**Lounge** 12' 4" x 9' 3" (3.75m x 2.83m)

**Kitchen** 7' 10" x 5' 6" (2.38m x 1.67m)

**Bathroom** 5' 5" x 6' 4" (1.65m x 1.92m)

**Bedroom** 5' 5" x 6' 4" (1.65m x 1.92m)

Callaghans Estate Agents  
46 Church Road, Gatley, SK8 4NQ  
Telephone: 0161 491 4000, Fax: 0161 491 55 44  
Website: [www.callaghansltd.com](http://www.callaghansltd.com) Email: [admin@callaghansltd.com](mailto:admin@callaghansltd.com)

GROUND FLOOR  
292 sq.ft. (27.1 sq.m.) approx.

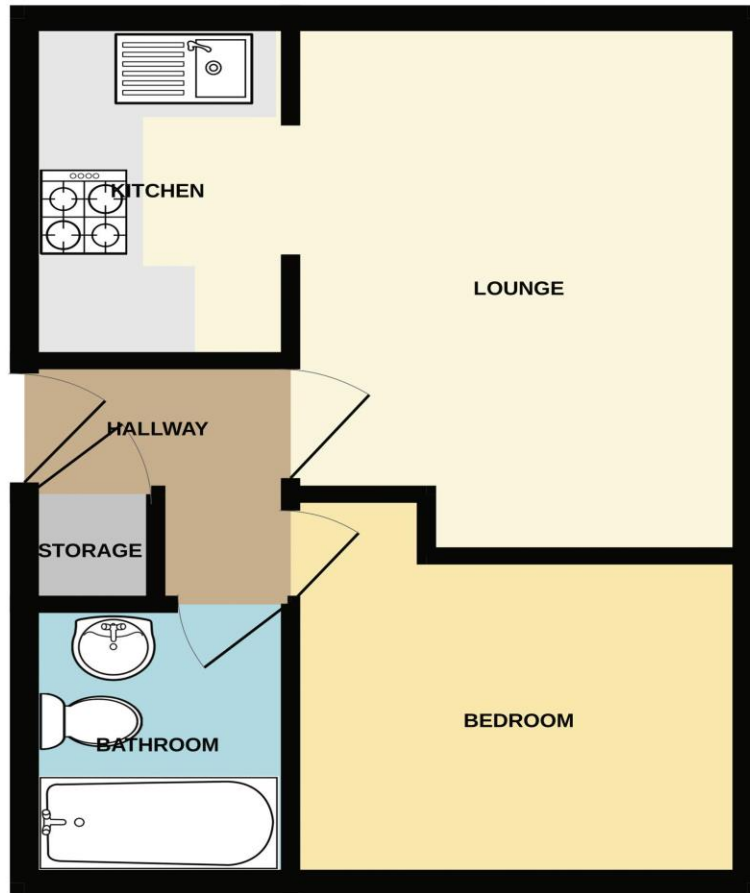

TOTAL FLOOR AREA : 292 sq.ft. (27.1 sq.m.) approx.

Whilst every attempt has been made to ensure the accuracy of the floorplan contained here, measurements of doors, windows, rooms and any other items are approximate and no responsibility is taken for any error, omission or mis-statement. This plan is for illustrative purposes only and should be used as such by any prospective purchaser. The services, systems and appliances shown have not been tested and no guarantee as to their operability or efficiency can be given.  
Made with Metropix ©2026

Disclaimer:

These particulars, whilst believed to be accurate are set out as a general guideline only or guidance and do not constitute any part of an offer or contract. Intending purchasers should not rely on them as statements of representation or fact, but must satisfy themselves by inspection or otherwise as to their accuracy. Please note that we have not tested any apparatus, equipment, fixtures, fittings or services, including gas central heating and so cannot verify they are in working order or fit for their purpose. Further more solicitors should confirm movable items described in the sales particulars are, in fact included in the sale since circumstances do change during marketing or negotiations. Although we try to ensure accuracy, measurements used in this brochure may be approximate. Therefore if intending purchasers need accurate measurements to order carpeting or to ensure existing furniture will fit, they should take such measurements themselves. **YOUR HOME IS AT RISK IF YOU DO NOT KEEP UP REPAYMENTS ON A MORTGAGE OR OTHER LOAN SECURED ON IT**