

## Newington Causeway, SE1 £330,000

A highly attractive, south-facing apartment with a fully fitted kitchen, a spacious living room, a generous double bedroom and a three piece bathroom. Benefiting from secure off-street parking, 24 hour concierge, residents' gym and swimming pool. Sold chain free.

Metro Central Heights is enviably located, moments from Elephant & Castle tube station and overground, whilst also within easy reach of Borough and London Bridge. There are numerous amenities on your door step and excellent transport links across the Capital.

### Features

- One Bedroom Apartment
- South-Facing
- Residents' Gym & Pool
- 24 Hour Concierge
- Communal Courtyard
- Chain Free Sale

# Newington Causeway, London, SE1

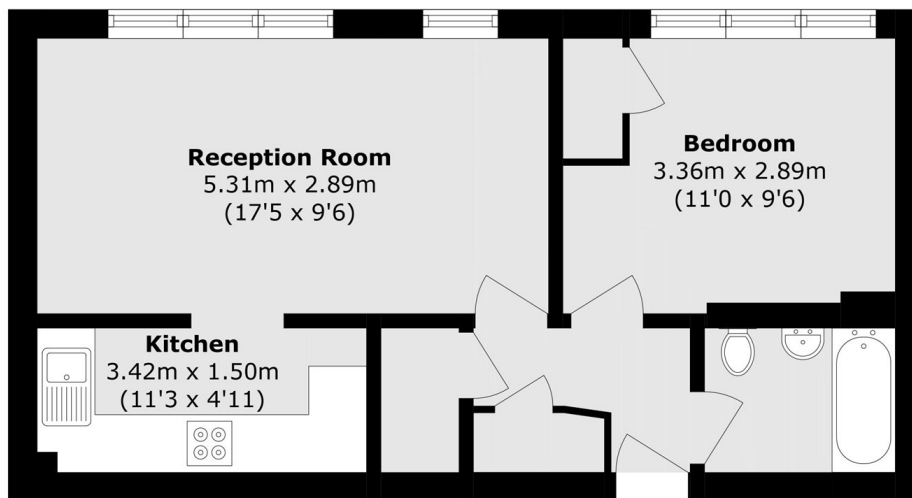

Total area (approx.): 40.1 sq. m (431.6 sq. ft)