



Davy Close,
Burntwood, WS7 4FB

Offers in the Region Of £375,000

Offers in the Region Of £375,000



CLOSE TO ERASMUS DARWIN ACADEMY

Welcome to Davy Close, nestled within a quaint cul-de-sac location lies this lovely detached family home which presents itself well throughout.

Internally you have a welcoming entrance hallway, modern breakfast kitchen, spacious family lounge diner and completing the ground floor is the guest W/C. Stairs lead to the first floor where you have four well proportioned bedrooms, an en suite to master and also a family bathroom.

Outside is a charming and generously sized rear garden, the most perfect space for any growing family or keen gardener. To the fore is a multi vehicle driveway and also an integral garage.

Nearby amenities include a handful of shops, easily accessible transport links and walking distance to Erasmus Darwin Academy.

CALL NOW TO VIEW!!!







Property Specification

CLOSE TO ERASMUS DARWIN ACADEMY
DETACHED PROPERTY
FOUR BEDROOMS
SPACIOUS LOUNGE DINER
MODERN KITCHEN

Entrance Hall

Lounge Diner 11' 0" x 21' 1" (3.35m x 6.43m)

Kitchen/Breakfast Room 11' 1" x 8' 7" (3.38m x 2.62m)

W/C

Garage

Landing

Bedroom One 11' 2" x 11' 0" (3.40m x 3.35m)

En Suite

Bedroom Two 11' 2" x 10' 7" (3.40m x 3.23m)

Bedroom Three 11' 1" x 7' 5" (3.38m x 2.26m)

Bedroom Four 11' 2" x 7' 4" (3.40m x 2.24m)

Bathroom

Viewer's Note:

Services connected: Gas, Electric, Water, Drainage
Council tax band: D
Tenure: Freehold

Every care has been taken with the preparation of these Sales Particulars but they are for general guidance only and complete accuracy cannot be guaranteed. If there is any point which is of particular importance, professional verification should be sought. The mention of any fixtures, fittings and/or appliances does not imply they are in full efficient working order as they have not been tested. All dimensions are approximate. Photographs are reproduced for general information and it cannot be inferred that any item shown is included in the sale. These Sales Particulars do not constitute a contract or part of a contract. Came on the market:

Identity Verification Fee - We are required by law to conduct anti-money laundering checks on all those buying a property as part of our due diligence. As agents acting on behalf of the seller, we are required to verify the identity of all purchasers once an offer has been accepted, subject to contract. The initial checks are carried out on our behalf by Lifetime Legal. A non-refundable administration fee of £40 + VAT (£48 including VAT) applies which covers the cost of obtaining relevant data and any manual checks and monitoring which might be required. This fee will need to be paid by you in advance of us issuing a memorandum of sale, directly to Lifetime Legal, and is non-refundable.

Floor Plan

This floor plan is not drawn to scale and is for illustration purposes only

Ground Floor

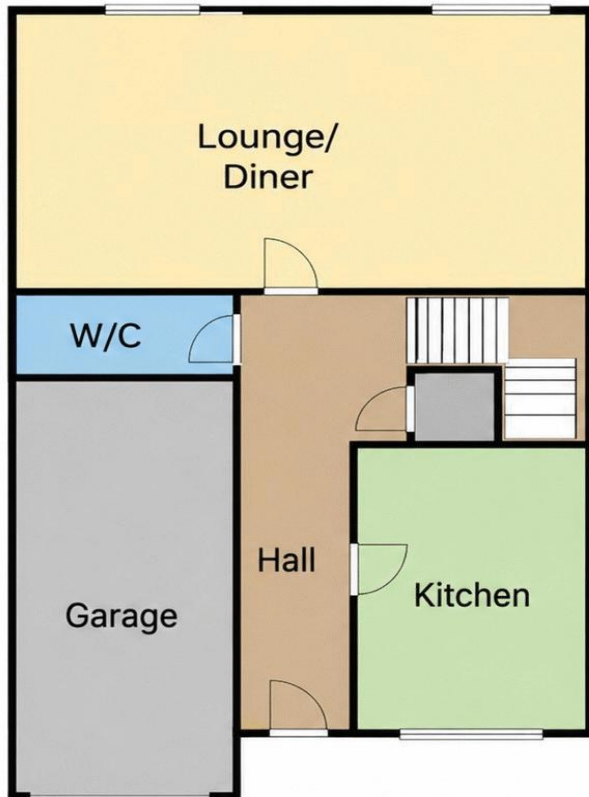

First Floor

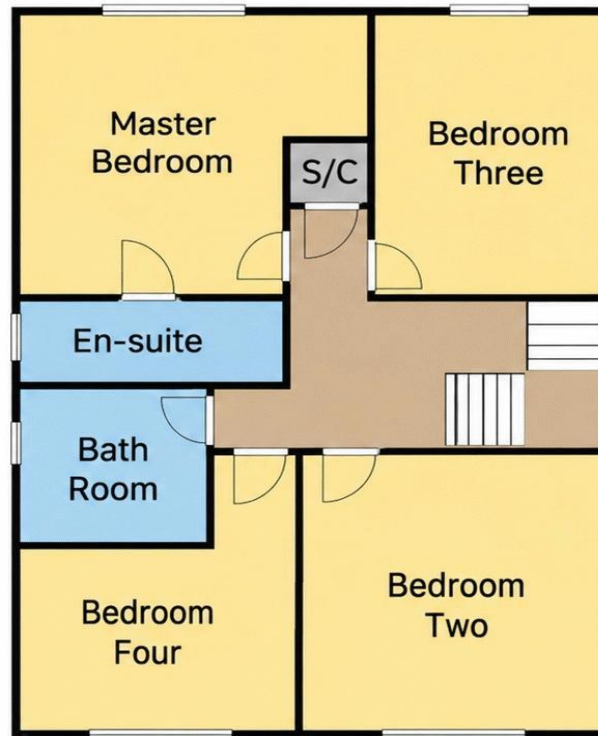

Energy Efficiency Rating

**New
Instruction
Awaiting
E.P.C.**

Map Location

