



athertons
estate agents



athertons
property & land

11 The Grange, Wilpshire, BB1 9JU
£475,000



11 The Grange, Wilpshire, BB1 9JU

Occupying a superb corner plot position within a peaceful and highly regarded residential setting, this substantial three-storey detached residence enjoys a wonderful woodland backdrop, exceptional privacy and beautifully maintained gardens which sweep around the property. Offering versatile family accommodation alongside a lower ground floor and integral garage, the home combines generous internal space with attractive outdoor areas and elevated green views, creating a superb opportunity for growing families seeking a home within a tranquil yet convenient location.

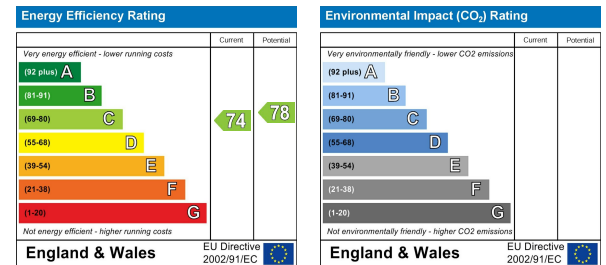
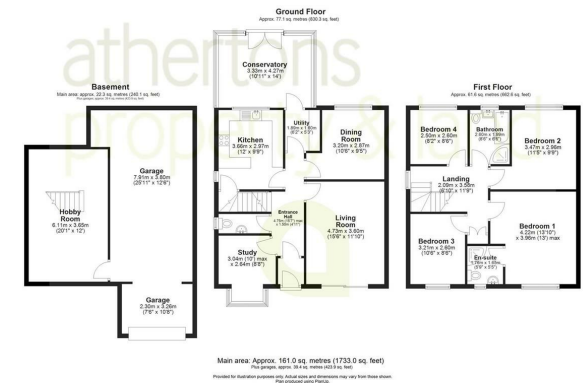

These particulars, whilst believed to be accurate are set out as a general outline only for guidance and do not constitute any part of an offer or contract. Intending purchasers should not rely on them as statements of representation of fact, but must satisfy themselves by inspection or otherwise as to their accuracy. No person in this firm's employment has the authority to make or give any representation or warranty in respect of the property.