



**24 Chestnut Drive, Mansfield,
Nottinghamshire, NG18 4PW**

Offers Over £395,000

Tel: 01623 626990

 **RICHARD
WATKINSON
PARTNERS**

Surveyors, Estate Agents, Valuers, Auctioneers

- Extended Detached Bungalow
- Large Open Plan Lounge/Dining Room
- Kitchen/Breakfast Room
- South Facing Rear Garden
- Immaculate Resin Driveway
- Three Bedrooms
- High Quality Modern Bathroom
- New Boiler (January 2026)
- 7m Garage with WC
- Desirable Berry Hill Location

We are delighted to present to the market this extended three bedroom detached bungalow with a resin driveway, garage and a south facing rear garden in a highly regarded location.

The property was extended to the rear approximately 40 years ago creating a new, dual aspect kitchen/breakfast room with French doors leading out onto the rear garden.

The property is presented in immaculate condition throughout and ideally suits buyers who are looking to downsize. The living accommodation comprises an entrance porch, entrance hall, large open plan Lounge/Dining room with French doors, kitchen/breakfast room with integrated appliances and granite work surfaces, three bedrooms and a high quality, modern, fully tiled, bathroom comprising a five piece suite. The property has UPVC double glazing and gas central heating from a brand new boiler installed in January 2026.

The property is offered to the market with the benefit of no upward chain and viewing is highly recommended.

OUTSIDE

The property occupies a good sized yet manageable plot extending to circa 0.16 of an acre, set back from the road approached by an immaculate resin driveway which leads to a garage with a remote controlled electric up and over door and a WC. The front garden is low maintenance mainly laid to pebbles with plants and shrubs and a raised border to one side. There are hardstanding paths to each side of the property leading to the rear, one side has a retaining brick walled boundary with pebbles above. To the rear of the property, there is a hardstanding path leading to a rear door into the garage. Beyond here, the path leads to an open fronted storm porch with quarry tiled floor and a composite door leading into the kitchen. The sunny south facing garden enjoys a large central lawn and an extensive L-shaped paved patio off both the kitchen and lounge French doors, enclosed by a low retaining walled boundary which offers a lovely outdoor entertaining space. There are deep borders to both sides and at the end of the garden with mature plants, shrubs and trees.

A UPVC DOUBLE GLAZED FRONT ENTRANCE DOOR PROVIDES ACCESS THROUGH TO THE:

ENTRANCE PORCH

5'10" x 4'0" (1.78m x 1.22m)

With tiled floor and connecting obscure UPVC double glazed door through to the:

ENTRANCE HALL

15'0" x 8'10" (4.57m x 2.69m)

With radiator, wood floor, coving to ceiling, loft hatch and airing/cloaks cupboard housing the hot water cylinder plus additional overhead storage cupboard.

OPEN PLAN LOUNGE/DINING ROOM

23'2" x 20'6" into dining area (7.06m x 6.25m into dining area)

A large, L-shaped, open plan reception room featuring a marble fireplace with inset stone effect gas fire. Three radiators, wood flooring, coving to ceiling, double glazed windows to the front and side elevations and French doors leading out onto the south facing rear garden.

KITCHEN/BREAKFAST ROOM

16'4" x 10'9" max (4.98m x 3.28m max)

Having a range of modern cabinets with brushed metal handles comprising wall cupboards, base units and drawers complemented by granite work surfaces. Under mount 1 1/2 bowl stainless steel sink with mixer tap and drainer built into the worktop. Integrated double oven, four ring electric hob, stainless steel splashback and stainless steel extractor hood above. Integrated dishwasher and integrated fridge/freezer. Integrated washing machine and separate integrated tumble dryer. Cupboard housing the Worcester Bosch boiler, tiled floor, radiator, coving to ceiling, double glazed window to the side elevation and a composite door and separate French doors lead out onto the south facing rear garden.

BEDROOM 1

13'4" x 9'10" (4.06m x 3.00m)

Having extensive fitted wardrobes with hanging rails and shelving plus additional overhead storage cupboards. Radiator, coving to ceiling and double glaze window to the rear elevation.

BEDROOM 2

12'6" x 10'5" (3.81m x 3.18m)

Having extensive fitted wardrobes with hanging rails and shelving and mirror fronted sliding doors. Radiator, coving to ceiling and double glazed window to the front elevation.

BEDROOM 3

9'5" x 8'2" (2.87m x 2.49m)

With radiator and double glazed window to the front elevation.

BATHROOM

11'0" x 7'2" (3.35m x 2.18m)

Having a high quality, modern, five piece white suite by Britton Bathrooms with chrome fittings comprising a panelled bath with waterfall mixer tap. Separate tiled shower cubicle. Wash hand basin with waterfall mixer tap with ample tiled work surfaces to the side. Bidet with mixer tap and wall hung WC with enclosed cistern. Large contemporary radiator, shaver point, fully tiled walls, tiled floor, three ceiling spotlights and obscure double glazed window to the rear elevation.

GARAGE

23'3" max x 10'0" (7.09m max x 3.05m)

With power and light point. Housing the gas meter, electricity meter and fuse box. Having wall cupboards, base units and drawers, inset stainless steel sink with drainer and mixer tap with hot and cold water supply. Obscure glazed window to the side elevation, outside tap, composite rear door leading out onto the garden and a remote controlled electric up and over door.

WC

5'0" x 3'1" (1.52m x 0.94m)

Having a WC and wall hung wash and basin with tiled splashbacks. Tiled floor and light point.

VIEWING DETAILS

Strictly by appointment with the selling agents. For out of office hours please call Alistair Smith, Director at Richard Watkinson and Partners on 07817-283-521.

TENURE DETAILS

The property is freehold with vacant possession upon completion.

SERVICES DETAILS

All mains services are connected.

MORTGAGE ADVICE

Mortgage advice is available through our independent mortgage advisor. Please contact the selling agent for further information. Your home is at risk if you do not keep up with repayments on a mortgage or other loan secured on it.

FIXTURES & FITTINGS

Any fixtures and fittings not mentioned in these details are excluded from the sale price. No services or appliances which may have been included in these details have been tested and therefore cannot be guaranteed to be in good working order.

















Chestnut Drive, Mansfield
Approximate Gross Internal Area
Bungalow = 1140 SQ FT / 106 SQ M
Garage = 237 SQ FT / 22 SQ M
Total = 1377 SQ FT / 128 SQ M

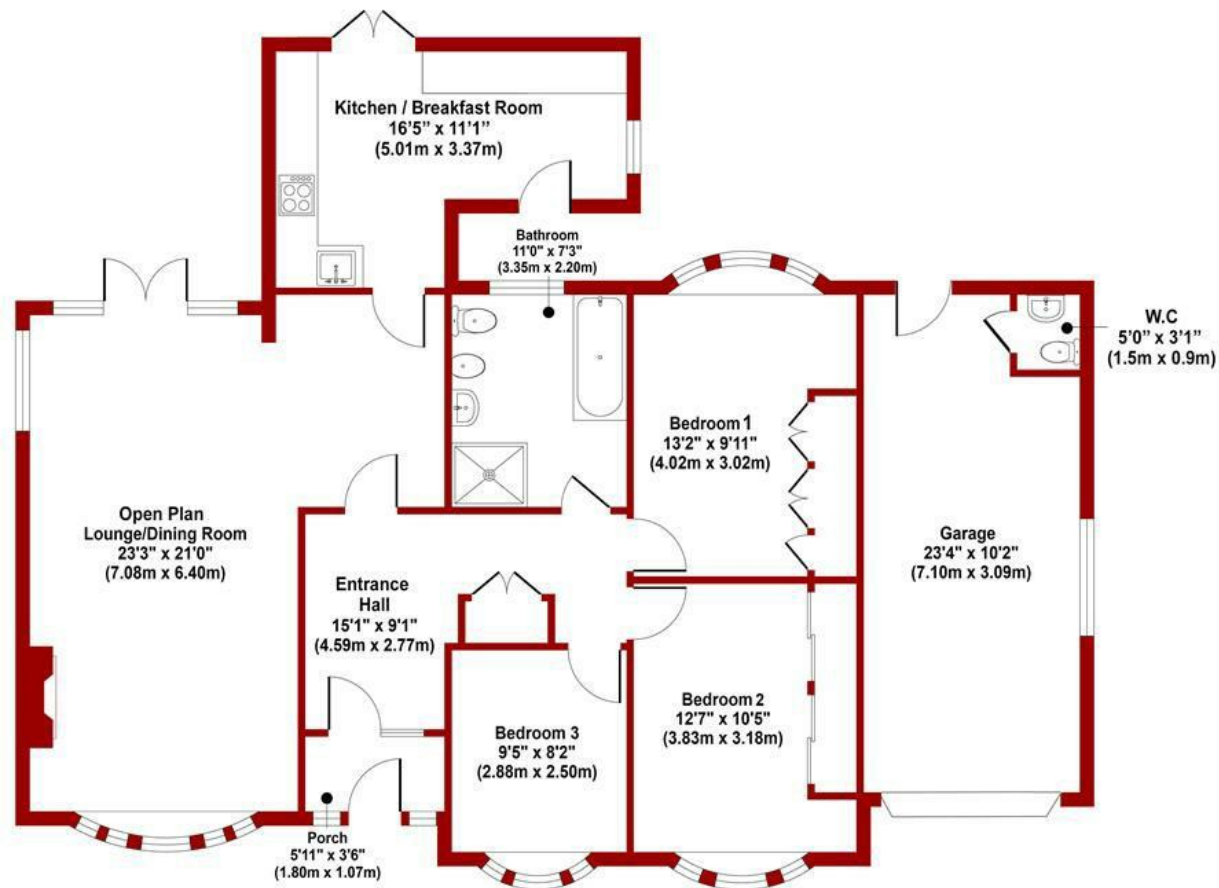

Floorplan

FOR ILLUSTRATIVE PURPOSES ONLY - NOT TO SCALE
The position & size of doors, windows, appliances and other features are approximate only



Energy Efficiency Rating		
	Current	Potential
Very energy efficient - lower running costs		
(92 plus) A		
(81-91) B		
(69-80) C		
(55-68) D		
(39-54) E		
(21-38) F		
(1-20) G		
Not energy efficient - higher running costs		
	63	72
England & Wales		
EU Directive 2002/91/EC		

Environmental Impact (CO ₂) Rating		
	Current	Potential
Very environmentally friendly - lower CO ₂ emissions		
(92 plus) A		
(81-91) B		
(69-80) C		
(55-68) D		
(39-54) E		
(21-38) F		
(1-20) G		
Not environmentally friendly - higher CO ₂ emissions		
England & Wales		
EU Directive 2002/91/EC		



These particulars, whilst believed to be accurate are set out as a general outline only for guidance and do not constitute any part of an offer or contract. Intending purchasers should not rely on them as statements of representation of fact, but must satisfy themselves by inspection or otherwise as to their accuracy. No person in this firm's employment has the authority to make or give any representation or warranty in respect of the property. Any fixtures and fittings not mentioned in these details are excluded from the sale price. No services or appliances which may have been included in these details have been tested by the selling agent and therefore cannot be guaranteed to be in good working order.

As part of the service we offer we may recommend ancillary services to you such as mortgage advice, solicitors and surveyors which we believe will help with your property transaction. We wish to make you aware that should you decide to proceed we may receive a referral fee or equivalent. This could be a fee, commission, payment or other reward. We will not refer your details unless you have provided consent for us to do so. You are not under any obligation to provide us with your consent or to use any of these services. You are also free to choose an alternative provider.

Thinking of selling? For a FREE no obligation quotation call 01623 626990



Richard Watkinson & Partners is the trading name of Richard Watkinson Ltd.
Registered in England. Ltd Registration number: 07140024

1 Albert Street,
Mansfield NG18 1EA
Tel: 01623 626990
Email: mansfield@richardwatkinson.co.uk



Surveyors, Estate Agents, Valuers, Auctioneers