

Central Avenue, SW6

£600 Per week

An modern one double bedroom apartment with a private balcony and river views set in the desirable Fulham Riverside development, which benefits from landscaped communal gardens and 24-hour concierge.

Fulham Riverside is perfectly located between South Park and Imperial Park, moments away from amenities such as Sainsburys, local cafés and restaurants and the prestigious Hurlingham Club.

Features

- One Double Bedrooms
- Private Balcony
- River Views
- Private Gym
- Unfurnished
- 24-Hour Concierge

Central Avenue, London, SW6

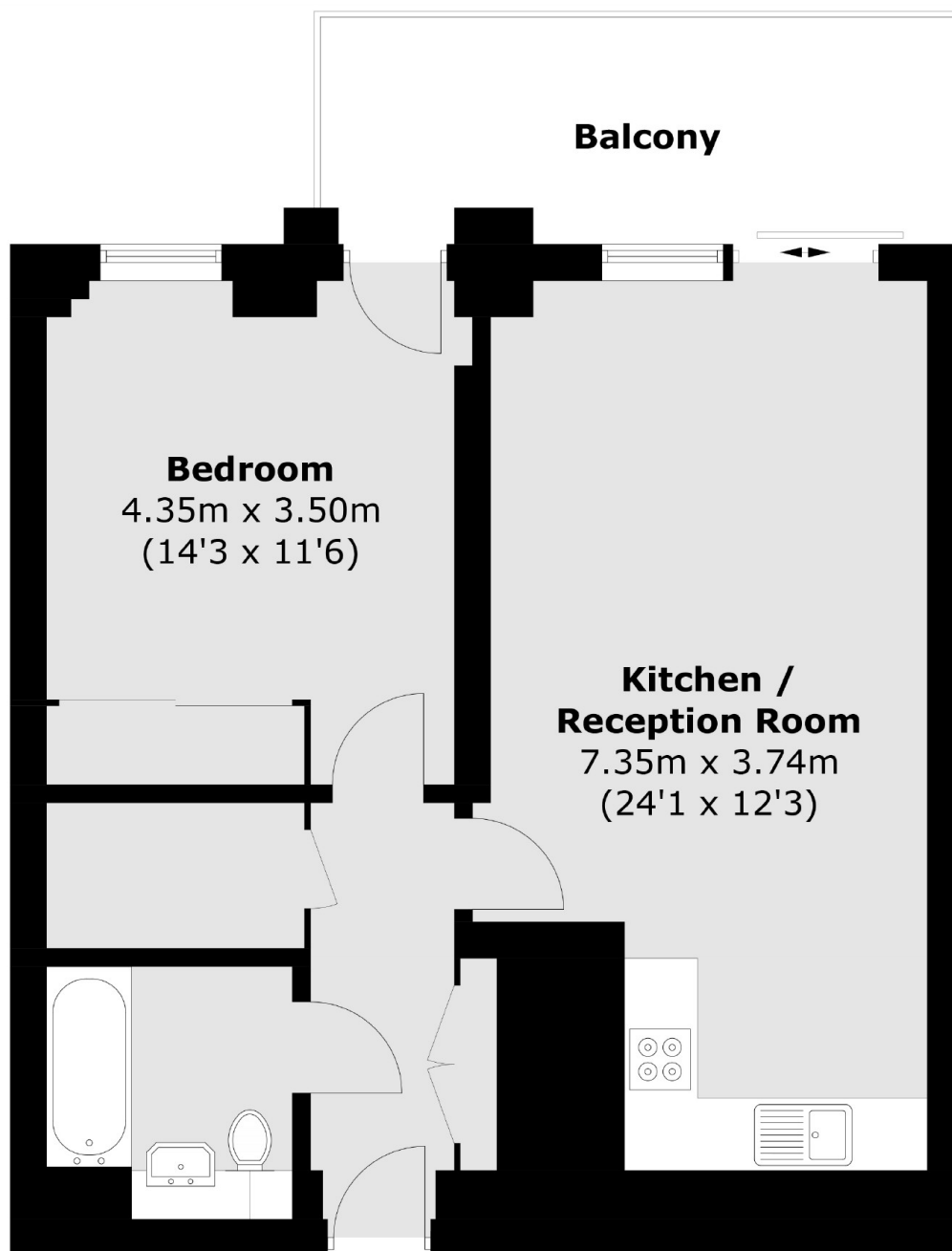

Total area (approx.): 54.8 sq. m (589.9 sq. ft)
Balcony area (approx.): 9.5 sq. m (102.2 sq. ft)