



Streatham High Road, SW16

£350,000

A one double bedroom property filled with natural light is a perfect first time purchase. The open-plan living accommodation has a modern fitted kitchen and space for both lounging and dining. The large bedroom has a fitted wardrobe, whilst the handy utility cupboard in the hallway creates extra storage. The development benefits from a communal resident's courtyard which can be accessed via the private patio as well as a 24/7 concierge and security. There is also a private parking space that comes with the property.

Derry Court is within walking distance to Streatham Station, providing direct access into the City via Thameslink. Streatham Common Station is also nearby and provides access to London Bridge and Victoria via Southern Railway. There are many local amenities including supermarkets, gym and leisure centre as well as the open space of Streatham Common. Streatham High Road benefits from a wide variety of restaurants and shops.

Features

- Private Terrace
- Communal Courtyard
- Open-Plan Living
- Modern Development
- Close to Station
- Car Parking Space

Streatham High Road,
London, SW16

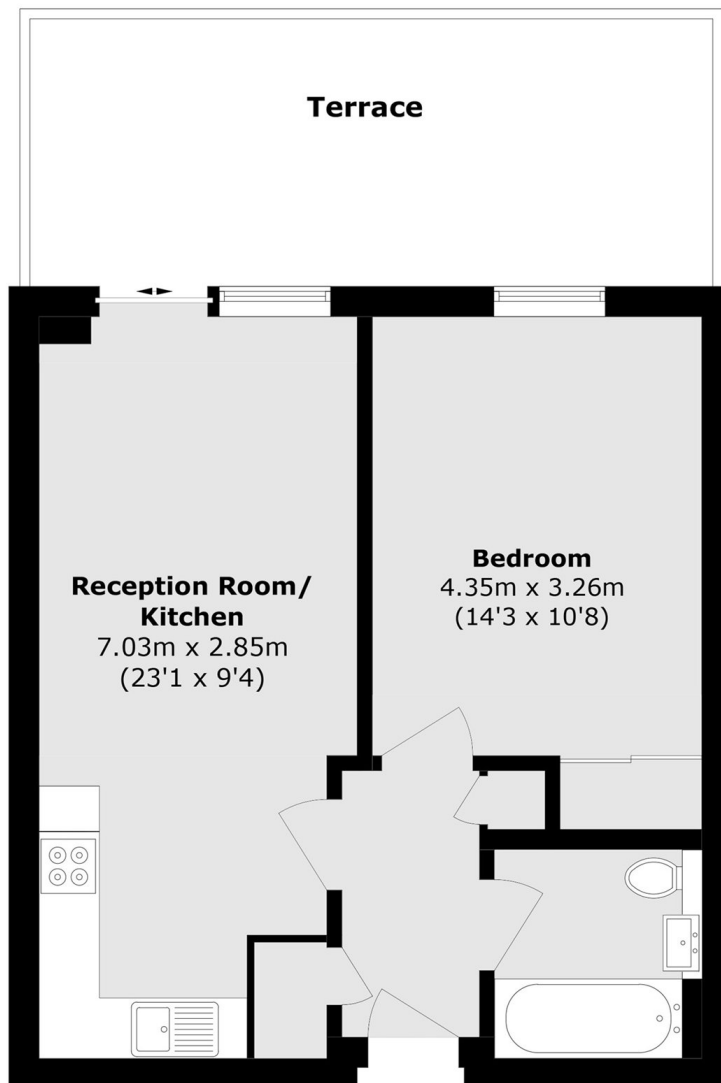

Total area (approx.): 47.7 sq. m (513.4 sq. ft)
Terrace area (approx.): 17.9 sq. m (192.6 sq. ft)

Dexters

Streatham
105 Streatham Hill
London
SW2 4UG
Sales
020 8674 7400

Energy Rating: B. We aim to make our particulars both accurate and reliable. However they are not guaranteed; nor do they form part of an offer or contract. If you require clarification on any points then please contact us, especially if you're traveling some distance to view. Please note that appliances and heating systems have not been tested and therefore no warranties can be given as to their good working order.

 **RICS** | Regulated
Estate Agent
and Letting Agent

dexters.co.uk