

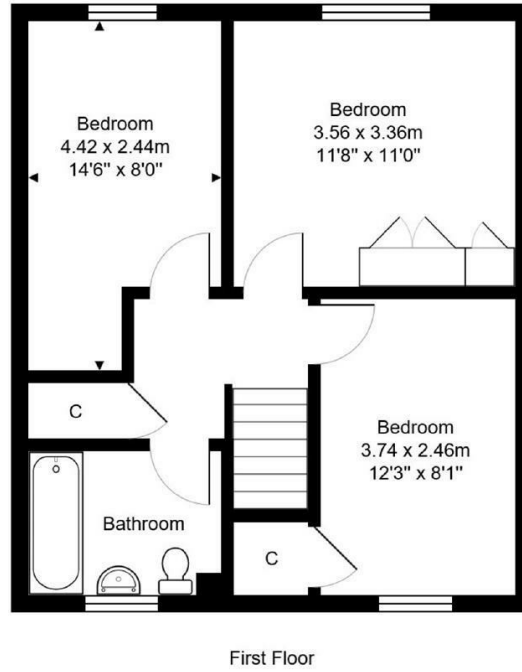

43, WILLOW WAY, BEGBROKE, OX5 1SD

FLOWERS
ESTATE AGENTS

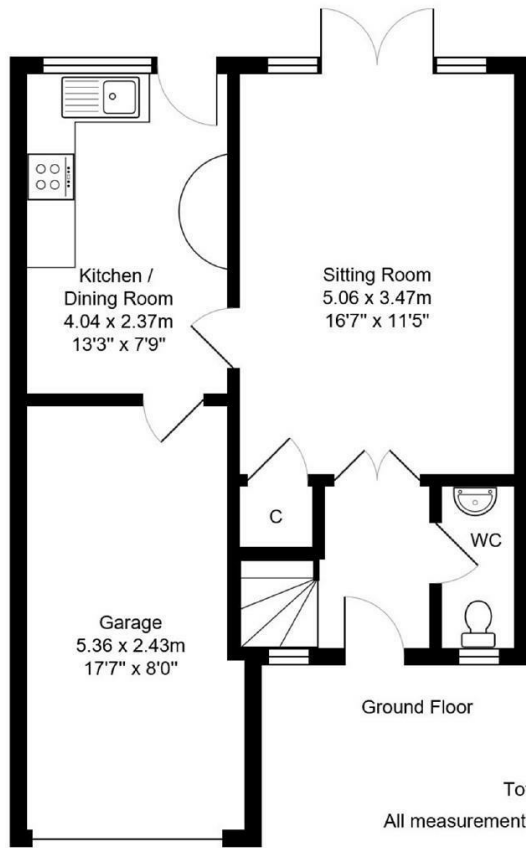

Total Area: 95.8 m² ... 1031 ft²
 All measurements are approximate and for display purposes only.





43, Willow Way, Begbroke, OX5 1SD

Freehold

- Mid-terrace home
- Welcoming and well maintained
- Quiet cul-de-sac location
- Driveway parking
- Council tax band D | EPC band D
- Three double bedrooms
- Mature rear garden
- Single garage
- Desirable village with excellent travel links to Oxford City

A spacious 3 bedroom property situated in a quiet cul-de-sac in the popular village of Begbroke.

The accommodation is deceptively spacious and briefly comprises an entrance hall with WC, a large sitting room with French doors on to the garden and a kitchen/dining room on the ground floor with 3 double bedrooms and a family bathroom on the first floor.

The rear garden is of a good size and is mainly laid to lawn with a patio area, raised beds and mature shrubs & trees. The property benefits from gated access into the rear garden and driveway parking to the front, in addition to an integral garage.



' SPACIOUS 3 BEDROOM PROPERTY IN THE POPULAR VILLAGE OF BEGBROKE '



CONTACT

Flowers Estate Agents

London House
16 Oxford Street
Woodstock
OX20 1TS

01993 627766
woodstock@flowersestateagents.com

Energy Efficiency Rating		
	Current	Potential
Very energy efficient - lower running costs		
(92 plus) A		
(81-91) B		86
(69-80) C		
(55-68) D	67	
(39-54) E		
(21-38) F		
(1-20) G		
Not energy efficient - higher running costs		
England & Wales	EU Directive 2002/91/EC	

Area description

Begbroke is a village located between Woodstock and Oxford with good transport links to both including a cycle path. Part of the village dates back to the 12th century including a Norman Church. Amenities include an Ofsted 'good' rated playgroup, a Village Hall, and a Pub and the nearby town of Woodstock provides banks, shops, bars, restaurants and schooling. Just a short walk away, Begbroke Science Park is home to many of the Oxford University research groups.

Local Authority: Cherwell District Council
Council Tax Band: D

These details are prepared for the convenience of prospective purchasers, and are a general outline for guidance. They do not constitute parts of an offer or contract. All descriptions, dimensions, references to permission for use or occupation, and any other details, are given in good faith and are believed to be correct, but any intending purchaser should not rely on them as statements or representations of fact, but must satisfy themselves by inspection or otherwise as to the correctness of these details. Photographs contained in these details may have been taken with a wide angle lens.

