



**POOLE  
TOWNSEND**

# Abbots Vale Mews, Barrow-in-furness, LA13 9PS

Offers Over £179,950

🛏 2 🚿 1 🚗 1



- 2 Bed Semi-Detached Bungalow
- Off-Road Parking
- Located In A Popular Residential Area
- A Fitted Kitchen
- Well Presented Property
- Close To Local Amenities
- Double Glazing
- Bright Lounge/Dinning Room
- Easy To Manage Front A Rear Gardens
- Ready To Move Into



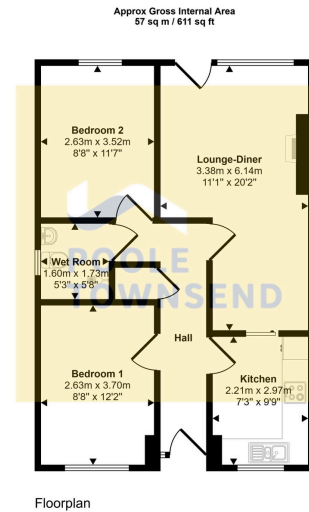

This floorplan is only for illustrative purposes and is not to scale. Measurements of rooms, doors, windows, and any items are approximate and no responsibility is taken for any error, omission or mis-statement. Icons of items such as bathroom suites are representations only and may not look like the real items. Made with Made Snappy 360.

**NEW!** This detached bungalow is located in a popular residential area within a small development close to local bus routes, schools, and amenities including a convenience store, Post Office, and takeaway outlets. The property benefits from gas central heating, UPVC double glazing, off-road parking, and easy-to-manage front and rear gardens. Accommodation comprises a central hallway with loft access, a bright lounge/dining room with modern fireplace and access to the rear garden, a fitted kitchen with integrated appliances and plumbing for a washing machine, two double bedrooms, and a wet room with fully tiled walls, shower area, WC, and hand basin. The property is well presented throughout and ready to move into.

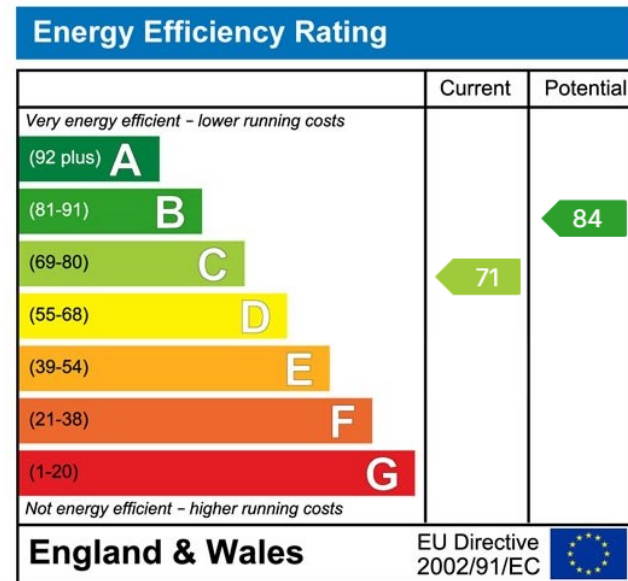

Visit us at  
[www.pooletownsend.co.uk](http://www.pooletownsend.co.uk)  
[enquiries@pooletownsend.co.uk](mailto:enquiries@pooletownsend.co.uk)

We are open  
 Monday – Friday 9.00 – 5.00  
 Saturday 9.00 – 1.00

Barrow 01229 811811  
 Ulverston 01229 588111  
 Grange 015395 33316  
 Kendal 01539 734455  
 Milnthorpe 015395 62044