



## 6 Timber Close, The Hart , Farnham, GU9 7HE

A charming and well presented 2 bedroom town centre cottage with a front and rear garden situated within walking distance of all the town's amenities. No onward chain.

**Price Guide £364,000**

## 6 Timber Close, The Hart , Farnham, GU9 7HE



- Character cottage
- Kitchen with door to rear garden
- Front and rear courtyard garden
- No onward chain
- Prime town centre location
- 2 bedrooms
- 3 garden store rooms
- Sitting/dining room with high ceiling, beams and fireplace
- Bathroom
- Stone's throw from the town's shops and restaurants



Directions

SAT NAV GU9 7HE





Floor Plan

GROUND FLOOR  
237 sq.ft. (22.0 sq.m.) approx.

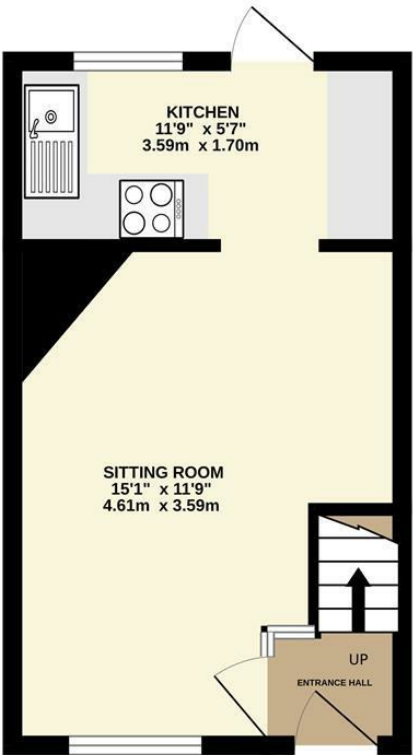

1ST FLOOR  
236 sq.ft. (22.0 sq.m.) approx.

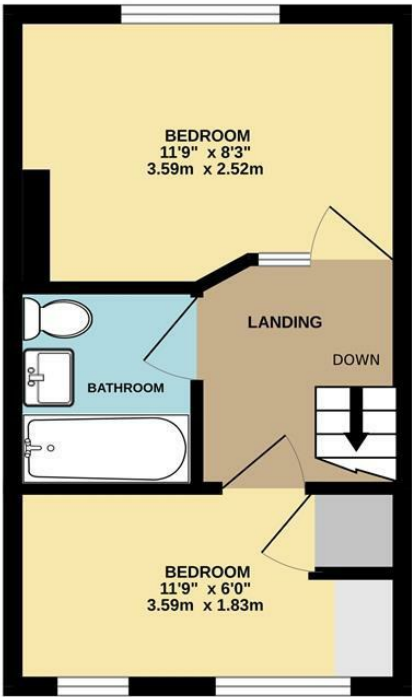

TOTAL FLOOR AREA : 473 sq.ft. (43.9 sq.m.) approx.

Whilst every attempt has been made to ensure the accuracy of the floorplan contained here, measurements of doors, windows, rooms and any other items are approximate and no responsibility is taken for any error, omission or mis-statement. This plan is for illustrative purposes only and should be used as such by any prospective purchaser. The services, systems and appliances shown have not been tested and no guarantee as to their operability or efficiency can be given.

Made with Metropix 6/2025



These particulars, whilst believed to be accurate are set out as a general outline only for guidance and do not constitute any part of an offer or contract. Intending purchasers should not rely on them as statements of representation of fact, but must satisfy themselves by inspection or otherwise as to their accuracy. No person in this firms employment has the authority to make or give any representation or warranty in respect of the property.

