

Frank Harris & Co.



Thomas More House, Barbican, EC2Y

£750,000

A lovely one bedroom flat with views over the gardens from the reception room, a desk area, a large open plan bespoke kitchen with corian worktops, Franke taps, Neff double oven, Siemens hob and custom-made cabinetry providing ample storage. There is an original Barbican bathroom with a custom-built mirror cabinet, and a bedroom at the rear of the property facing south.



Sympathetically renovated by PMI cabinets.

Barbican residents have use of their own communal gardens, parking for cars and bikes available below the building by separate negotiation along with storage cages. The Barbican Arts Centre runs walking tours of the estate (small fee applies), there are also three cinema screens a concert hall, library and several restaurants.

The property has the advantage of accessing the residents gardens via lift or just a short walk down the communal staircase.

Thomas More House was completed in 1973 and named after Sir Thomas More, statesmen, author and lawyer: imprisoned in the Tower of London, born in Cripplegate Parish.

Transport links from Thomas More House include Barbican, Farringdon (Elizabeth line, Circle and Metropolitan Line, Hammersmith and City, St. Paul's (Central Line)).

- One Bedroom Flat • Type 16 • Direct Garden Views •
- Extended lease • No Onward Chain • Contemporary Kitchen •



Frank Harris & Co.

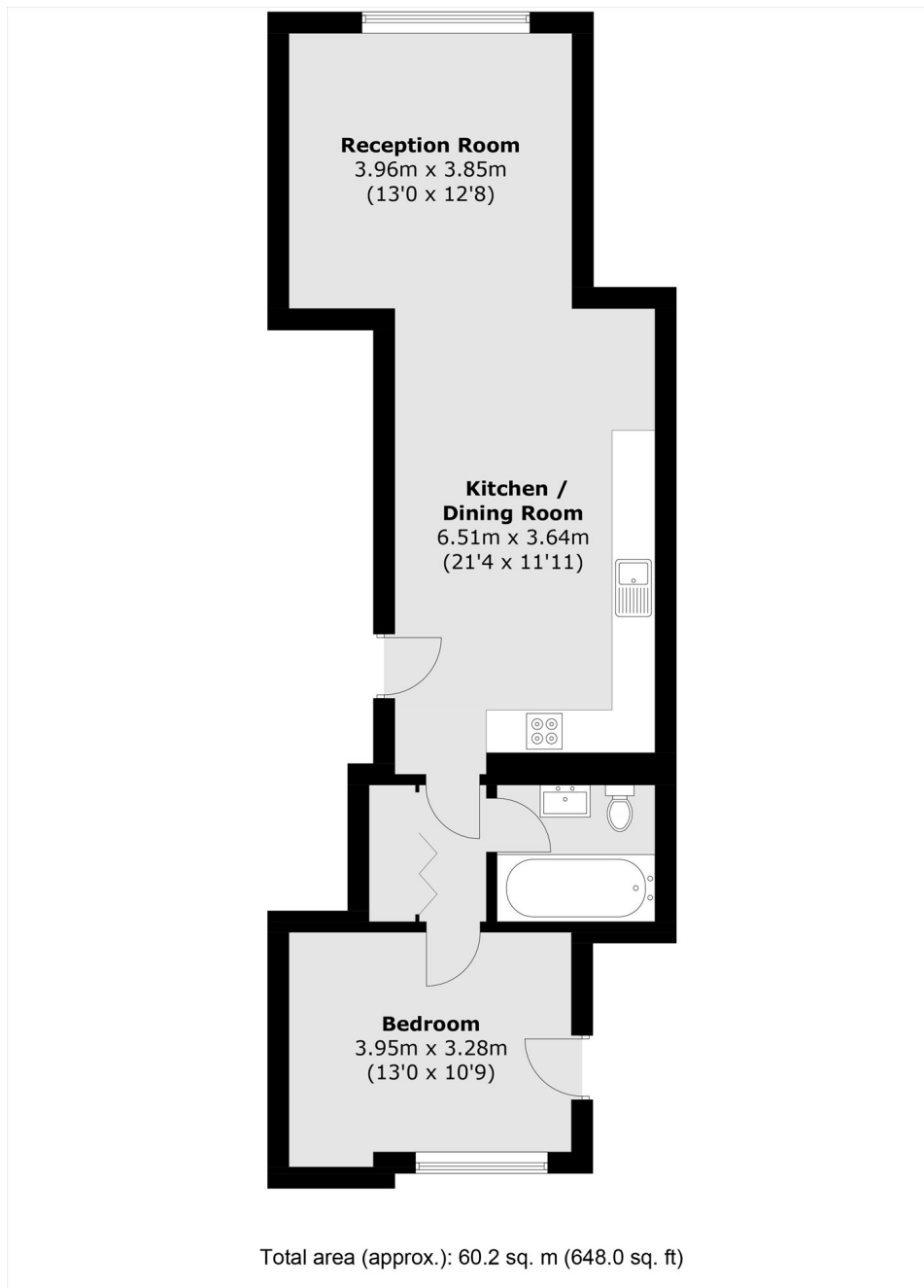

Frank Harris & Co. Barbican and City
87 Long Lane, London,
EC1A 9ET
020 7600 7000
citysales@frankharris.co.uk

Energy Rating: C. We aim to make our particulars both accurate and reliable. However they are not guaranteed; nor do they form part of an offer or contract. If you require clarification on any points then please contact us, especially if you're traveling some distance to view. Please note that appliances and heating systems have not been tested and therefore no warranties can be given as to their good working order.

