



Stonecroft, Entry Hill Drive, Bath, BA2 5NL

**A beautifully designed contemporary home designed by Forgeworks and interior designed by Richardson Studio. The house provides 2,430 sq. ft. of accommodation with breathtaking views to the west**

Entrance hall | Kitchen/dining room | Snug | Living room | Utility room | Cloakroom | Master bedroom with en suite dressing area and bathroom | Guest bedroom 2 with en suite shower room | 2 further double bedrooms | Family bathroom | Stylish garden studio | Landscaped gardens

**Situation**

Entry Hill Drive is a private road on the south side of Bath, just beyond Bear Flat and Entry Hill. Sitting within an elevated plot, the house enjoys fabulous views towards the City of Bath and countryside beyond. There is access to local amenities including the schools Paragon, Beechen Cliff, Hayesfield and Prior Park, local shopping and regular bus services, yet a peaceful location. There is a footpath from Entry Hill Drive which splits with pleasant walks to both Perrymead and Lyncombe Vale. The Two Tunnels cycle path is within 1km of the property with the cycle network connecting Midford and Bristol. Bath Spa station is approximately 1.5 miles away with trains to London Paddington (1hr 20m).

**Description**

Stonecroft is a superb modern house which provides a light-filled, energy-efficient home in this highly sought after residential area. For its bold, contemporary design, the house was awarded the RIBA South-West and Wessex Award in 2025. Clad almost entirely in western red cedar, Stonecroft's angular form emerges amid greenery. Its pitched volumes taper gently upward, while staggered front gardens echo the slope of the hill. Interconnected terraces wrap the house, offering quiet places to sit. Corten steel, railway sleepers and stone-filled gabions shape the outside spaces, with wild meadow grasses and trees softening the edges.

Entering the house via the front door you are greeted with a black panelled boot room ideal for muddy boots and there is also a utility. The hall then leads through to an amazing vaulted kitchen and dining area. Exposed glulam timber beams and textured wood fibre panels create a sense of warmth and softness.

An important aspect of the design was preserving the lines of sight from the kitchen to the snug, with its apple-green walls and matching bespoke storage. A large roof light above draws brightness into the room, and a French door opens to a separate section of terrace. Down three steps to the front of the building, a second living room opens west via full-height Internorm sliders to the main terrace - a space that blurs indoors and out. Engineered oak floors echo the beams above, while the reimagined fireplace is dressed in handmade tiles.

A double-height central corridor anchors the house, with yellow panelling to dado height. From this, four bedrooms unfold. The principal suite sits at the end, perfectly oriented to take in the view.



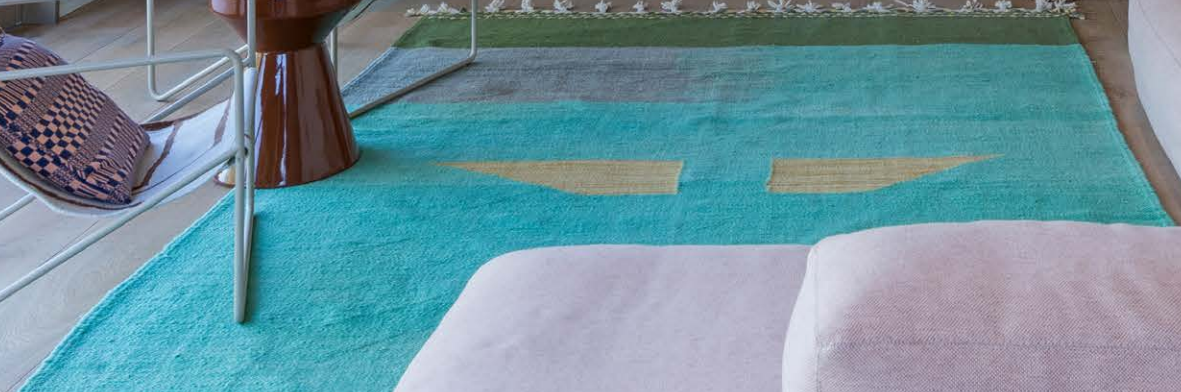



A pink-panelled headboard defines the space and conceals a walk-through dressing area that leads to an en suite with Lusso Stone tub, walk-in shower and encaustic cement tiles underfoot.

The three additional bedrooms are generously proportioned, each with bespoke fitted storage and its distinct colour scheme. One also has an en suite with pink tiles and a walk-in shower. A separate shared bathroom with a skylight and large tub completes the space.

#### Externally

A well-conceived garden studio is both functional and stylish. Bespoke joinery carves out storage space and dual-aspect glazing faces out to greenery, making the space wonderful for working or retreating to with a good book.

Terraced gardens beautifully compliment the design of the house. Corten and stone define the levels; grasses, cardoons, alliums, and verbena bring movement and colour throughout the seasons. The landscaping has been carefully designed to promote biodiversity and ecological sustainability, with bee-friendly flowers, layered planting and seasonal shrubs that support pollinators year-round. A wildflower meadow and grass borders in the front garden provide a habitat for insects and birds, while seedheads are left uncut through winter to provide natural shelter. Two lawns - one to the side, one behind - offer space for play or rest, and deep planters invite edible growing.

Terraces connect to every key room, offering moments of sun and/or shade, apt for hosting or for solitude.

#### General Information

Bath & North East Somerset Council. Council Tax Band G.

Mains electric and water. The house is fitted with an air-source heat pump, photovoltaic panels and underfloor heating that align with its environmentally conscious design.

Tenure: Long Leasehold - approx. 659 years remaining.



Approximate Floor Area = 225.8 sq m / 2430 sq ft  
 Outbuilding = 19.7 sq m / 212 sq ft  
 Total = 245.5 sq m / 2642 sq ft

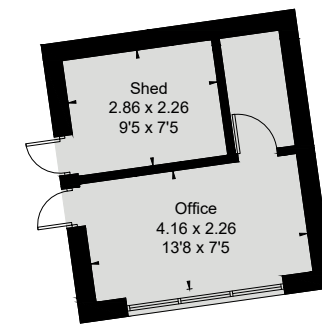

**Outbuilding**  
 (Not Shown In Actual  
 Location / Orientation)

Ground Floor

