



## Gatehouse Close, TW15

### £350,000

Offers over £350,000. A first floor, two bedroom, two bathroom modern apartment with allocated parking and a long lease in excess of 990 years. The property is smartly presented throughout and would make a perfect first home.

Beech House is in a wonderful location tucked off of Feltham Hill Road. Ashford High Street and the station which provides a direct service into central London are approximately a mile away.

### Features

- Modern Apartment
- First Floor
- Two Bedrooms
- Two Bathrooms
- Allocated Parking
- Long Lease

# Gatehouse Close, ASHFORD, TW15

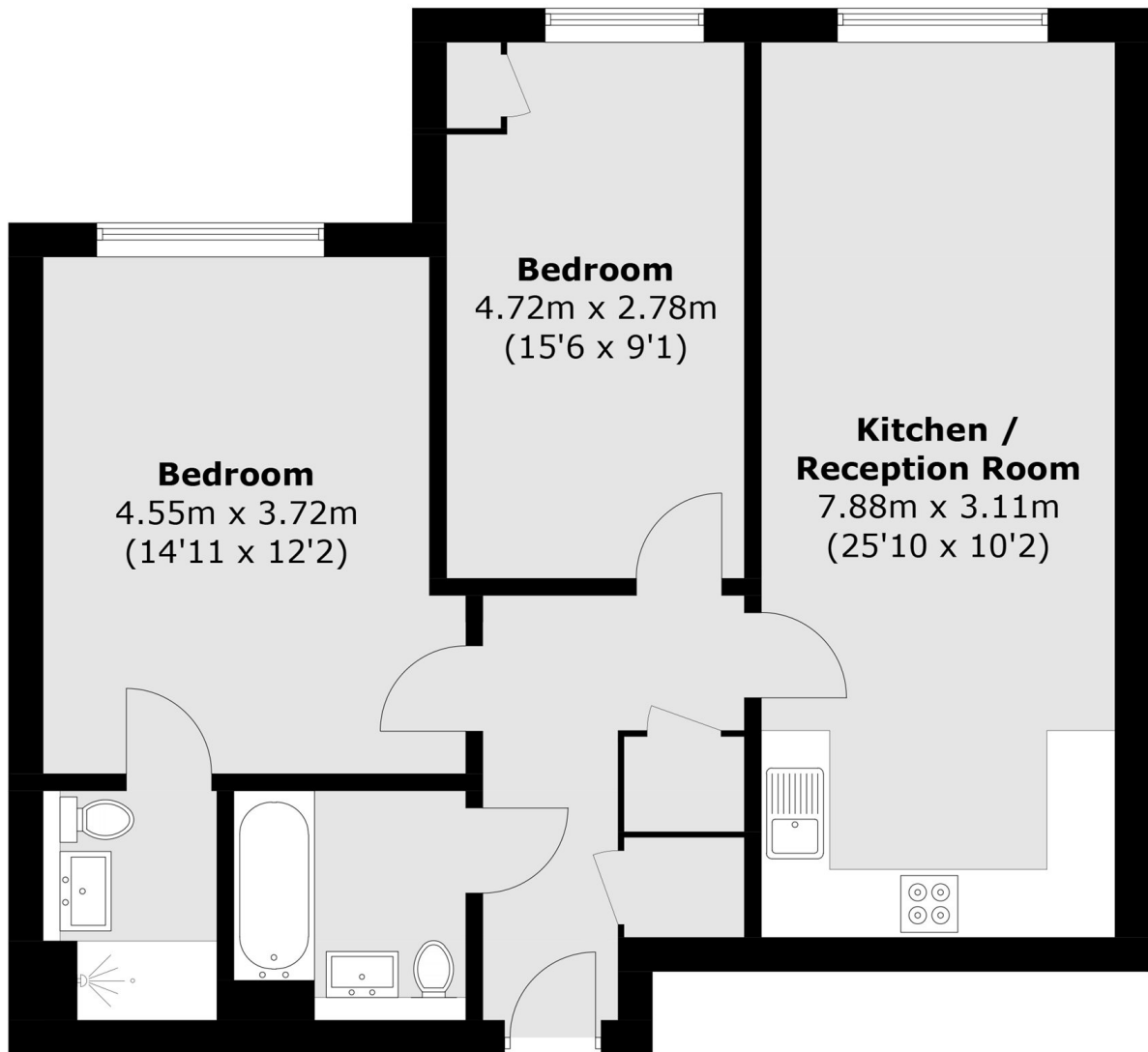

## First Floor

Total area (approx.): 71.4 sq. m (768.5 sq. ft)