



1 Bed  
Flat - Purpose Built  
located in

£900 Per month



TAYLOR  
MICHAEL

# York Avenue, Hove, BN3 1FH

Approximate Gross Internal Area = 19.2 sq m / 207 sq ft

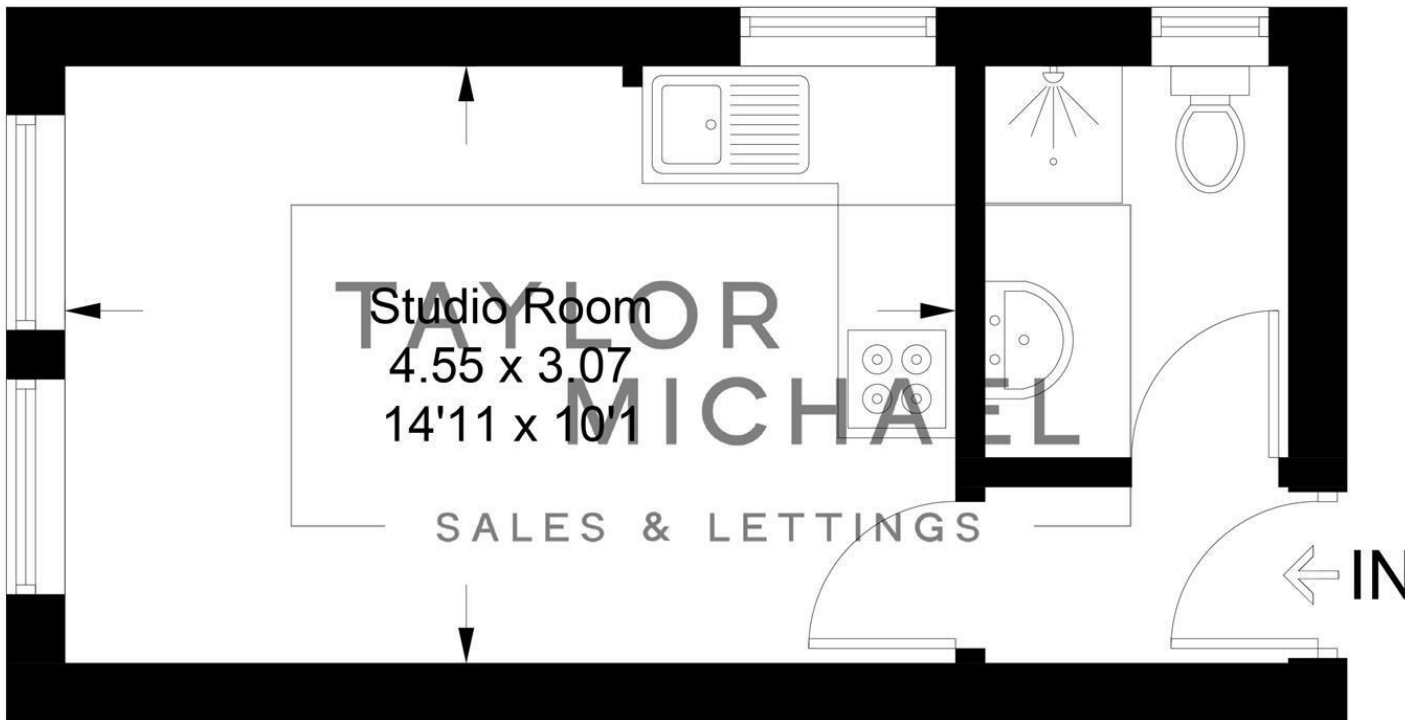

## First Floor

Illustration for identification purposes only, measurements are approximate, not to scale.  
Imageplansurveys @ 2026

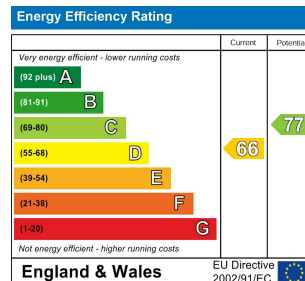

### DIRECTIONS

### CONTACT

62 Church Road  
Hove  
East Sussex  
BN3 2FP

E: [lettings@taylormichael.agency](mailto:lettings@taylormichael.agency)  
T: 01273 600100  
<https://taylormichael.agency/>

TAYLOR  
MICHAEL