

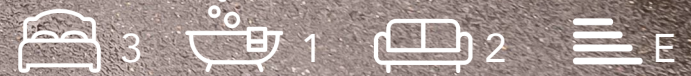

Grandison Road, Worcester Park, KT4 8LU  
Guide price £575,000

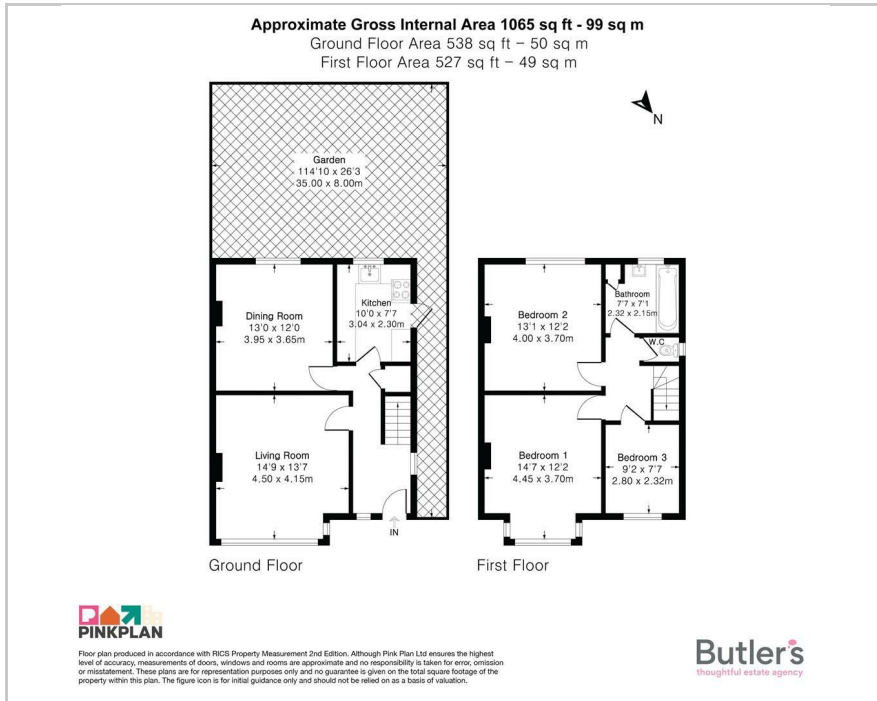

## Floor Plan



## Area Map

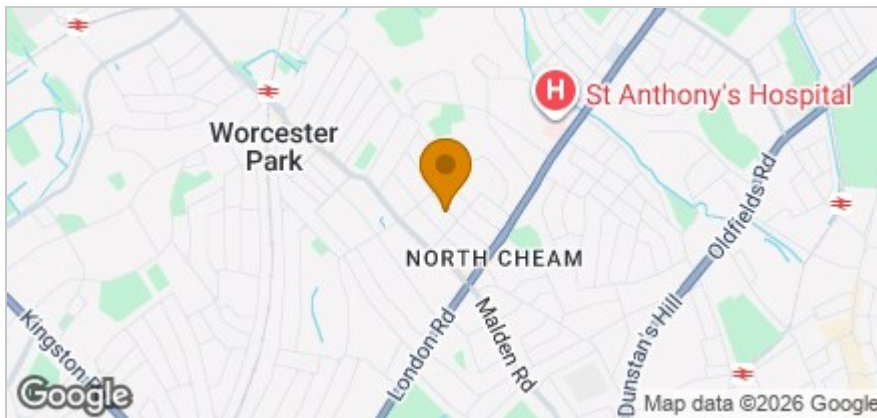

## Accommodation

- 3 Bedroom semi-detached house
- In need of refurbishment throughout
- No onward chain
- Fantastic and rare opportunity
- Spacious proportions with 2 reception rooms
- Huge potential to adapt & extend - subject to relevant consents
- Desirable & convenient residential road
- Large, level rear garden & driveway
- Close to excellent schooling, transport links & amenities

## Viewing

Please contact our Butler's Worcester Park Office on 020 39 069 169 if you wish to arrange a viewing appointment for this property or require further information.

## Energy Efficiency Graph

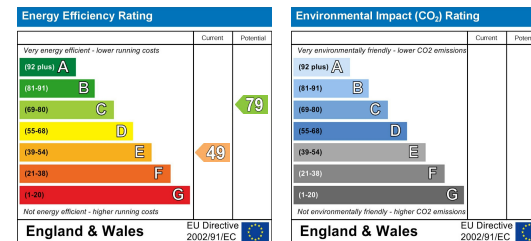

These particulars, whilst believed to be accurate are set out as a general outline only for guidance and do not constitute any part of an offer or contract. Intending purchasers should not rely on them as statements of representation of fact, but must satisfy themselves by inspection or otherwise as to their accuracy. No person in this firm's employment has the authority to make or give any representation or warranty in respect of the property.