



562, Oxford Street, Sheffield, S6 3FG

562, Oxford Street

Sheffield, S6 3FG

- EPC rating C72.
- 800 year lease from 1887 at an annual ground rent of £4.
- No onward chain.
- Conveniently situated to access Ponderosa Park and Crookes Valley Park.
- Perfect for First Time Buyers.
- On Street Parking (Permit Required).
- Rear Garden providing a perfect space to unwind.
- Excellent access to Sheffield City Centre, Universities and Hospitals.





Ground Floor
Approx. 22.8 sq. metres (245.0 sq. feet)

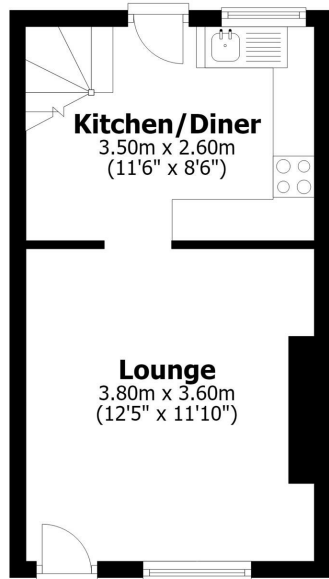

First Floor
Approx. 22.8 sq. metres (245.0 sq. feet)

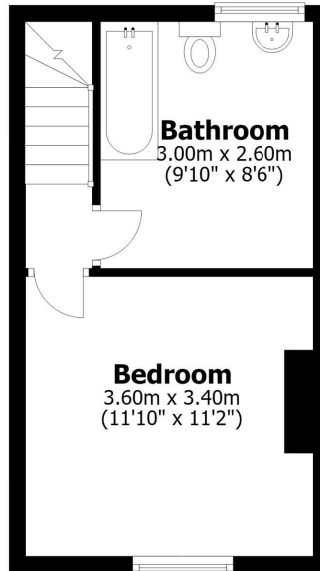

Total area: approx. 45.5 sq. metres (490.0 sq. feet)

All measurements are approximate
Yorkshire EPC & Floor Plans Ltd
Plan produced using PlanUp.

562 Oxford Street, Sheffield



Bakewell
3 Royal Oak Place
Matlock Street
Bakewell DE45 1HD
T: 01629 700699
E: bakewell@elr.co.uk

Banner Cross
888 Ecclesall Road
Banner Cross
Sheffield S11 8TP
T: 01142 683388
E: bannercross@elr.co.uk

Dore
33 Townhead Road
Sheffield
S17 3GD
T: 0114 2362420
E: dore@elr.co.uk

Hathersage
Main Road, Hathersage
Hope Valley
Derbyshire S32 1BB
T: 01433 651888
E: peakdistrict@elr.co.uk

Rotherham
149 Bawtry Road
Wickersley
Rotherham S66 2BW
T: 01709 917676
E: wickersley@elr.co.uk

**EADON
LOCKWOOD
& RIDDLE**
ESTD 1840