



MOVE INN ESTATES

MAKING THE RIGHT MOVE



Northfield Avenue

, London, W13 9QP

£2,000 Per Month



Floor Plan

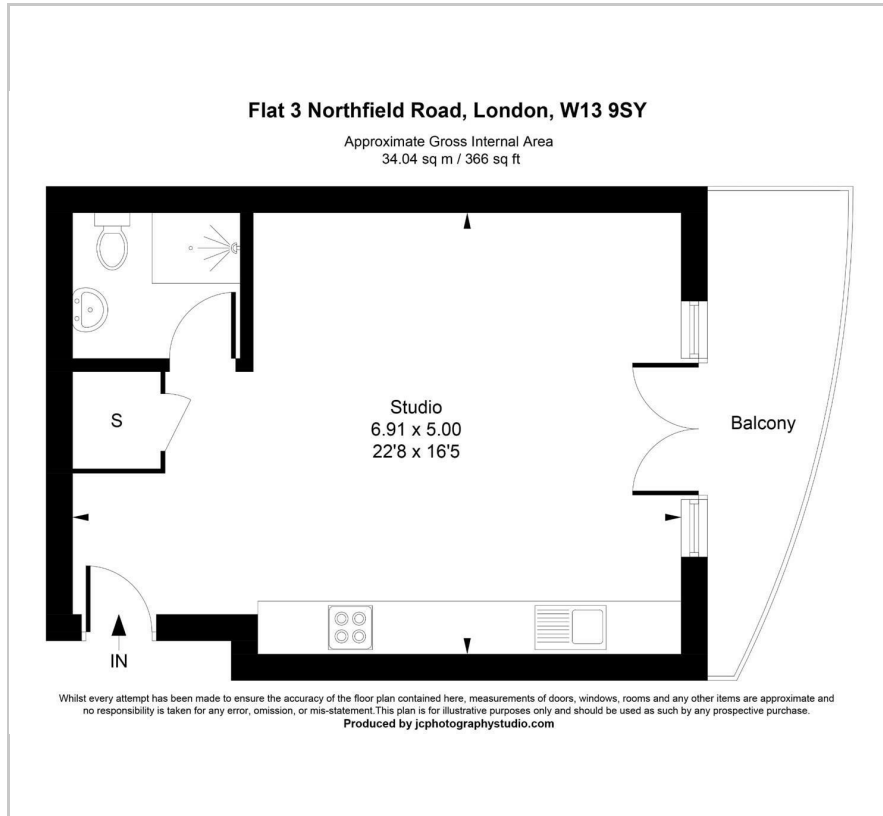

Area Map



Energy Efficiency Graph



Viewing

Please contact our Move Inn Estates - Sales Office on 0208 574 4966 if you wish to arrange a viewing appointment for this property or require further information.



A stunning and contemporary studio apartment situated on the sought-after Northfields Avenue, offering stylish living in a highly convenient West London location.

This beautifully finished property features a well-designed open-plan living and sleeping area, complemented by a sleek modern bathroom. The bright and spacious layout is ideal for both relaxing and entertaining, while the high-specification kitchen comes complete with integrated appliances and ample storage throughout. A private balcony further enhances the space, providing pleasant outlooks.

Offered unfurnished, this studio presents a fantastic opportunity for tenants to personalise their living space while enjoying modern fixtures and fittings throughout.

Ideally located, the property is within easy reach of a wide range of local amenities including shops, cafés, restaurants, and supermarkets along Northfields Avenue and nearby Ealing Broadway. Excellent transport links are close by, with Northfields Station (Piccadilly Line) just a short walk away, providing direct access into Central London and Heathrow Airport. Numerous bus routes also serve the area, offering further connectivity across West London.

Additional benefits include proximity to green spaces such as Lammas Park and Walpole Park, making it perfect for professionals or individuals seeking a vibrant yet well-connected location.



These particulars, whilst believed to be accurate are set out as a general outline only for guidance and do not constitute any part of an offer or contract. Intending purchasers should not rely on them as statements of representation of fact, but must satisfy themselves by inspection or otherwise as to their accuracy. No person in this firm's employment has the authority to make or give any representation or warranty in respect of the property.

46 Vicarage Farm Road, Hounslow, Middlesex, TW5 0AB

Tel: 0208 574 4966 Email: info@moveinnestates.co.uk www.moveinnestates.co.uk