



55 Broadside Chalet Park

, Stalham, NR12 9PN

£27,500



55 Broadside Chalet

, Stalham, NR12 9PN

Aldreds are pleased to offer two bedroom holiday chalet, situated in the sought after Broadside Chalet Park. This well located chalet offers accommodation including an open plan living area/kitchen, two bedrooms and a bathroom. The chalet offers uPVC sealed unit double glazed windows and is located in a pleasant position facing a communal grassed area.

The Broadside Chalet Park offers on-site clubhouse/restaurant, outdoor swimming pool (at extra annual cost) and children's play area. The site offers well maintained lawned communal grounds and parking. Early internal viewing is highly recommended to appreciate.

Lounge/Kitchen

14'9" max 7'6" min x 13'5" max 8'11" min (4.5 max 2.31 min x 4.1 max 2.72 min)

Door to front, double glazed window to front aspect, double glazed window to rear aspect, kitchen units, electric cooker point

Bedroom 1

8'7" x 6'10" (2.63 x 2.1)

Airing cupboard, double glazed window to rear aspect

Bedroom 2

8'7" x 6'6" (2.63 x 2)

Storage cupboard, double glazed window to front aspect

Bathroom

Panel bath, hand basin, low level WC, opaque double glazed window to rear aspect, part tiled walls

Outside

The chalet occupies a pleasant position facing a communal grass area,, Communal parking





Tenure

Leasehold - the remainder of a 99 year lease which began in 1987. The service charges for 2026 are a total of £1,914.61 including VAT. Included in this figure is an additional (optional) charge of £250 plus VAT for use of the swimming pool.

The chalet site opens fully from 1st March to 31st October. Out of season, you are able to use your chalet from Friday lunchtime to Monday lunchtime.

Services

Mains water, electric and drainage.

Council Tax

Band A

Location

Stalham is a Broadland town with a full range of facilities which include a variety of shops, post office, health centre, schools and a supermarket. Only a few miles from the coast, the town is handy for those looking to take advantage of the Broads network and also it also has a regular bus service to Great Yarmouth and and the fine city of Norwich.

Reference

S10058



Floor Plan

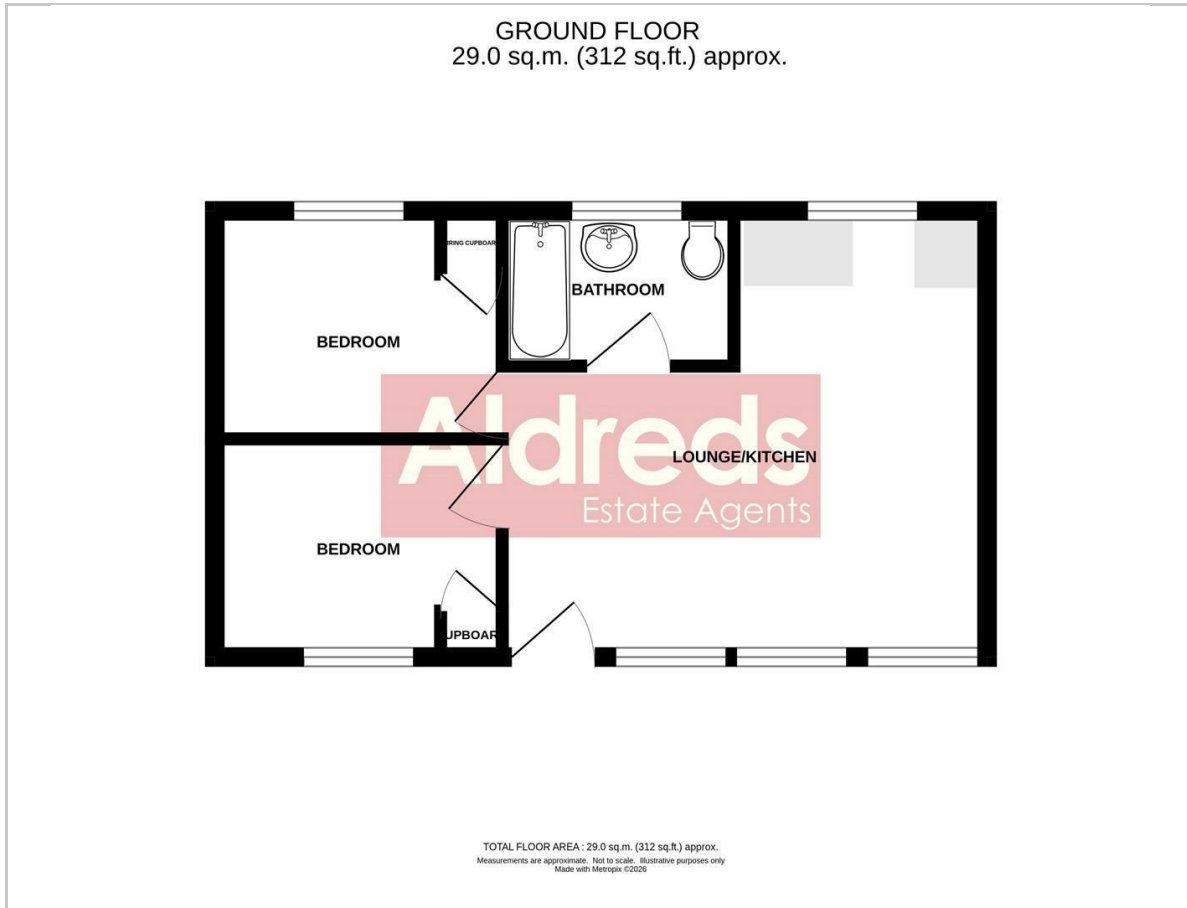

Area Map



Energy Efficiency Graph

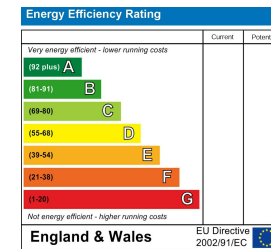

Viewing

Please contact our Aldreds Stalham Office on 01692 581089 if you wish to arrange a viewing appointment for this property or require further information.

Disclaimer

These particulars are issued on an understanding that all negotiations shall be conducted through Messrs. Aldreds. Please note: Messrs. Aldreds for themselves and for the vendors or lessors of this property whose agents they are given notice that: 1. Particulars are set out as a general outline only for guidance of intending purchasers or lessees, and do not constitute nor constitute part of, an offer or contract. 2. All descriptions, dimensions, references to condition and necessary permissions for use and occupation, and other details are given without responsibility and any intending purchasers or tenants should not rely on them as statements or representations of fact but must satisfy themselves by inspection or otherwise as to the correctness of each of them. 3. No person in the employment of Messrs. Aldreds has any authority to make or give any representation or warranty whatever in relation to this property. 4. If you are proposing to visit the property and are travelling some distance please check with Aldreds on the issue of availability prior to travelling. 5. Aldreds Property Consultants and associated services may offer additional services to the prospective purchaser for which they will be entitled to receive a commission.

Aldreds are pleased to be working with Mortgage Advice Bureau. They're an award-winning mortgage broker with over 1,400 advisers across the UK, and have access to over 12,000 mortgage products from over 90 lenders. Aldreds Estate Agents Ltd receive a commission of £200 on each completed case. Your home may be repossessed if you do not keep up repayments on your mortgage. There may be a fee for mortgage advice. The actual amount you pay will depend upon your circumstances. The fee is up to 1%, but a typical fee is 0.3% of the amount borrowed. Mortgage Advice Bureau is a trading name of Mortgage Seeker Limited which is an appointed representative of Mortgage Advice Bureau Limited and Mortgage Advice Bureau (Derby) Limited which are authorised and regulated by the Financial Conduct Authority. Mortgage Seeker Limited Registered Office: Lovewell Blake, Sixty Six North Quay, Great Yarmouth, Norfolk, NR30 1HE. Registered in England Number: 03721415. 6. Potential purchasers should check with their providers that the broadband and mobile phone coverage they would require is available.

55 High Street, Stalham, Norfolk, NR12 9AH

Tel: 01692 581089 Email: stalham@aldreds.co.uk <https://www.aldreds.co.uk/>

Registered in England Reg. No. 08945751 Registered Office: 17 Hall Quay, Great Yarmouth, Norfolk NR30 1HJ

Directors: Mark Duffield B.S.c. FRICS. Dan Crawley MNAEA Paul Lambert MNAEA