



Key Features

- ◆ Two-bedroom, first-floor flat
- ◆ Popular Roselands area of Eastbourne
- ◆ Surrounded by local shops and cafes
- ◆ Walking distance from parks and seafront
- ◆ Easy access to train station and town centre
- ◆ EPC rating C



Seaside, Roselands, Eastbourne

£1,050 PCM



Northwood are delighted to welcome to market this recently redecorated, two-bedroom, first-floor apartment in a purpose-built block in the Roselands area of Eastbourne.

Accommodation comprises: living room, modern fitted kitchen, two double bedrooms and bathroom with shower over bath.

Further benefits include gas central heating, double-glazing and secure entry-phone.





Located in the Roselands area of Eastbourne, surrounded by local shops and cafes, only a few minutes walk from the seafront and local parks and on major bus routes for easy access to the town centre and train station, this bright, spacious apartment is ideally placed for making the most of life on the Sunshine Coast.

Please view our immersive virtual tour to fully appreciate this fantastic property:

<https://tour.giraffe360.com/f2bfb2f231524448a26ae64731973e76>

Mobile Phone Coverage and Broadband speeds can be checked on the Ofcom website:

<https://checker.ofcom.org.uk/>

Council Tax Band B: £2064

Holding Deposit: £242.30 (equivalent to one week's rent)

Full Deposit: £1211.53 (holding deposit + equivalent of four weeks' rent)

1st month's rent + Full Deposit: £2261.53

Minimum Tenancy: 6 months

Total household income must exceed £31,500.00 to be considered for this property.

This property is managed directly by the landlord.

PLEASE NOTE: Electrical works are ongoing in this property, the chandelier lights are being replaced with safer pendant lights.



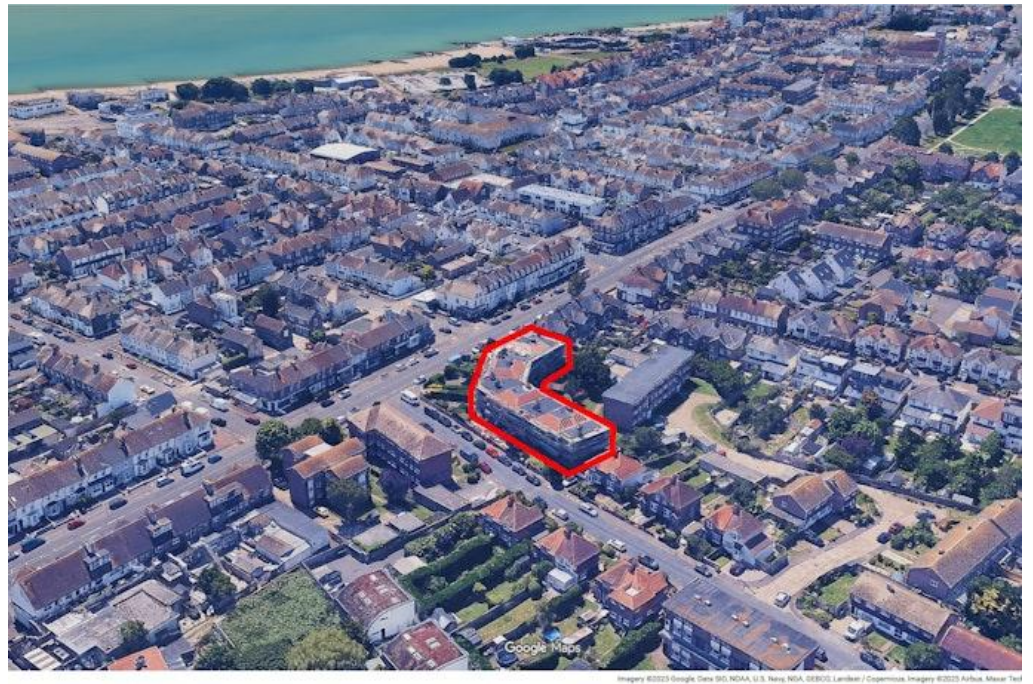

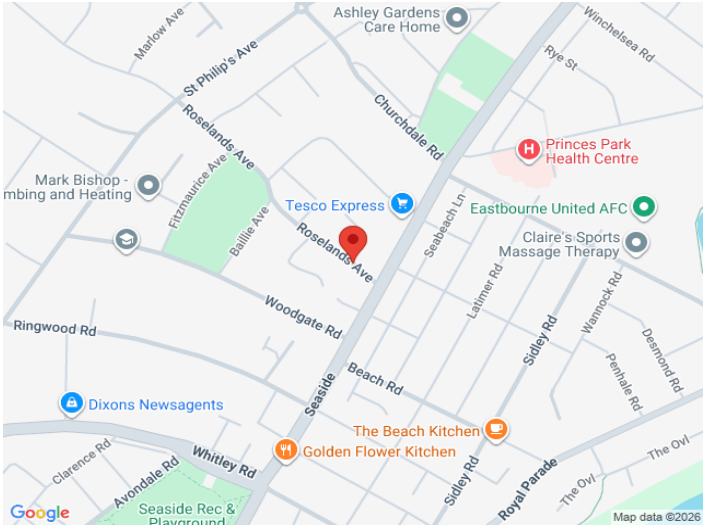
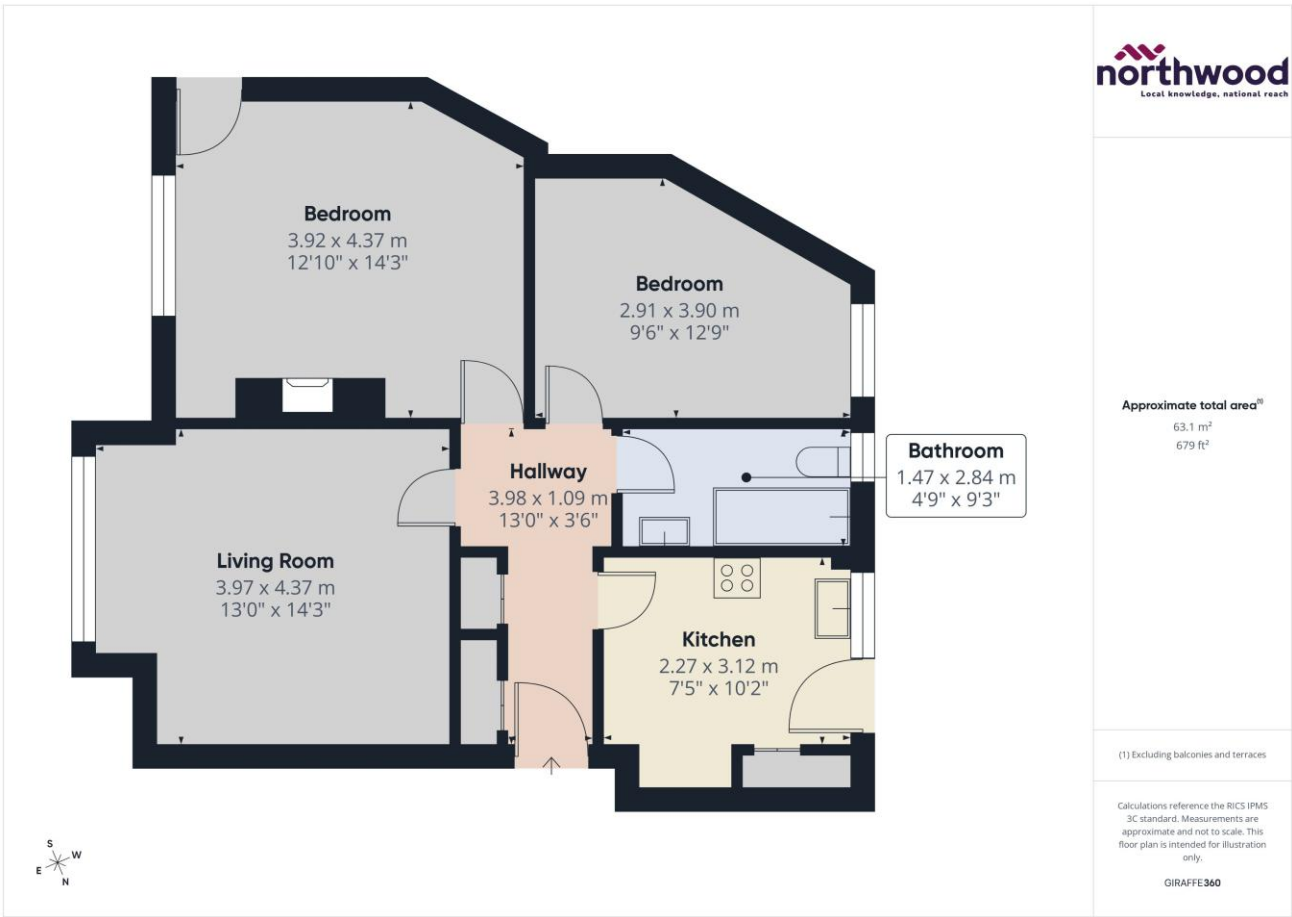

SEE MORE ONLINE

Northwood
81-83 South Street
Eastbourne
BN21 4LR
01323 744544
eastbourne@northwooduk.com

northwood
Local knowledge, national reach