



# RIDGEWAY

## RESIDENTIAL SERVICES



### 7 Waterbridge court

, Lymm, WA13 0EL

Offers In The Region Of £165,000



## Floor Plan

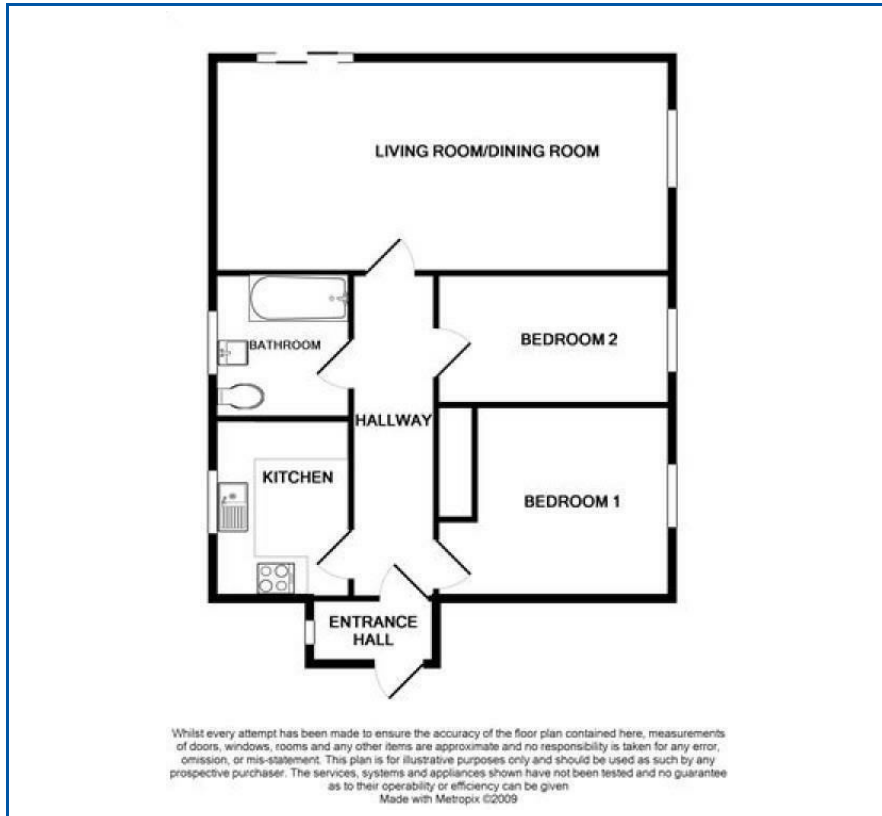

## Area Map



## Energy Efficiency Graph

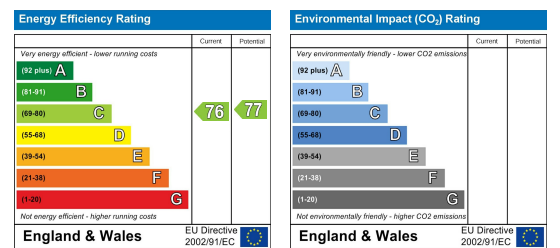

## Viewing

Please contact us on 01925 756931 if you wish to arrange a viewing appointment for this property or require further information.

- Well Proportioned Apartment
- Spacious Lounge/Dining Room
- Newly Refurbished Kitchen
- Three Piece Bathroom Suite
- Allocated Parking Space
- Communal Gardens
- Bridgewater Canal Views
- No Onward Chain

Located in the charming area of Thornley Close area of Lymm, this delightful second-floor apartment offers a perfect blend of comfort and convenience. The property benefits from a tranquil setting while still being conveniently close to local amenities, including shops, schools, and parks. The surrounding area is known for its picturesque landscapes and community spirit, making it an ideal place to call home.

This second-floor apartment is not just a property; it is a lifestyle choice that offers comfort, convenience, and a sense of belonging.



These particulars, whilst believed to be accurate are set out as a general outline only for guidance and do not constitute any part of an offer or contract. Intending purchasers should not rely on them as statements of representation of fact, but must satisfy themselves by inspection or otherwise as to their accuracy. No person in this firm's employment has the authority to make or give any representation or warranty in respect of the property.