



Bridge Street, Billingham
Offers in Excess of £145,000



2 1 1

Key Features

- Immaculate Terraced House
- Two Double Bedrooms
- Renovated Throughout
- Open Plan Kitchen Diner
- South West Facing Rear Garden
- Popular Village Location
- EPC rating E
- Current Council Tax Band A





Offered for sale with No Onward Chain, this fully renovated and immaculately presented Two Double Bedroom Terraced Home is situated within the popular village of Billingham and beautifully combines modern living with original character features throughout. The property enjoys a warm and cosy feel from the moment you enter, with an entrance area providing stairs to the first floor and access into the comfortable lounge featuring a charming fireplace. To the rear is a superb open-plan kitchen/diner with exposed brickwork adding character and warmth, alongside a separate utility area providing additional practicality.

Upstairs, the property offers two well-proportioned double bedrooms and a stylish modern family bathroom, again enhanced by exposed brickwork details. Externally, the home continues to impress with a covered outdoor seating area leading onto a generous patio, two useful adjoining outbuildings and a timber greenhouse, all enjoying a private South-West Facing Rear Garden ideal for entertaining and enjoying the afternoon and evening sun.

Billingham is a well-served Lincolnshire village offering a range of local amenities including shops, pubs, takeaways, primary schooling and everyday conveniences, whilst also providing excellent access to

nearby towns including Sleaford, Lincoln and Boston. The village is popular with a wide range of buyers seeking a balance of rural living and practical commuting links. Viewing is highly recommended to fully appreciate the quality, charm and lifestyle this home has to offer.

Entrance Hall

Lounge

3.66m x 3.61m (12'0" x 11'10")

Kitchen Diner

3.73m x 4.62m (12'2" x 15'2")

Utility Area

1.83m x 1.22m (6'0" x 4'0")

Landing

Bedroom One

3.66m x 2.36m (12'0" x 7'8")

Bedroom Two

2.44m x 2.31m (8'0" x 7'7")

Bathroom

2.46m x 2.26m (8'1" x 7'5")

Agents Note

These are draft particulars awaiting vendor approval.

These particulars are issued in good faith but do not constitute representations of fact or form part of any offer or contract. The matters referred to in these particulars should be independently verified by prospective buyers or tenants. Neither Newton Fallowell nor any of its employees or agents has any authority to make or give any representation or warranty whatever in relation to this property.

Financial Services

As part of our continued commitment to providing the best advice to all our clients we work closely with Mortgage Advice Bureau; part of our guaranteed commitment to our vendors is to establish the financial position of any offer received on their home. Whilst we offer FREE mortgage advice from any stage of the buying or selling process, we operate a mandatory qualification process on all offers prior to submission of any offer to our vendors. The mortgage advice bureau is regulated by the financial ombudsman and operate on an independent basis within our premises at 27 Southgate, Sleaford, NG34 7SY.





Floorplan

Ground Floor

Approx. 34.1 sq. metres (366.8 sq. feet)

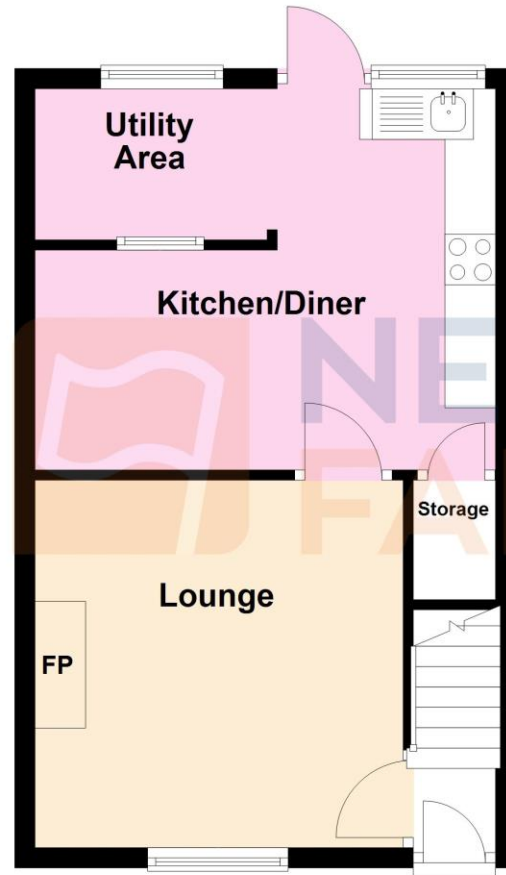

First Floor

Approx. 26.5 sq. metres (285.5 sq. feet)

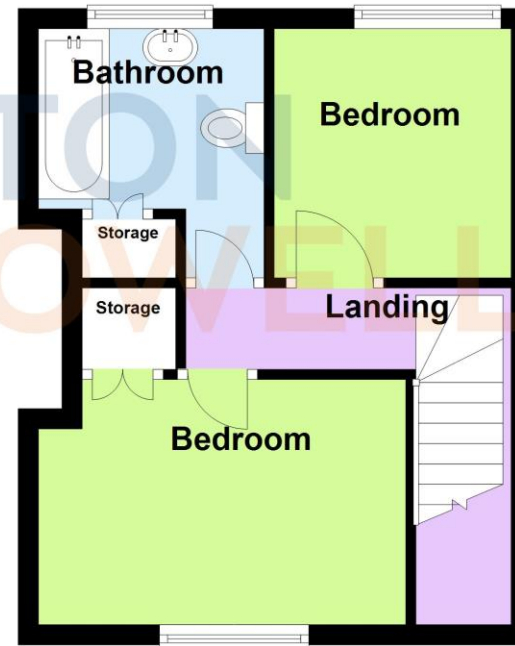

Total area: approx. 60.6 sq. metres (652.3 sq. feet)

5 Bridge Street, Billingham



Newton Fallowell Sleaford

01529 309 209

sleaford@newtonfallowell.co.uk