



## David Davies House offers in excess of £120,000

- RETIREMENT APARTMENT - \*OVER 55\*
- LIFT AVAILABLE
- 2 DOUBLE BEDROOMS
- RESIDENTS PARKING - COMMUNAL GARDEN
- TOWN CENTRE LOCATION - CLOSE TO LOCAL AMENITIES & TRANSPORT LINKS
- EPC Rating: C





## About the property

RETIREMENT APARTMENT - LIFT - This second floor apartment comprises of a communal hallway, inner hallway, lounge, kitchen, two bedrooms and a shower room. Benefitting from double glazing, gas central heating, communal Laundry, garden and resident parking.

## Accommodation

### Entrance Hall

Carpet, fitted storage cupboard.

### Lounge

11' 8" x 9' 7" ( 3.56m x 2.92m )

Carpeted flooring, window to rear.

### Kitchen

10' 6" max x 6' 6" max ( 3.20m max x 1.98m max )

Vinyl flooring, matching wall and base cupboard with complimentary worktops, space for appliances, window to rear.

### Bedroom One

12' 1" max x 12' 9" max ( 3.68m max x 3.89m max )

Carpet, window to rear.



## Bedroom Two

12' 8" max x 8' 8" max ( 3.86m max x 2.64m max )

Carpet, window to rear.

## Shower Room

Comprising shower, wash hand basin and W.C., vinyl flooring.

## Agents Note

The sale of this property is subject to receipt of Grant of Probate. Please obtain an update from the branch with regards to the potential timeframes involved.

01446 733224

barry@peteralan.co.uk

## Floorplan

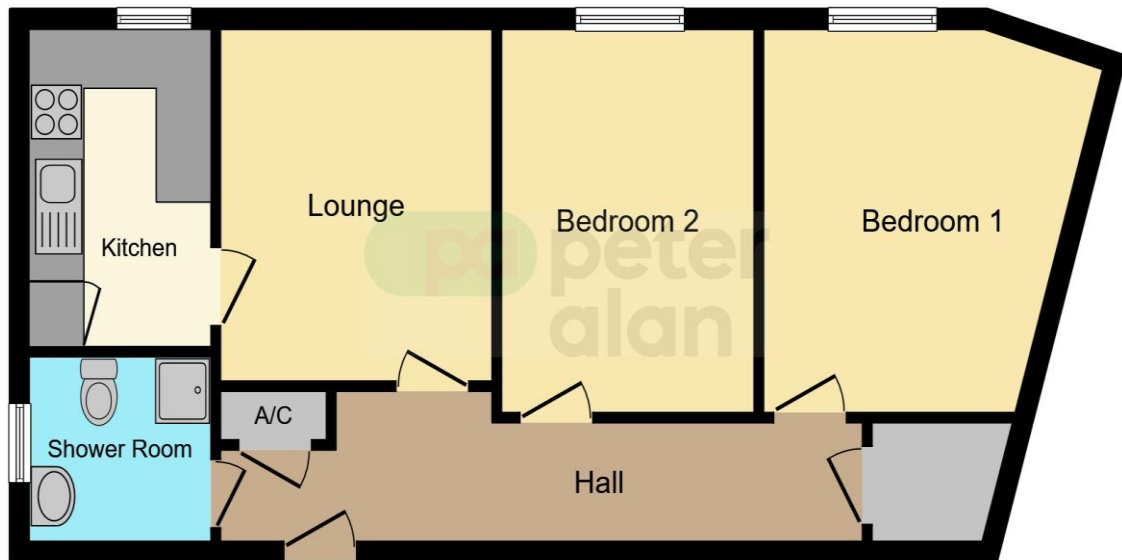

This floor plan is for illustrative purposes only. It is not drawn to scale. Any measurements, floor areas (including any total floor area), openings and orientation are approximate. No details are guaranteed, they cannot be relied upon for any purpose and they do not form part of any agreement. No liability is taken for any error, omission or misstatement. A party must rely upon its own inspection(s). Powered by [www.focalagent.com](http://www.focalagent.com)

## Important Information

Note while we endeavour to make our sales details accurate and reliable, if there is any point which is of particular interest to you, please contact the office and we will be pleased to confirm the position for you. We have not personally tested any apparatus, equipment, fixtures, fittings or services and cannot verify they are in working order or fit for their purposes. Nothing in these particulars is intended to indicate that carpets or curtains, furnishings or fittings, electrical goods (whether wired or not). Gas fires or light fittings or any other fixtures not expressly included form part of the property offered for sale. This computer generated Floorplan, if applicable, is intended as a general guide to the layout and design of the property. It is not to scale and should not be relied upon for dimensions. Tenure: We cannot confirm the tenure of the property as we have not had access to the legal documents. The buyer is advised to obtain verification from their solicitor or surveyor.

Peter Alan Limited is registered in England and Wales under company number 2073153, Registered Office is Cumbria House, 16-20 Hockliffe Street, Leighton Buzzard, Bedfordshire, LU7 1GN. VAT Registration Number is 500 2481 05. For activities relating to regulated mortgages and non-investment insurance contracts, Peter Alan Limited is an appointed representative of Connells Limited which is authorised and regulated by the Financial Conduct Authority. Connells Limited's Financial Services Register number is 302221. Most buy-to-let