



24a Draper Road



# 24a Draper Road

Christchurch, BH23 3AP

£185,000

**FIRST FLOOR FLAT – IDEAL FIRST-TIME BUY OR BUY-TO-LET INVESTMENT** This charming two-bedroom first-floor flat presents a fantastic opportunity for first-time buyers or investors. The property offers a spacious kitchen/diner, a family bathroom, and two well-proportioned bedrooms, all benefiting from double glazing and gas central heating throughout. Externally, there is an enclosed rear garden, ideal for outdoor relaxation or entertaining, and a driveway providing off-street parking for one vehicle. The flat is conveniently located within walking distance of local amenities, shops, and transport links, making it both practical and accessible.



**Entrance Porch**

**Kitchen/Diner 14' 0" x 11' 6" (4.26m x 3.50m)**

**Bedroom 1 11' 9" x 10' 2" (3.58m x 3.10m)**

**Bedroom 2 9' 6" x 8' 11" (2.89m x 2.72m)**

**Family Bathroom 6' 6" x 5' 8" (1.98m x 1.73m)**

**Rear Garden**



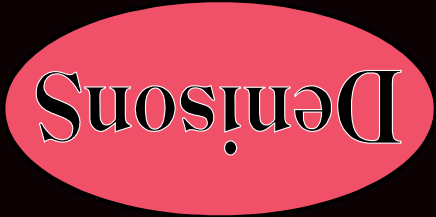

Denisons for themselves and for the Vendors or lessors of this property, whose Agents they are, give notice that these particulars are produced in good faith, are set out as a general guide only and do not constitute any part of a Contract. No person in the employment of Denisons has any authority to make or give any representation or warranty whatever in relation to this property.

Christchurch  
12 Castle Street, Christchurch BH23 1DT  
01202 484748  
christchurch@denisons.com

Mayfair  
Cashel House, London, W1U 3JT  
0870 112 7099  
mayfair@denisons.com  
www.denisons.com

## 24A Draper Road

Approximate Gross Internal Area  
484 sq ft - 45 sq m

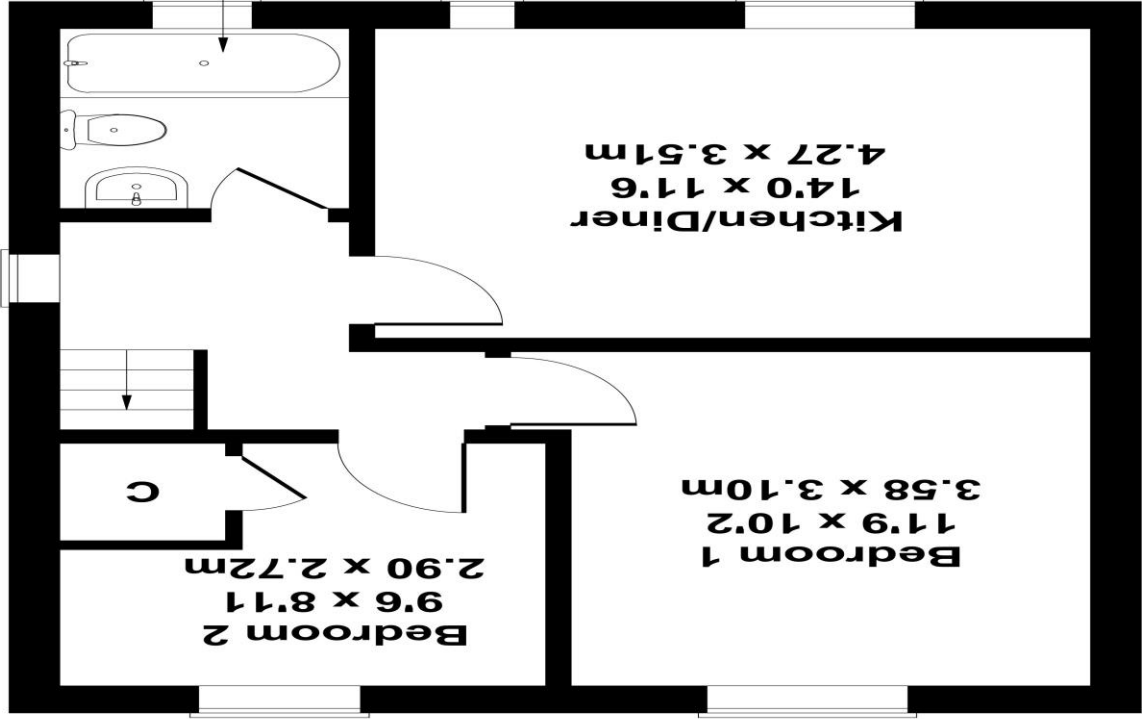

### FIRST FLOOR

Not to Scale. Produced by The Plan Portal 2026  
For Illustrative Purposes Only.

Score	Energy rating	Current	Potential
92+	A		
81-91	B		
69-80	C		
55-68	D		
39-54	E		
21-38	F		
1-20	G		