



Holley Road, W3

£300,000

Situated on Holley Road, a first-floor one-bedroom apartment would be perfect for first-time buyers and investors. The property features separate kitchen and a generous reception room flooded with natural light and storage throughout. Residents benefit from allocated parking and access to maintained communal gardens

Holley Road is ideally positioned for access to the restaurants and shops, Askew village and Turnham Green as well as the Superloop bus line and Westfield shopping centre. Acton Central Station (0.6 miles) Overground line, Turnham Green Station 0.7 miles, Piccadilly and District Line. Stamford Brook Station 0.7 miles

Features

- One Double Bedroom
- Purpose Built
- Long Lease
- Allocated Parking Space
- Communal Grounds
- No Onward Chain

Holley Road,
London, W3

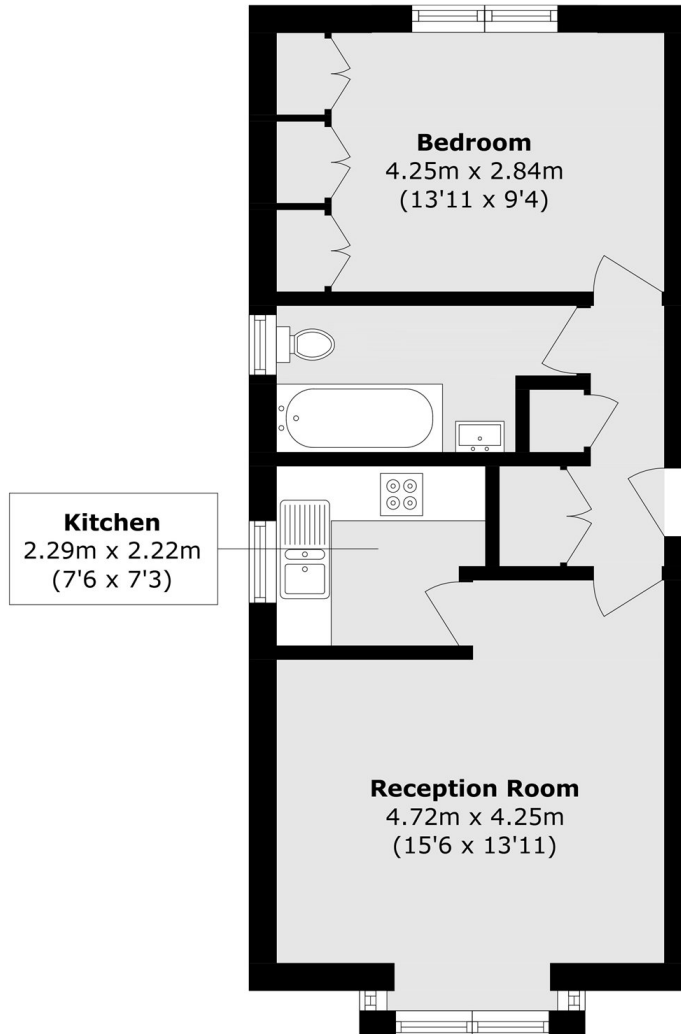

Total area (approx.): 44.3 sq. m (476.8 sq. ft)