



Woodcote Hall, Woodcote Road, Epsom

In Excess of £280,000



Woodcote Hall

Woodcote Road, Epsom

Immaculate Grade II listed one-bedroom apartment with modern kitchen, double bedroom with dressing area, bathroom with underfloor heating, parking, and communal gardens. Close to town centre and station. Call today to schedule your viewing!

Council Tax band: C

Tenure: Share of Freehold

EPC Energy Efficiency Rating: C

EPC Environmental Impact Rating: C

- Grade II Listed Conversion
- First Floor
- Bright & Spacious Reception
- Modern Kitchen
- Contemporary Bathroom With Underfloor Heating
- Generous Bedroom With Dressing Area
- Allocated Parking
- Well Maintained Communal Garden
- Short Walk To Town Centre & Station



Forming part of an impressive Grade II listed conversion, this beautifully presented one-bedroom first-floor apartment seamlessly combines period charm with contemporary living.

The property boasts a bright and spacious reception room, enhanced by high ceilings and large sash windows that allow an abundance of natural light to flood the space. The modern kitchen has been thoughtfully designed with sleek cabinetry, integrated appliances, and generous worktop space, ideal for everyday living.

The well-proportioned double bedroom benefits from a dedicated dressing area, offering both practicality and stylish storage solutions. Completing the accommodation is a contemporary bathroom finished to a high specification, featuring luxurious underfloor heating. Throughout, the apartment is immaculately maintained and intelligently laid out, creating a warm and inviting home.

Further benefits include allocated parking for added convenience, along with beautifully kept communal gardens that provide a tranquil setting for residents to enjoy.

Ideally located within easy walking distance of the town centre, station, shops, and restaurants, this superb property offers an excellent balance of character, comfort, and convenience, making it perfectly suited to commuters and those looking to enjoy everything the local area has to offer.

Woodcote Road, Epsom, KT18

Approximate Area = 586 sq ft / 54.4 sq m

For identification only - Not to scale

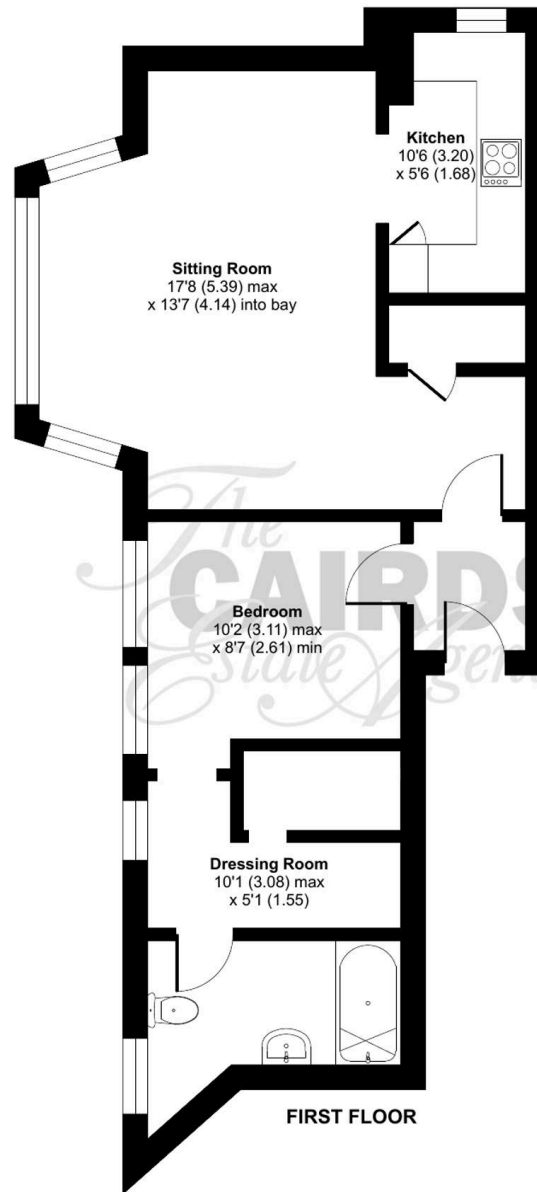

FIRST FLOOR





Cairds The Estate Agents

Cairds The Estate Agents, 128-130 High Street - KT19 8BT

01372 743033 • homes@cairds.co.uk • www.cairds.co.uk