



Carrington House

Hertford Street, Mayfair, W1J 7RG

£600 Per Week

This is a great sized well presented one bedroom apartment on the RAISED GROUND FLOOR of a much sought after portered building in the heart of Mayfair. Close to Hyde Park and more.

This fine property comprises of:- Entrance hallway, reception room with high ceiling, separate fitted kitchen with window, double bedroom with fitted wardrobe and large window, shower/WC.

The Building benefits from having:- 24 hour porter, rental includes the cost of communal heating and hot water. Flat has wood flooring thru out.

Located conveniently for Hyde Park, Park Lane, Curzon Street and Green Park.

Available NOW for rental. BUILDING HAS NO PETS POLICY.

- One Double Bedroom Apt
- Raised Ground Floor
- Wood flooring
- Separate kitchen
- Include heating & HW
- 24 Hour Porter
- Close to Hyde Park & Green Park underground stations

Viewing

Please contact our Messila Residential Office on 020 7586 6699 if you wish to arrange a viewing appointment for this property or require further information.



1



1



1



D

Floor Plan

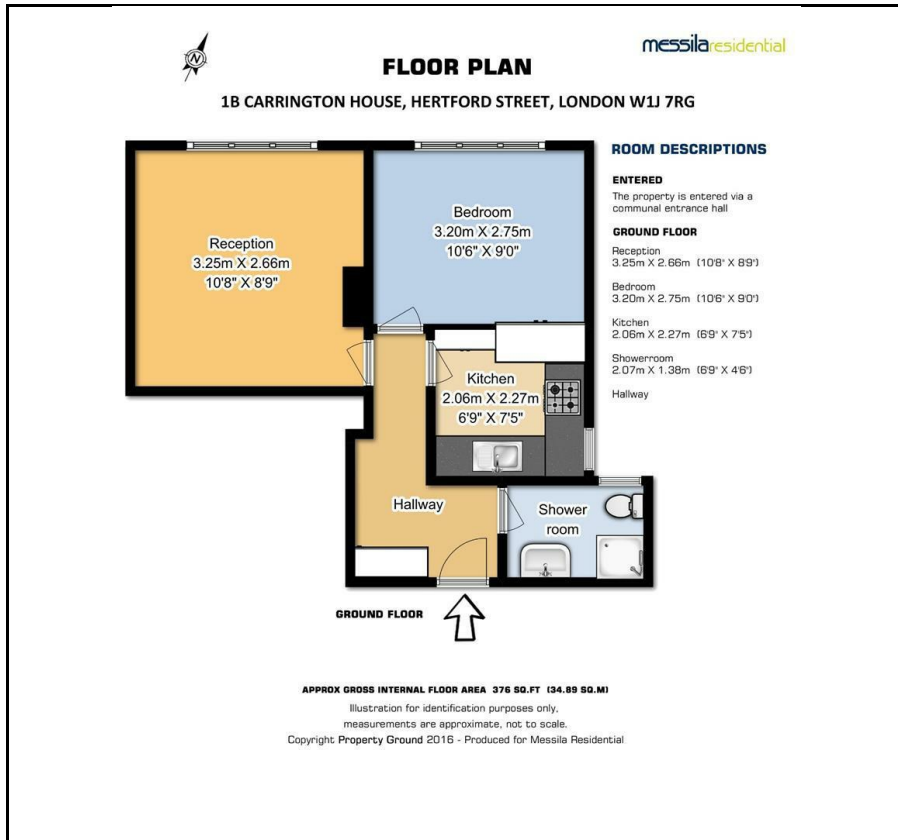

Area Map



Energy Efficiency Graph

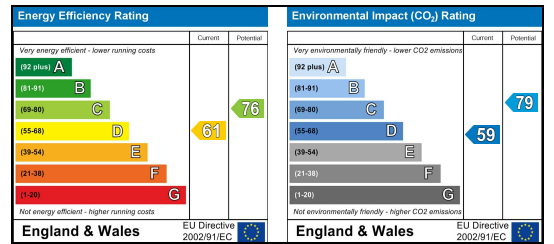

These particulars, whilst believed to be accurate are set out as a general outline only for guidance and do not constitute any part of an offer or contract. Intending purchasers should not rely on them as statements of representation of fact, but must satisfy themselves by inspection or otherwise as to their accuracy. No person in this firm's employment has the authority to make or give any representation or warranty in respect of the property.

Messila Residential

137 Park Road, London, NW8 7HT

T: 020 7586 6699 E: regentspark@messilaresidential.com W: messilaresidential.com