



## Edgware Road, W2

£542 Per week

A new one bed property on the seventh floor of a portered building. The property is well furnished with wooden floors and has a fully fitted kitchen which is separate to the living space.

Based by Marble Arch and with great connections across London, it is also a short walk to Hyde Park and Marylebone High Street.

### Features

- Portered
- Seventh Floor
- Lift
- Heating and Hot Water
- Furnished

# Edgware Road, London, W2

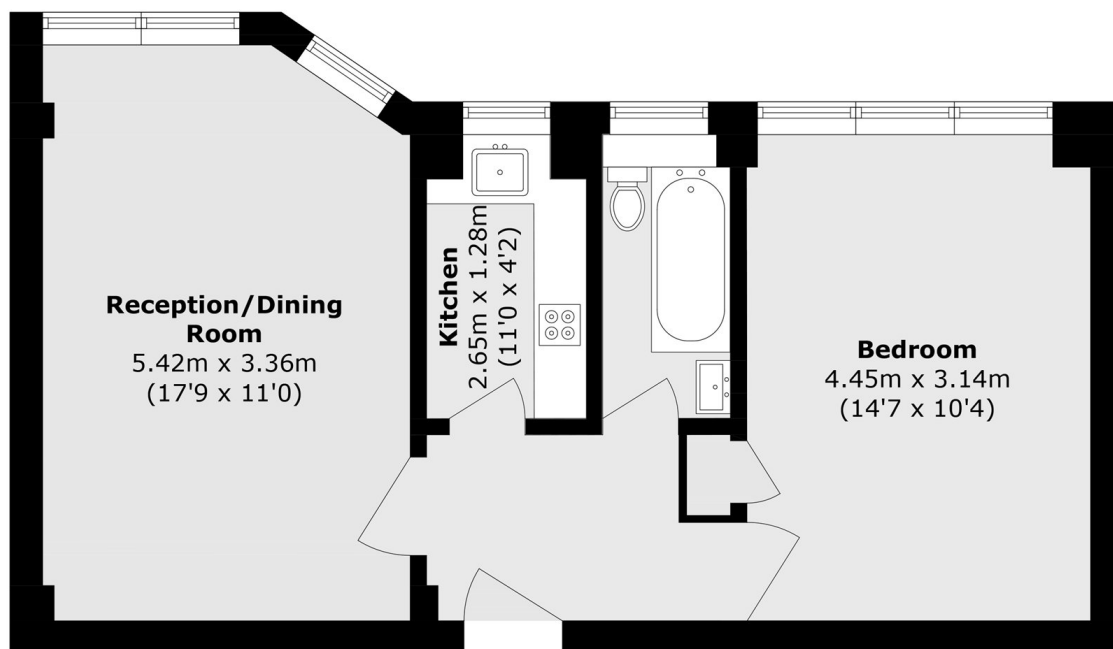

## Seventh Floor

Total area (approx.): 44.8 sq. m (482.2 sq. ft)