



Station Road, Bamber Bridge, Preston

£650 PCM

****COMMERCIAL RENTAL****

Ben Rose Estate Agents are delighted to present this spacious ground-floor commercial property to the rental market. Previously used as a tattoo studio, the space would present an excellent opportunity for a variety of business uses, including beauty or hair salons, office space, retail use, or other service-based businesses.

The property features a spacious main commercial shop floor area, as well as a kitchen and a WC.

Ideally situated in the heart of Bamber Bridge on the popular Station Road, the property is well connected with plenty of on-road parking available nearby.

Early viewing is highly recommended to avoid disappointment.





GROUND FLOOR
544 sq.ft. (50.5 sq.m.) approx.

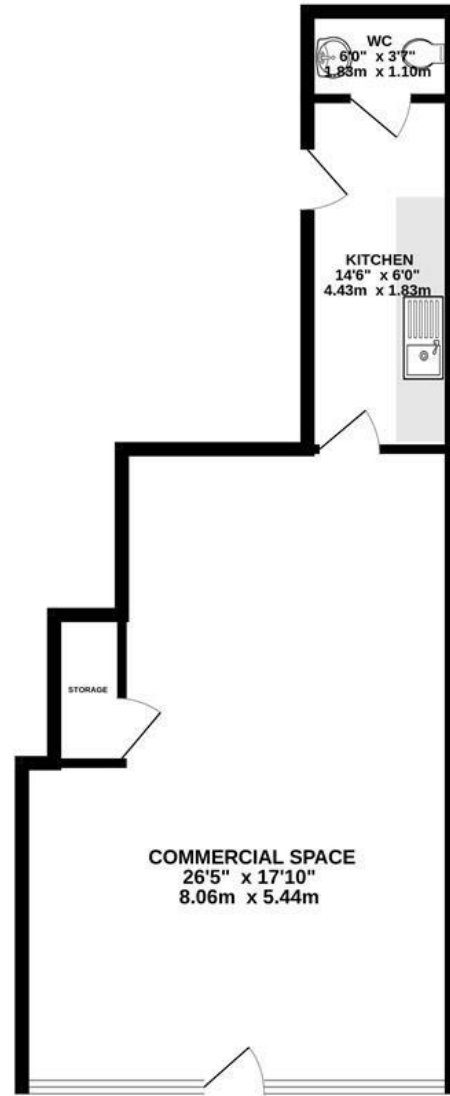

TOTAL FLOOR AREA : 544 sq.ft. (50.5 sq.m.) approx.

Whilst every attempt has been made to ensure the accuracy of the floorplan contained here, measurements of doors, windows, rooms and any other items are approximate and no responsibility is taken for any error, omission or mis-statement. This plan is for illustrative purposes only and should be used as such by any prospective purchaser. The services, systems and appliances shown have not been tested and no guarantee as to their operability or efficiency can be given.
Made with Metropix ©2025

We do our best to ensure that our sales particulars are accurate and are not misleading but this is for general guidance and complete accuracy cannot be guaranteed. We are not qualified to verify tenure of a property and prospective purchasers should seek clarification from their solicitor. All measurements and land sizes are quoted approximately. The mention of any appliances, fixtures and fittings does not imply they are in working order.

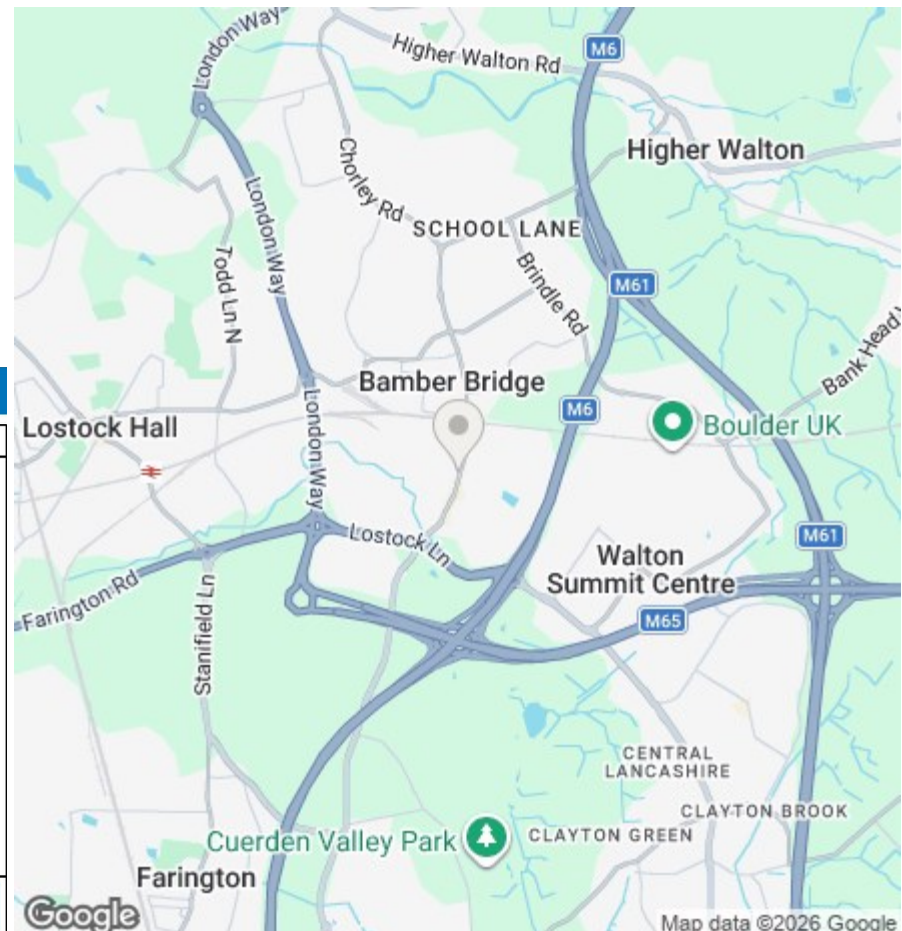

Energy Efficiency Rating

	Current	Potential
<i>Very energy efficient - lower running costs</i>		
(92 plus) A		
(81-91) B		
(69-80) C		
(55-68) D		
(39-54) E		
(21-38) F		
(1-20) G		
<i>Not energy efficient - higher running costs</i>		
England & Wales	EU Directive 2002/91/EC	

Environmental Impact (CO₂) Rating

	Current	Potential
<i>Very environmentally friendly - lower CO2 emissions</i>		
(92 plus) A		
(81-91) B		
(69-80) C		
(55-68) D		
(39-54) E		
(21-38) F		
(1-20) G		
<i>Not environmentally friendly - higher CO2 emissions</i>		
England & Wales	EU Directive 2002/91/EC	