



OVER 60?

Secure this property
for up to **59% less!**

Price

£215,000

Leasehold

2x  1x  1x 

**Minerva Court,
Parkstone Avenue,
Southsea, Hampshire,
PO4**

cubitt&west
Helping you move forwards



Main features

- No forward chain
- Allocated parking
- Secure intercom access
- Fully refurbished and modern decor
- Ideally located near to Canoe Lake and seafront

Accommodation

FIRST FLOOR

Entrance Hallway

Lounge: 20'5 x 9'9 (6.23m x 2.97m)

Kitchen: 9'8 x 7'8 (2.95m x 2.34m)

Bedroom 1: 13'0 x 9'6 (3.97m x 2.90m)

Bedroom 2: 9'7 x 9'5 (2.92m x 2.87m)

Bathroom

OUTSIDE

Allocated Parking Space

First Floor

Approx. 56.9 sq. metres (612.9 sq. feet)

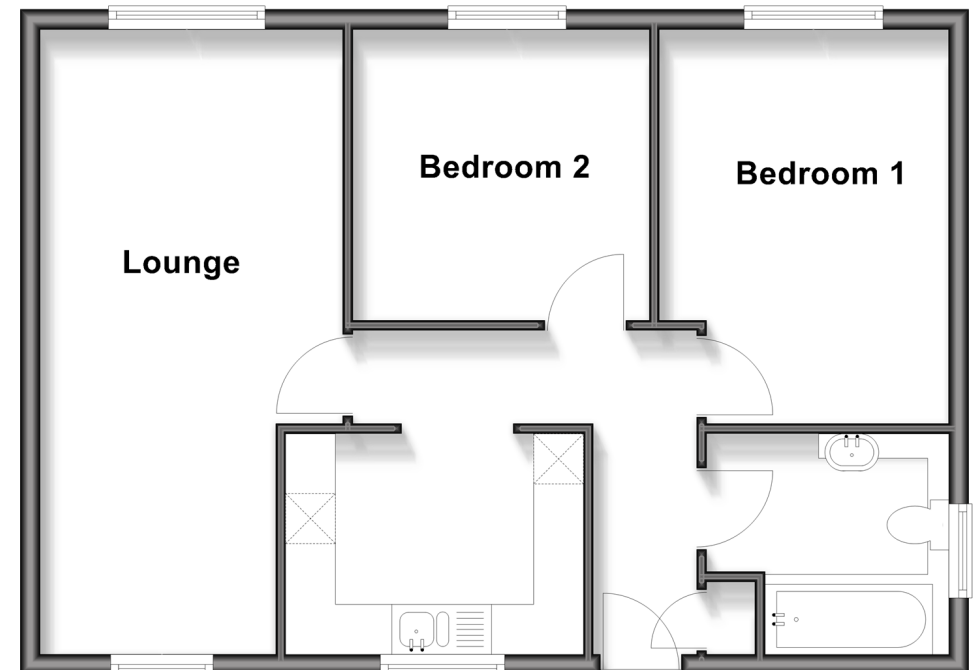

Call Southsea - 023 9229 6396 ■ cubittandwest.co.uk

■ Legal advice should be taken to verify fixtures/fittings, planning, alterations and/or lease details
 ■ Through a Homewise Home For Life Plan people aged 60+ can secure this property for up to 50% less, by purchasing a Lifetime Lease.

■ Appliances & services are untested, dimensions are approximate and floor plans are not to scale