

TO  
LET



## Flat 68, Swan Court Waterhouse Street, Hemel Hempstead

£1,050 pcm

One Bedroom Apartment • Town Centre Location • Open Plan Living Room & Kitchen • Electric Heating & Hot Water • Modern Bathroom Suite

squire | estates

Squire Estates are pleased to present this six floor apartment to rent in the heart of the town centre in Hemel Hempstead. The apartment itself consists of one bedroom, an open plan living/reception room and a bathroom suite. It features electric heating and double glazing. The apartment is accessed via two security doors and benefits from lift access. Internally you get to enjoy sweeping views across the town as well as modern fixtures and fittings.

Council Tax band: B

EPC Energy Efficiency Rating: D

EPC Environmental Impact Rating: C



squire | estates

67 Marlowes, Hemel Hempstead, Hertfordshire HP1 1LE • t. 01442 233533 • [www.squireestates.co.uk](http://www.squireestates.co.uk)

### Floor Plan

Approx. 25.7 sq. metres (277.1 sq. feet)

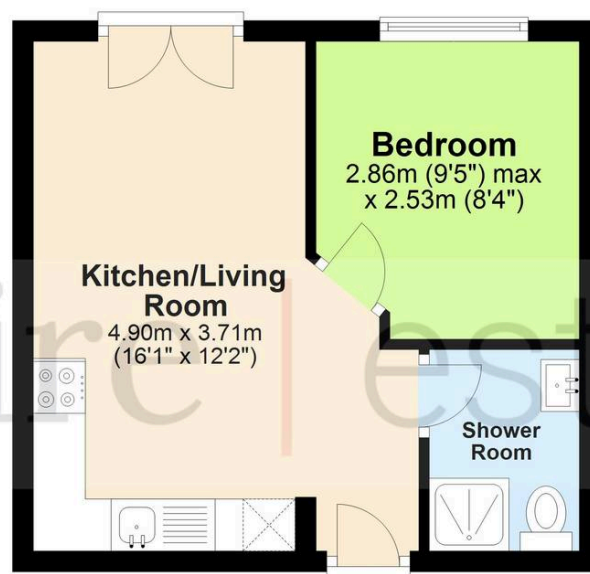

Total area: approx. 25.7 sq. metres (277.1 sq. feet)

The Floor Plan is not to Scale and measurements and areas shown are approximate and therefore should be used for illustrative purposes only. The plan has been prepared with due diligence and whilst we have confidence in the information produced it should not be relied upon. Maximum lengths and widths are represented on the plan. If there are any aspects of particular importance, you should carry out or commission your own inspection of the property. Copyright © SKMSTUDIO  
Plan produced using PlanUp. □