

# Butler's

thoughtful estate agency



Kingsbridge Road  
Morden, SM4 4PZ

Guide price £550,000



3



1



2



# Kingsbridge Road

Morden, SM4 4PZ

GUIDE PRICE £550,000 - £575,000 This wonderful semi-detached house is a fantastic family home, set in a fabulous & friendly location, and has been sympathetically updated throughout the current sellers ownership.

Have you ever dreamed of living in a convenient road, yet on the doorstep of excellent amenities, open spaces, schools and transport links? It's just a short distance into Worcester Park, Cheam & Morden, with you having outstanding schooling in close proximity. Buses and multiple train stations provide quick links into the City, so you'll have a choice of how to get into town quickly. Despite all of this, sitting in your level rear garden, you'd be forgiven for thinking you were in the middle of nowhere - a tranquil space for you to enjoy a good book or even have friends over for a barbeque. Within the home, you'll appreciate the abundance of features, space and charm, ideal for relaxing and entertaining alike, with everything being in a condition you can just move in and start to enjoy immediately.

Inside, the layout of the ground floor currently offers a huge amount of versatility, with a gorgeous living room and a lovely modern kitchen/diner. This part of the house has been opened up to be more generously proportioned than other properties of the same period with a conservatory area, however still gives you the opportunity to go the extension route as some of the neighbors have in the future - subject to the relevant permissions.

Upstairs, there are 2 good-sized double bedrooms, making it a tough choice about which one to make your own, along with a sensible single room, perfect for one of the kids or even to set up a home office in. There is also a possibility for a loft conversion if you have a large family. Finishing off this wonderful house internally is a high quality bathroom serving all the rooms. On the outside there is the bonus of a driveway providing off street parking to the front, with a garage to the rear of the plot.





## GROUND FLOOR

Hallway

Living Room  
12'2 x 9'10 (3.71m x 3.00m)

Dining Room  
10'8 x 9'11 (3.25m x 3.02m)

Conservatory  
13'8 x 8'10 (4.17m x 2.69m)

Kitchen  
10'3 x 6'1 (3.12m x 1.85m)

## FIRST FLOOR

Landing

Bedroom  
12'7 x 10' maximum (3.84m x 3.05m maximum)

Bedroom  
10'5 x 10' maximum (3.18m x 3.05m maximum)

Bedroom  
7'7 x 5'10 (2.31m x 1.78m)

Bathroom  
6'7 x 5'7 (2.01m x 1.70m)

## OUTSIDE

Driveway

Rear Garden

Garage  
18' x 9'8 (5.49m x 2.95m)



## Floor Plan

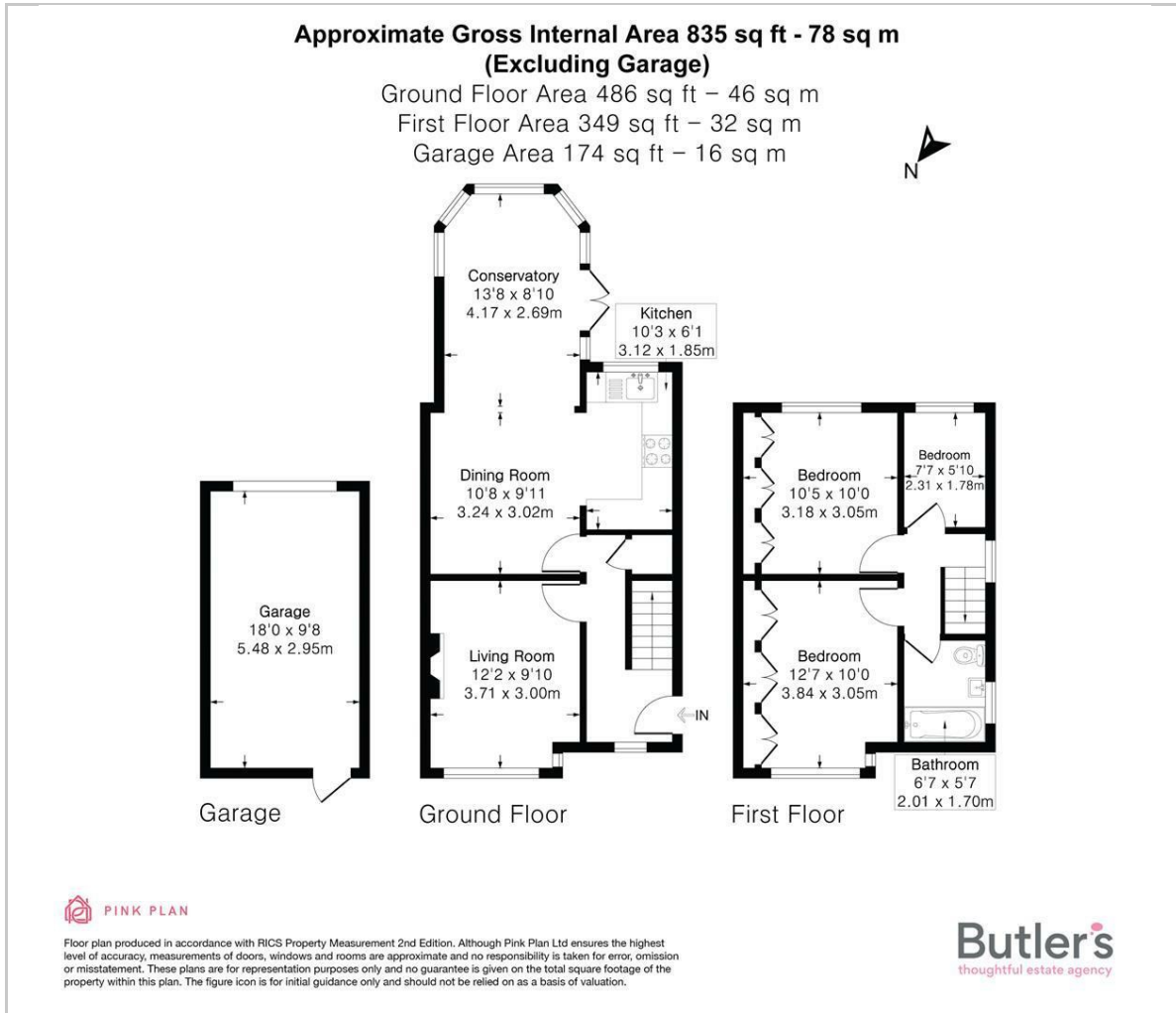

## Viewing

Please contact our Butler's Worcester Park Office on 020 39 069 169 if you wish to arrange a viewing appointment for this property or require further information.

These particulars, whilst believed to be accurate are set out as a general outline only for guidance and do not constitute any part of an offer or contract. Intending purchasers should not rely on them as statements of representation of fact, but must satisfy themselves by inspection or otherwise as to their accuracy. No person in this firm's employment has the authority to make or give any representation or warranty in respect of the property.

64 Central Road, Worcester Park, KT4 8HY  
Tel: 020 39 069 169 Email: worcesterpark@butlershomes.co.uk butlershomes.co.uk

## Area Map

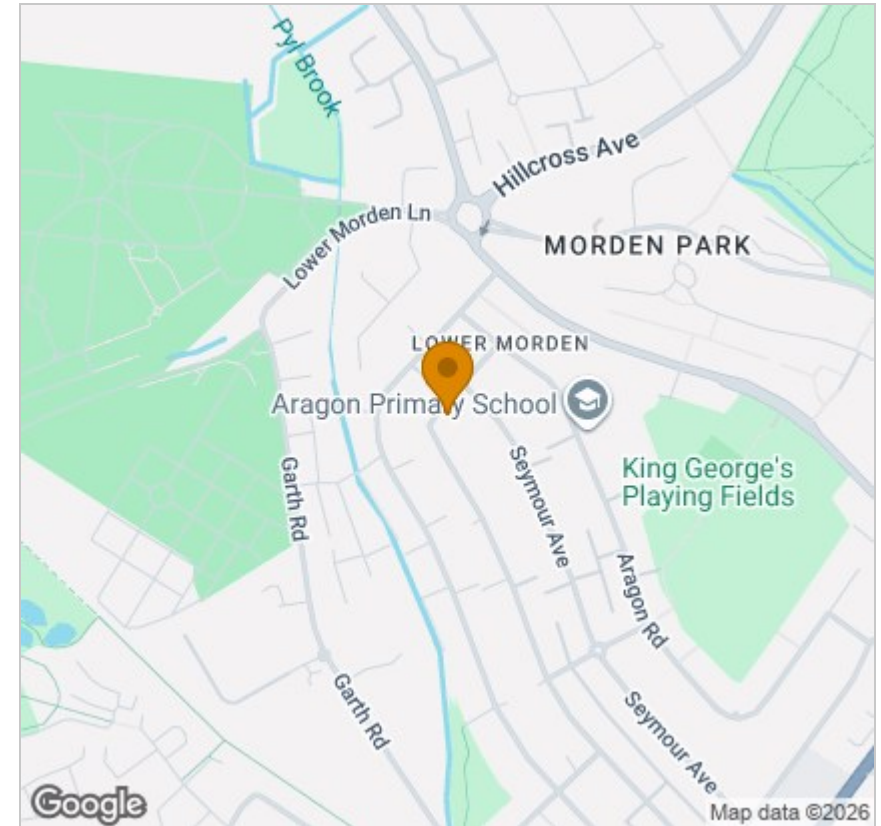

## Energy Efficiency Graph

