



Mulberry House

# MULBERRY HOUSE

LOXLEY, STRATFORD-UPON-AVON, WARWICKSHIRE



# A BEAUTIFUL 5/6 BEDROOM DETACHED VILLAGE HOUSE

built to a high standard and design, with top quality fixtures and décor of about 3,715 square feet in a sought-after South Warwickshire village.



Local Authority: Stratford-on-Avon

Council Tax band: G

Tenure: Freehold



## SITUATION

Mulberry House is set on a private drive near the village centre, enjoying attractive rural views to the rear. Loxley is a sought-after village between Warwick, Leamington Spa and Stratford-upon-Avon, with a pub, church and primary school. Nearby Wellesbourne offers additional amenities, while Stratford-upon-Avon (3 miles) provides excellent shopping, leisure and theatres.

The area offers a strong choice of state, grammar and independent schools, including The Croft Prep, Warwick schools, King's High and Stratford Grammar Schools.

The M40 (J15) is 6 miles away, providing easy access to London, Birmingham and the wider motorway network.

Leisure options include nearby golf courses, racing at Stratford, Warwick and Cheltenham, and easy access to the Cotswolds.









## THE PROPERTY

A very handsome detached modern brick-built house with stone quoins and porch to the front door and modern double-glazed sash windows.

Designed for modern living with large windows, bifold doors and double-height glazing to the hall and stairwell. The kitchen is stunning, fully equipped with appliances and island unit, with a large dining area and family sitting area both with bifold doors to the patio and view beyond, with a large utility/boot room with sink, plumbing and ample storage. The spacious drawing room has a handsome fireplace and cornice. There is a separate study.

The staircase with wrought iron spindles and oak handrail and newel finials leads to a spacious landing and five generous first-floor bedrooms, three with beautifully appointed shower rooms, all with built-in wardrobes, and a family bathroom. To the large second floor room which lends itself to playroom/media room, home office or sixth bedroom. Currently it is used as a gym by the present owners.

The property has solar panels and battery storage with a 22Kw Zappi electric car charger, tiled or hard flooring with underfloor heating. Sound system.







## OUTSIDE

Approached along a tarmac drive leading to Home Farm, the property has double electric wrought iron gates with Connect 4 remote control, which open to a gravel parking area and generous detached double garage.

There is a lawned garden to the side with a summer house and willow tree, and a patio behind the house with a park railing fence giving views over the traditional grassland behind. The patio continues to the west side of the house, where steps lead up to a raised, terraced cobblestone seating area.







### Services

Mains electricity, drainage and water are connected to the properties. Air source heat pump central heating. Broadband and telephone.

### Directions (CV35 9JS)

The property will be found on the right-hand side of the drive to Home Farm.

What3words ///breezy.pool.headsets





First Floor

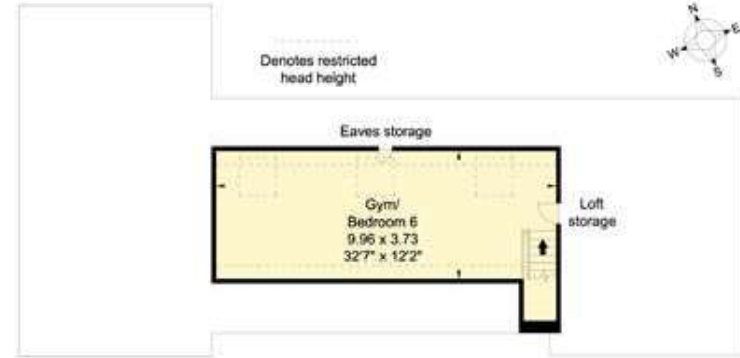

Second Floor



Ground Floor



## Mulberry House Loxley



APPROXIMATE GROSS INTERNAL FLOOR AREA:  
 House: 345 sq m (3,715 sq ft)  
 Garage: 35 sq m (375 sq ft)  
 Total: 380 sq m (4,090 sq ft)  
 inc. restricted head height  
 © Cotswold Plans Ltd ma/16505

This plan is for guidance only and must not be relied upon as a statement of fact. Attention is drawn to the Important Notice on the last page of text of the Particulars.



**James Way**

01789 297735

[james.way@knightfrank.com](mailto:james.way@knightfrank.com)

**Knight Frank Stratford-upon-Avon**

Bridgeway House, Bridgeway

Stratford-upon-Avon, Warwickshire CV37 6YX

**[knightfrank.co.uk](http://knightfrank.co.uk)**

Your partners in property

1. Particulars: These particulars are not an offer or contract, nor part of one. You should not rely on statements given by Knight Frank in the particulars, by word of mouth or in writing ("information") as being factually accurate about the property, its condition or its value. Neither Knight Frank nor any joint agent has any authority to make any representations about the property, and accordingly any information given is entirely without responsibility on the part of Knight Frank. 2. Material Information: Please note that the material information is provided to Knight Frank by third parties and is provided here as a guide only. While Knight Frank has taken steps to verify this information, we advise you to confirm the details of any such material information prior to any offer being submitted. If we are informed of changes to this information by the seller or another third party, we will use reasonable endeavours to update this as soon as practical. 3. Photos, Videos etc: The photographs, property videos and virtual viewings etc. show only certain parts of the property as they appeared at the time they were taken. Areas, measurements and distances given are approximate only. 4. Regulations etc: Any reference to alterations to, or use of, any part of the property does not mean that any necessary planning, building regulations or other consent has been obtained. A buyer must find out by inspection or in other ways that these matters have been properly dealt with and that all information is correct. 5. Fixtures and fittings: A list of the fitted carpets, curtains, light fittings and other items fixed to the property which are included in the sale (or may be available by separate negotiation) will be provided by the Seller's Solicitors. 6. VAT: The VAT position relating to the property may change without notice. 7. To find out how we process Personal Data, please refer to our Group Privacy Statement and other notices at <https://www.knightfrank.com/legals/privacy-statement>.

Particulars dated May 2026. Photographs and videos dated May 2026. All information is correct at the time of going to print. Knight Frank is the trading name of Knight Frank LLP. Knight Frank LLP is a limited liability partnership registered in England and Wales with registered number OC305934. Our registered office is at 55 Baker Street, London W1U 8AN. We use the term 'partner' to refer to a member of Knight Frank LLP, or an employee or consultant. A list of members names of Knight Frank LLP may be inspected at our registered office. If you do not want us to contact you further about our services then please contact us by either calling 020 3544 0692, email to [marketing.help@knightfrank.com](mailto:marketing.help@knightfrank.com) or post to our UK Residential Marketing Manager at our registered office (above) providing your name and address.





Date: 12 May 2026  
Our reference: STR012603963

## Mulberry House, Loxley, Warwick, CV35 9JS

We have pleasure in enclosing details of the above property for which we are quoting a guide price of £1,895,000.

Please let us know if you need any further information about the property or surrounding area and we will be delighted to provide it.

Full details of all our properties and a wide range of services can be viewed online at [knightfrank.co.uk](https://knightfrank.co.uk). You can also receive early information on new properties coming on to the market by signing up to [My Knight Frank](#).

For additional information or to make arrangements to view the property, please get in touch.

**We'd love to help you.**

Yours faithfully

A stylized, handwritten signature in black ink that reads "Knight Frank".

**KNIGHT FRANK LLP**

Enc:

**James Way**  
Partner, Head of Midlands Sales  
+44 1789206950  
[james.way@knightfrank.com](mailto:james.way@knightfrank.com)

**Knight Frank, Stratford**  
Bridgeway House, Bridgeway, Stratford upon Avon, CV37 6YX  
+44 1789 297 735

[knightfrank.co.uk](https://knightfrank.co.uk)

Knight Frank LLP is a limited liability partnership registered in England and Wales with registered number OC305934. Our registered office is at 55 Baker Street, London W1U 8AN. We use the term 'partner' to refer to a member of Knight Frank LLP, or an employee or consultant. A list of members' names of Knight Frank LLP may be inspected at our registered office.

Regulated by RICS

Your partners in property

V4.3 Sep 24