

## 96 Barrington Close, Witney OX28 5FL

A 2 bedroom semi detached house with a garage and parking, situated on a corner position on the popular Deer Park development. The property has accommodation to include an entrance hall, modern kitchen with integrated appliances, a living room with a spiral staircase overlooking the rear garden, 2 double bedrooms and a bathroom, together with double glazed windows and gas central heating. In addition there is the added benefit of a garage and parking. Available for sale with no onward chain.

**THOMAS  
MERRIFIELD**

SALES LETTINGS

e. [witney@thomasmerrifield.co.uk](mailto:witney@thomasmerrifield.co.uk)

t. 01993 772000

**Price £300,000**

[www.thomasmerrifield.co.uk](http://www.thomasmerrifield.co.uk)





## 96 Barrington Close, Witney, Oxfordshire OX28 5FL

- Entrance Hall
- Kitchen
- Living/Dining Room
- 2 Double Bedrooms
- Bathroom
- Double Glazing
- Gas Central Heating
- Garage
- Parking
- No Onward Chain

Material Information - via Ofcom.

All mains are connected. Ultrafast broadband is available. Mobile & Data Signals - outdoor: good for EE, O2, Three & Vodafone.  
15A26

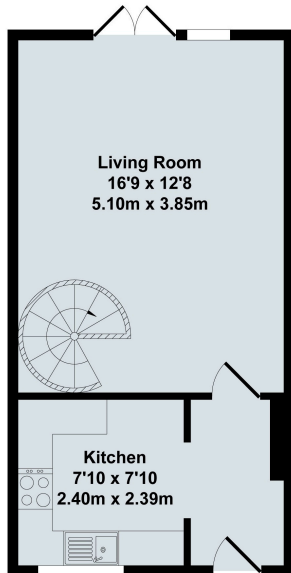

Ground Floor

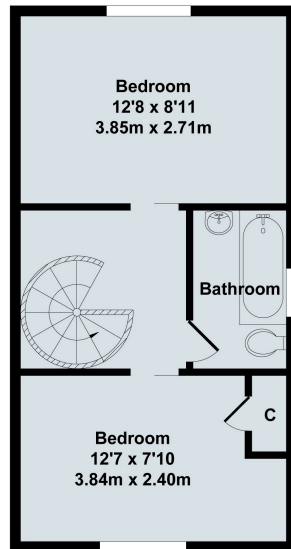

First Floor

**96 Barrington Close, Witney**  
Total Approx. Floor Area 619 Sq.Ft. (57.50 Sq.M.)  
All items illustrated on this plan are included in the "Total Approx Floor Area"



### Local Authority:

WODC Tax Band C / EPC Rating: 68/D

### Contact:

52 Market Square, Witney,  
Oxfordshire, OX28 6AF

### Tenure:

Freehold

Tel: 01993 772000

Email: [witney@thomasmerrifield.co.uk](mailto:witney@thomasmerrifield.co.uk)

### Important Notice

Thomas Merrifield for themselves and their clients give notice that:-

1. They are not authorised to make or give representation or warranty in relation to this property, either on their own behalf or on behalf of the Seller. They assume no responsibility for any statement made in these particulars. These particulars do not form part of any offer or contract and must not be relied upon as statements or representations of fact.
2. Whilst every attempt has been made to ensure the accuracy of the floorplan contained here, measurements of doors, windows, rooms and any other items are approximate and no responsibility is taken for any error, omission, or mis- statement.
3. All areas, measurements or distances are approximate. The particulars are intended for guidance only and are not necessarily comprehensive. A wide angle lens may have been used in photography. Thomas Merrifield have not tested appliances or services and it should not be assumed that the property has all necessary planning, building regulation and other consents. Buyers must satisfy themselves with the property by inspection or otherwise.
4. Reference to any mechanical or electrical equipment does not constitute a representation that such equipment is capable of fulfilling its function and prospective Buyers must make their own enquiries.
5. They have no responsibility for any expenses or costs incurred by prospective Buyers in inspecting properties which have been sold, let or withdrawn. Applicants are advised to contact the Agent to check availability and any other information of particular importance to them, prior to inspecting the property, particularly if travelling some distance.